



Tovey Crescent, , Leicester, LE2 9DF

- BEAUTIFULLY PRESENTED
- SPACIOUS LIVING ROOM
- MODERN THREE PIECE BATHROOM SUITE
- DRIVEWAY FOR OFF ROAD PARKING
- LOCAL SHOPS, SCHOOLS AND AMENITIES
- THREE BEDROOM SEMI-DETACHED HOME
- MODERN OPEN PLAN KITCHEN-DINER
- ENCLOSED GARDEN WITH LAWN AND PATIO
- GAS CENTRAL HEATING AND DOUBLE GLAZING
- GOOD ROAD LINKS TO THE CITY AND MOTORWAYS

Asking Price £235,000



Tovey Crescent, , Leicester, LE2 9DF

DESCRIPTION

Presented in immaculate condition is this stunning example of a three bedroom semi-detached home that offers a modern and contemporary interior.

This fabulous home has a real cosy feel inside and offers plenty of living space to relax or enjoy as a family. Internally, the property comprises of an entrance hallway with stairs to the first floor and door opening into the very generous living room with bay fronted window and inset feature fireplace. A door leads into the open plan kitchen diner, which has a range of modern fitted units with wooden worksurfaces an integrated oven and hob with extractor hood over and double glazed French doors to the garden.

Ascending to the first floor landing, there are three well presented bedrooms all benefiting from fitted wardrobes and double glazed windows, and the modern three piece bathroom suite which incorporates a P-shaped bath with curved glass splash screen and shower over, a wash hand basin and low level wc.

Outside, the rear garden is enclosed with fence panelling, a lawn with edged plant and patio paving borders, and a raised decking seating area with access to the garden shed. Gated access leads through to the front block paved driveway, which provides the off road parking spaces for this beautifully presented home.

The property benefits from gas central heating and double glazing and to find out more, contact your local Hunters estate agents Wigston to arrange your viewing.





Approx Gross Internal Area
83 sq m / 890 sq ft

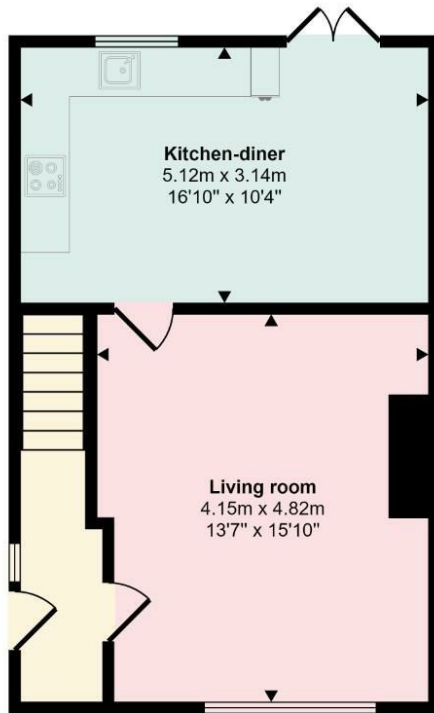

Ground Floor
Approx 41 sq m / 442 sq ft

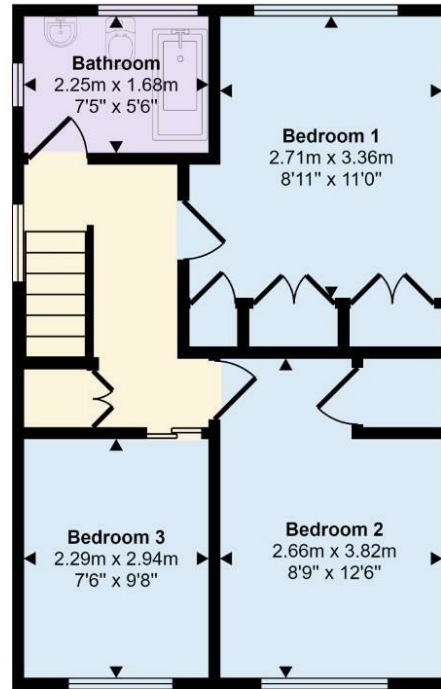

First Floor
Approx 42 sq m / 448 sq ft

This floorplan is only for illustrative purposes and is not to scale. Measurements of rooms, doors, windows, and any items are approximate and no responsibility is taken for any error, omission or mis-statement. Icons of items such as bathroom suites are representations only and may not look like the real items. Made with Made Snappy 360.

Viewings

Please contact wigston@hunters.com, if you wish to arrange a viewing appointment for this property or require further information.

Valuations

For a valuation of your property, please email the team with your property details, contact information and the times you are available.

ENERGY PERFORMANCE CERTIFICATE

The energy efficiency rating is a measure of the overall efficacy of a home. The higher the rating the more energy efficient the home is and the lower the fuel bills will be.

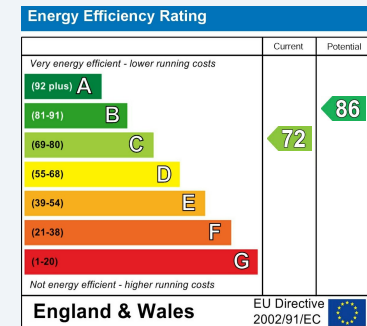

These particulars are intended to give a fair and reliable description of the property but no responsibility for any inaccuracy or error can be accepted and do not constitute an offer or contract. We have not tested any services or appliances (including central heating if fitted) referred to in these particulars and the purchasers are advised to satisfy themselves as to the working order and condition. If a property is unoccupied at any time there may be reconnection charges for any switched off/disconnected or drained services or appliances - All measurements are approximate.

THINKING OF SELLING? If you are thinking of selling your home or just curious to discover the value of your property, Hunters would be pleased to provide free, no obligation sales and marketing advice. Even if your home is outside the area covered by our local offices we can arrange a Market Appraisal through our national network of Hunters estate agents.