



Royal Crescent Mews  
Notting Hill, W11

CHESTERTONS





Welcome to this charming and luxurious 3-bedroom mews house, nestled at the bottom of Royal Crescent Mews. This delightful property offers a blend of contemporary living and classic elegance.

The highlight of this house is the top floor, where you'll find a stunning open plan kitchen, modern design, state-of-the-art appliances, and an abundance of natural light streaming in through large windows. This space is also an inviting hub for gatherings with family and friends.

The house boasts two bedrooms on the ground floor, designed to provide both comfort and style plus a family bathroom. The master bathroom downstairs is great for relaxation, featuring exquisite fixtures, a luxurious and spacious en-suite bathroom and access to a private patio

- Three bedrooms
- Two bathrooms
- 1358 Square Feet
- Patio area

**£11,500 pcm**

Additional tenant charges apply (fees apply to non-AST tenancies only)

Tenancy Agreement Fee: £300

References per Tenant/Guarantor: £60

Inventory check (approx. £100 – £250 inc. VAT)

[chestertons.co.uk/property-to-rent/applicable-fees](http://chestertons.co.uk/property-to-rent/applicable-fees)

Energy Efficiency Rating		Current	Potential
95-100	A		
81-94	B		88
69-80	C		
55-68	D	67	
39-54	E		
21-38	F		
1-20	G		

Not energy efficient - higher running costs

England, Scotland & Wales EU Directive 2002/91/EC

**Minimum Term:** 1 Month  
**Deposit Required:** 2-3 week's rent  
**Local Authority:** Royal Borough of Kensington & Chelsea  
**Council Tax Band:** G  
**EPC Rating:** D  
**Furnished**

*Chestertons Notting Hill Lettings*

30 Ledbury Road  
 Notting Hill  
 London  
 W11 2AB

nottinghill@chestertons.co.uk  
 02030408588



# Royal Crescent Mews , W11

Approximate Gross Internal Area = 1251 sq ft / 116.2 sq m  
(Excluding Void)



**First Floor**



**Ground Floor**

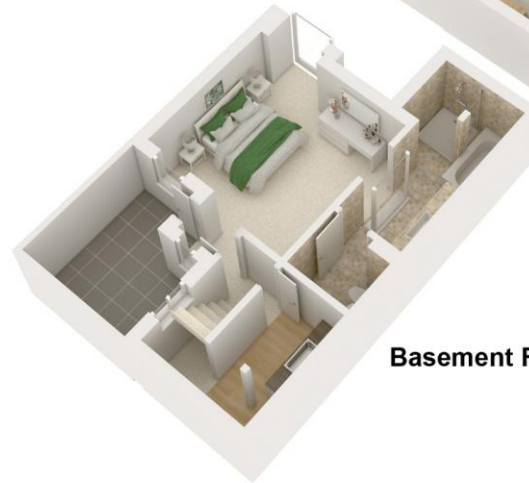

**Basement Floor**



This plan is for layout guidance only. Not drawn to scale unless stated. Windows and door openings are approximate. Whilst every care is taken in the preparation of this plan, please check all dimensions, shapes and compass bearings before making any decisions reliant upon them. (ID994355)

