



Colville Terrace
Notting Hill, W11





A stylish one-bedroom flat with south-facing terrace in one of Notting Hills quintessential pastel stucco fronted period buildings.

This bright and airy, beautifully finished flat has many period features with a contemporary finish in both the kitchen and shower room.

Colville Terrace is a beautiful, colourful street tucked behind Westbourne Grove in the heart of Notting Hill. It is well located for the many famous boutiques and restaurants of Westbourne Grove, Ledbury Road and Portobello Road (The Ledbury with three Michelin stars and recently awarded Dorian with * Michelin Star).

- South-facing terrace
- Recently refurbished
- Pastel stucco fronted period building
- Prime Notting Hill location
- Share of Freehold

Offers in excess of
£800,000

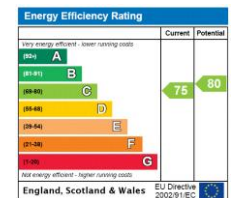

Tenure: Leasehold, 954 years remaining with a Share of Freehold.

Service Charge: £3,500 p.a.

Ground Rent: £0

Local Authority: Kensington and Chelsea

Council Tax Band: G

Chestertons Notting Hill Sales

30 Ledbury Road

Notting Hill

London

W11 2AB

nottinghill@chestertons.co.uk

0203 040 8585

chestertons.co.uk

Colville Terrace, Notting Hill, W11

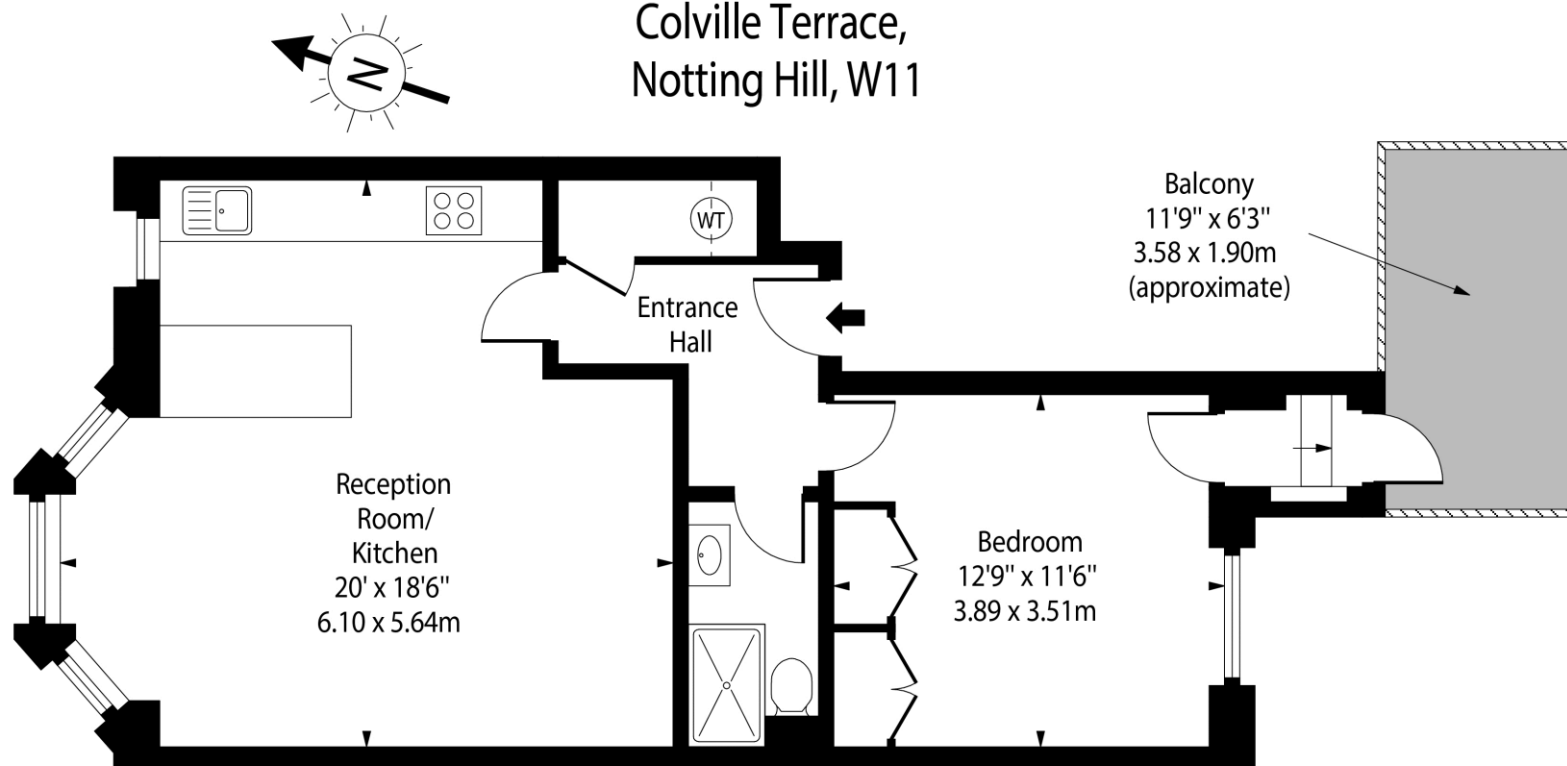

Second Floor

Approx Gross Internal Area 601 Sq Ft - 55.83 Sq M

For Illustration Purposes Only - Not To Scale

Chesterton UK Services Limited trading as Chestertons for themselves and for the vendor of this property whose agents they are, give notice that (i) these particulars do not constitute any part of an offer or contract, (ii) all statements contained within these particulars are made without responsibility on the part of Chestertons or the vendor, (iii) whilst made in good faith, none of the statements contained within these particulars are to be relied upon as a statement or representation of fact, (iv) any intending purchasers must satisfy themselves by inspection or otherwise as to the correctness of each of the statements contained within these particulars, (v) the vendor does not make or give either Chestertons or any person in their employment any authority to make or give representation or warranty whatsoever in relation to this property. Wide angle lenses may be used. ©Copyright Chestertons | Chesterton UK Services Limited | Registered Office 40 Connaught Street, Hyde Park, London W2 2AB Registered Company Number 05334580.

