



Colville Terrace  
Notting Hill, W11

CHESTERTONS





Situated on Colville Terrace, one of Notting Hill's finest and most colourful addresses, is this stunning two-bedroom apartment benefitting from a painstaking refurbishment and beautiful 3.2m high ceilings.

With neutral tones and period features throughout, this 737sqft lateral flat oozes class, whilst being only a stone's throw away from the iconic Portobello Road market and the vast array of boutiques and eateries on Westbourne Grove.

Practicality was also at the forefront of the design, with two double bedrooms, a guest bathroom plus en-suite, multiple storage spaces throughout and an incredibly spacious open plan kitchen/reception with top of the range Miele appliances.

Nearby stations include Notting Hill Gate (Central, Circle and District) and Ladbroke Grove (Circle, Hammersmith and City), with many nearby bus routes also available.

- Newly refurbished
- 3.2m ceilings in reception
- Located in the heart of Notting Hill
- Two double bedrooms
- Period features throughout

Asking Price £1,350,000

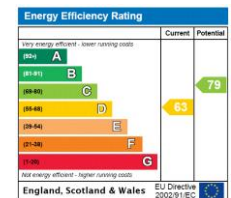

**Tenure:** Leasehold. 971 years with a Share of Freehold.  
**Service Charge:** £3,000 p.a.  
**Ground Rent:** Peppercorn  
**Local Authority:** RBKC  
**Council Tax Band:** F

*Chestertons Notting Hill Sales*

30 Ledbury Road  
 Notting Hill  
 London  
 W11 2AB

[nottinghill@chestertons.co.uk](mailto:nottinghill@chestertons.co.uk)

0203 040 8585

[chestertons.co.uk](http://chestertons.co.uk)

# Colville Terrace, W11

Approximate Gross Internal Area = 738 sq ft / 68.6 sq m

Restricted Height = 23 sq ft / 2.1 sq m

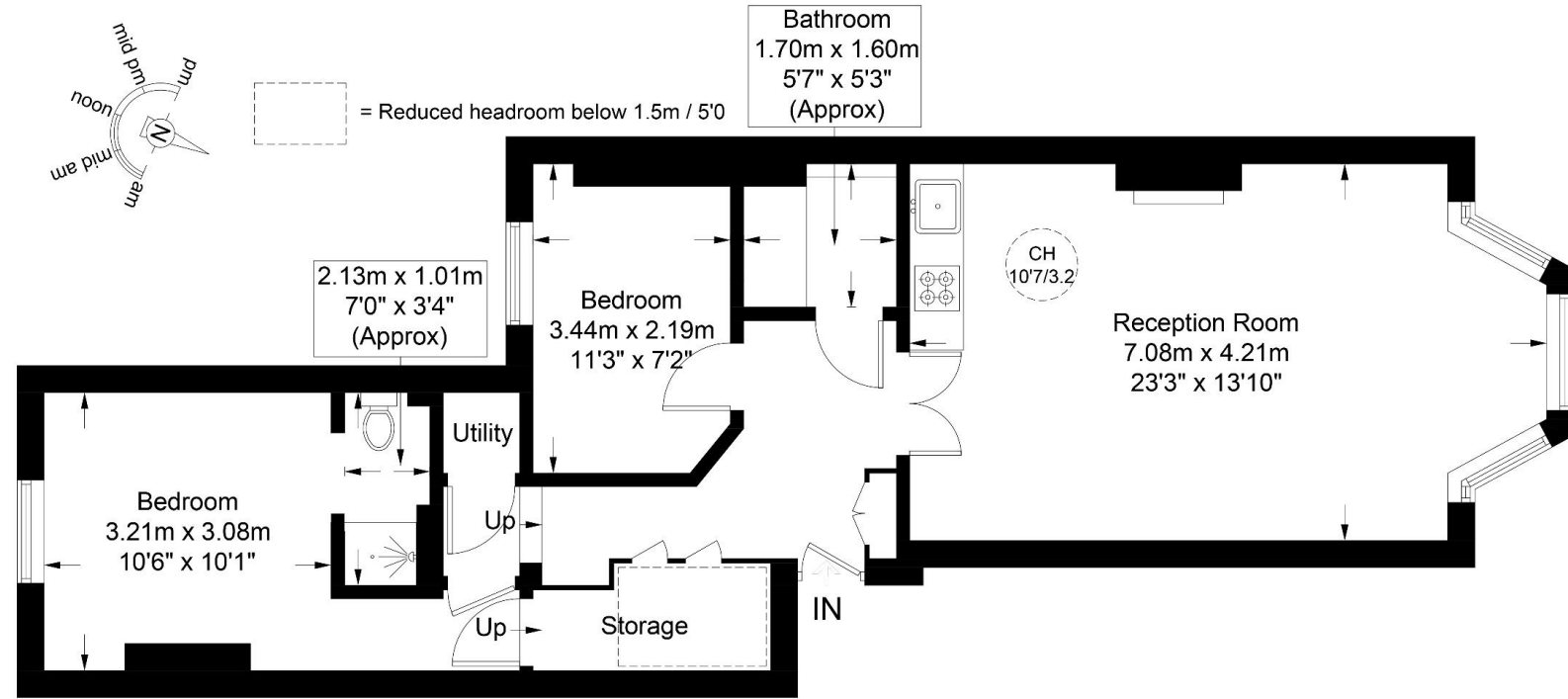

## Upper Ground Floor

This plan is for layout guidance only and is not drawn to scale unless stated. All dimensions, including windows, doors, and the Total Gross Internal Area (GIA), are approximate. For precise measurements, please consult a qualified architect or surveyor before making any decisions based on this plan.



Chesterton Global Ltd trading as Chestertons for themselves and for the vendor of this property whose agents they are, give notice that (i) these particulars do not constitute any part of an offer or contract, (ii) all statements contained within these particulars are made without responsibility on the part of Chestertons or the vendor, (iii) whilst made in good faith, none of the statements contained within these particulars are to be relied upon as a statement or representation of fact, (iv) any intending purchasers must satisfy themselves by inspection or otherwise as to the correctness of each of the statements contained within these particulars, (v) the vendor does not make or give either Chestertons or any person in their employment any authority to make or give representation or warranty whatsoever in relation to this property. Wide angle lenses may be used. ©Copyright Chestertons | Chesterton Global Ltd | Registered Office 40 Connaught Street, Hyde Park, London W2 2AB Registered Company Number 05334580.



This paper is 100% recyclable