



## Pienna Apartments, Elvin Gardens, Wembley, HA9

Price **£400 per week** | Furnished



# Pienna Apartments, Elvin Gardens, Wembley, HA9



1 Bedroom



1 Bathroom



1 Reception



Balcony



Gymnasium



Local Amenities



24-Hour Concierge



0.3 MI Wembley Park

A one bedroom apartment with a balcony set within this fantastic development in Wembley Park. This recent residential development is part of an 85 acre regeneration scheme that is taking place within the area. The living space is finished with designer furnishings, engineered wood flooring and modern ironmongery to the doors. The kitchen has been designed with under-cabinet lighting, Siemens integrated appliances and large format tiles. The bathroom has a modern and functional feel with thermostatic wall-mounted bath controls.

There are also numerous on-site amenities and

services available to residents which include 24/7 Wembley Park Security, electric car charging points, secure bicycle storage and a well-equipped residents' gymnasium. The inclusion of a spacious private balcony will offer the ideal space for a peaceful retreat, while taking in the idyllic views that overlook the courtyard water gardens below. Residents will appreciate being within walking distance of several amenities along Wembley Park Drive that include several independent bars, restaurants, cafés and Wembley Park's London Designer Outlet provides an outstanding selection of leisure facilities and numerous shopping outlets.



**Local Authority:**

Brent London

**Council Tax Band:**

C

**EPC:**

B

**Security deposit:**

equivalent to 5 weeks' rent



# Floorplan

534 sq ft | 49.6 sq m

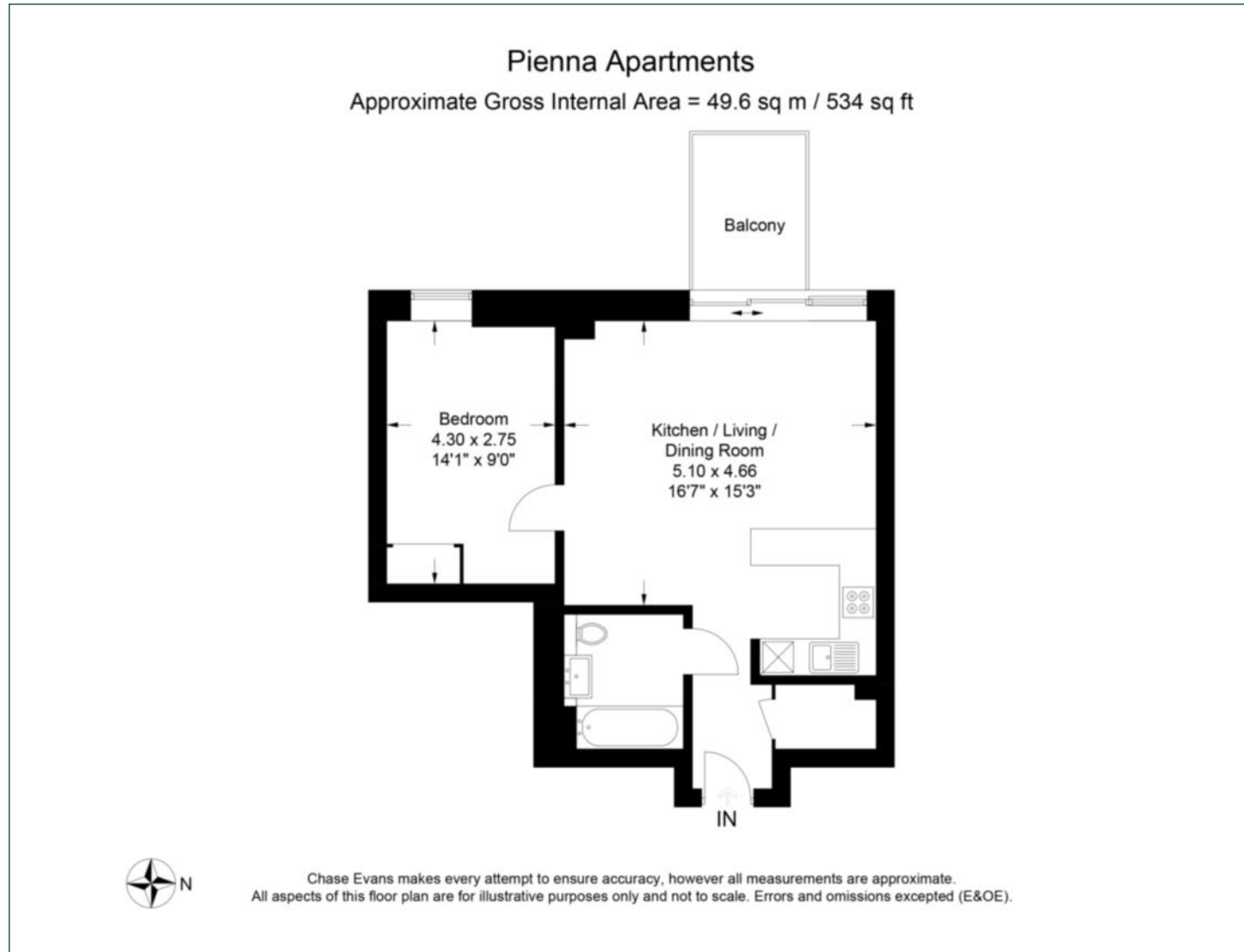

## City & Aldgate

122 Whitechapel High Street, London, E1 7PT

## Lettings

020 7247 3888 | [city.lettings@chaseevans.com](mailto:city.lettings@chaseevans.com)

## We're here to help.

IMPORTANT NOTICE - These particulars have been prepared in good faith and they are not intended to constitute part of an offer or contract. We have not performed a structural survey on this property and the services, appliances and specific fittings have not been tested. All photographs, measurements, floor plans and distances referred to are given as a guide and should not be relied upon.

[chaseevans.com](http://chaseevans.com)