



## Reverence House, Colindale Gardens, Lismore Boulevard, NW9

Price **£380 per week** | Furnished



# Reverence House, Colindale Gardens, Lismore Boulevard, NW9



1 Bedroom



1 Bathroom



1 Reception



Balcony



Gymnasium



Local Amenities



Concierge Service



0.5 MI Colindale

A spacious one bedroom apartment set within Reverence House; within the impressive Colindale Gardens development. This bright property includes an open plan living and dining area, fitted kitchen with integrated appliances, wood flooring, fitted bedroom storage, modern bathroom suite and a private balcony.

Residents have access to a gymnasium and concierge service. Colindale Gardens features approx. 9 acres of green space with walkways, cycle paths, play areas, large open grass areas and tranquil corners featuring attractive planting and

trees. Colindale Underground Station is serviced by Northern Line and is located nearby. The West End and the City are under half an hour train ride away.



**Local Authority:**

Barnet London

**Council Tax Band:**

C

**EPC:**

B

**Security deposit:**

equivalent to 5 weeks' rent



# Floorplan

601 sq ft | 55.9 sq m

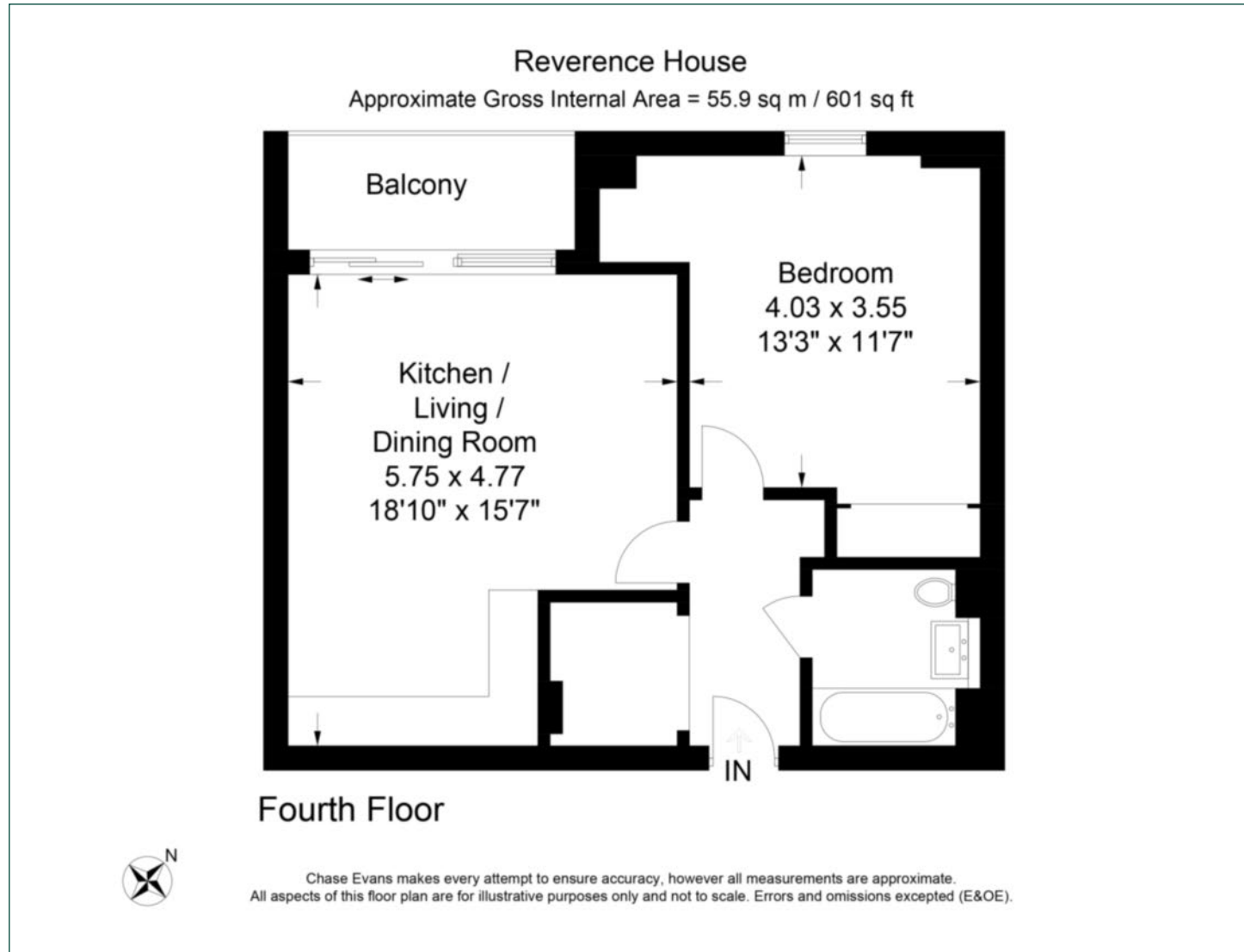

## City & Aldgate

122 Whitechapel High Street, London, E1 7PT

## Lettings

020 7488 2777 | [city.lettings@chaseevans.com](mailto:city.lettings@chaseevans.com)

## We're here to help.

IMPORTANT NOTICE - These particulars have been prepared in good faith and they are not intended to constitute part of an offer or contract. We have not performed a structural survey on this property and the services, appliances and specific fittings have not been tested. All photographs, measurements, floor plans and distances referred to are given as a guide and should not be relied upon.

[chaseevans.com](http://chaseevans.com)