



Cashmere House, Goodman's Fields, Leman Street, E1

Price **£650 per week** | Furnished



Cashmere House, Goodman's Fields, Leman Street, E1



1 Bedroom



1 Bathroom



1 Reception



Winter Garden



Gymnasium



Local Amenities



24-Hour Concierge



0.2 MI Aldgate East

A fantastic luxury one bedroom apartment with a winter garden in the heart of the City and ideally located for Canary Wharf, The Docklands and The South Bank. The apartment boasts ample living space and benefits from access to a private balcony, fully integrated kitchen, built in wardrobes, designer furnishings and high quality finish throughout.

Goodman's Fields offers residents' swimming pool, gym and spa, two acres of landscaped gardens and 24-hour concierge services. Goodman's Fields is located on the doorstep of the City of London and

within close proximity to the River Thames. Shoreditch and Spitalfields are also nearby which offer excellent shopping, dining and nightlife. Aldgate is within walking distance of London's Business District making commutes to work a joy and is only moments from the more traditionally vibrant social hubs of Shoreditch and Brick Lane.

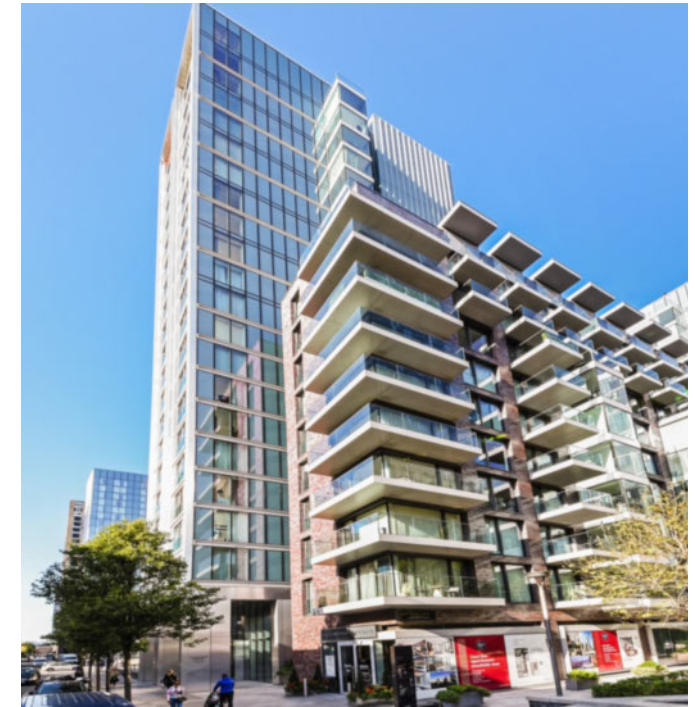

Local Authority:

Tower Hamlets

Council Tax Band:

E

EPC:

B

Security deposit:

equivalent to 5 weeks' rent

Floorplan

539 sq ft | 50 sq m

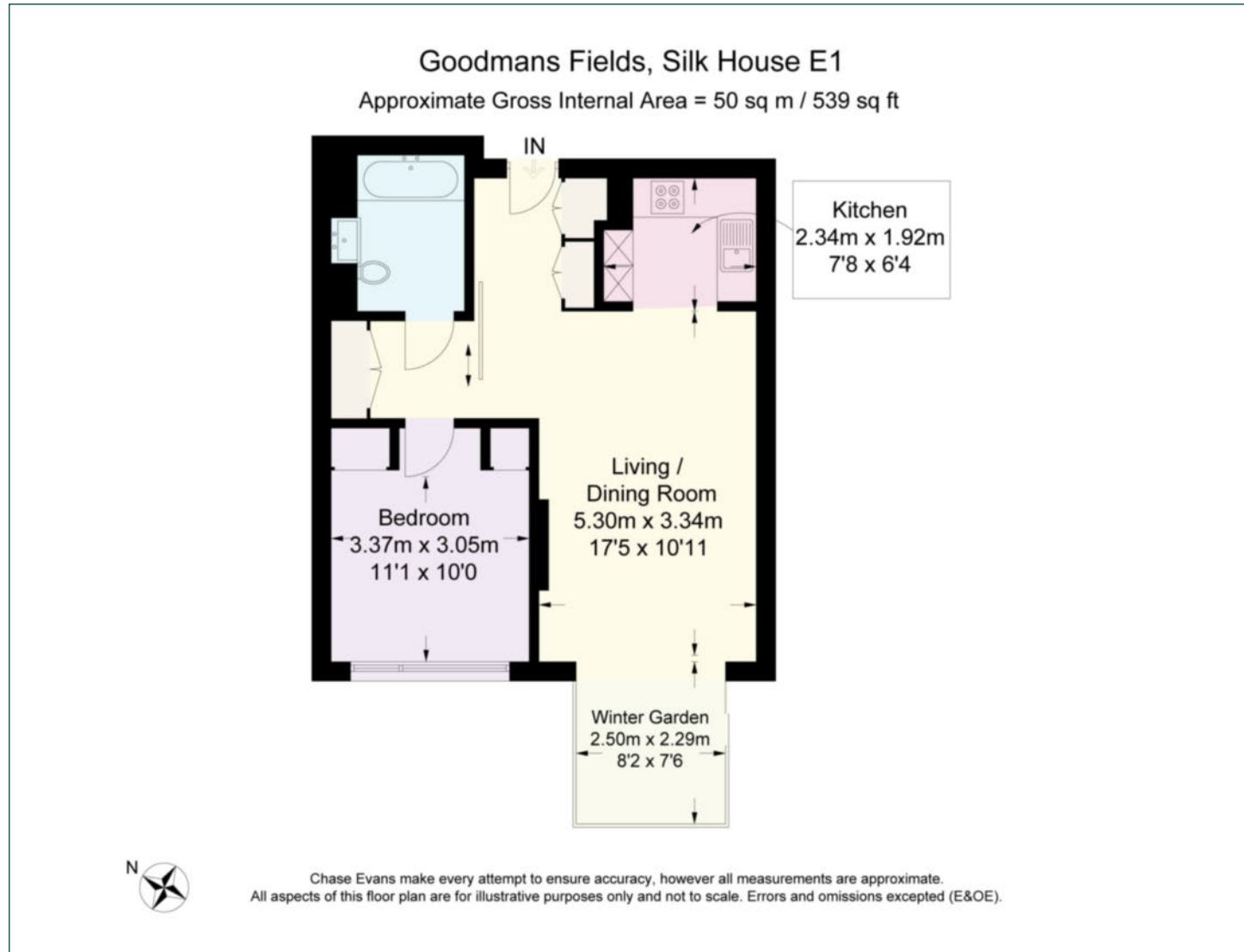

City & Aldgate

122 Whitechapel High Street, London, E1 7PT

Lettings

020 7247 3888 | city.lettings@chaseevans.com

We're here to help.

IMPORTANT NOTICE - These particulars have been prepared in good faith and they are not intended to constitute part of an offer or contract. We have not performed a structural survey on this property and the services, appliances and specific fittings have not been tested. All photographs, measurements, floor plans and distances referred to are given as a guide and should not be relied upon.

chaseevans.com