



## Peacon House, Colindale Gardens, Colindale NW9

Price **£400 per week** | Furnished



# Peacon House, Colindale Gardens, Colindale NW9



1 Bedroom



1 Bathroom



1 Reception



Balcony



Resident's Gym



Concierge



0.4 MI Colindale

A modern one bedroom, one bathroom apartment set within Peacon House, Colindale Gardens NW9. This large property comprises a bright open-plan living area, wood flooring, floor-to-ceiling windows that lead to a generous private balcony and a sleek fitted & integrated kitchen. The large double bedroom comes from fitted wardrobe, bright bathroom with smart fittings and fixtures.

Residents also have access to a gymnasium and a concierge service. Situated within one of the largest regeneration zones in North London, Colindale, which boasts transport links that can see

commutes to Euston achieved in 20min and Bank in 30mins via northern line services from Colindale Underground Station just over half a mile away.

Local amenities include convenience shopping or superstores, at Brent Cross just 4mins tube ride away or even the West End within 30mins. Additionally, public green spaces like Brent Reservoir, home to a nature reserve, are just a short drive (or 40min walk) away.



**Local Authority:**

Brent

**Council Tax Band:**

C

**EPC:**

B

**Security deposit:**

equivalent to 5 weeks' rent

# Floorplan

549 sq ft | 51 sq m

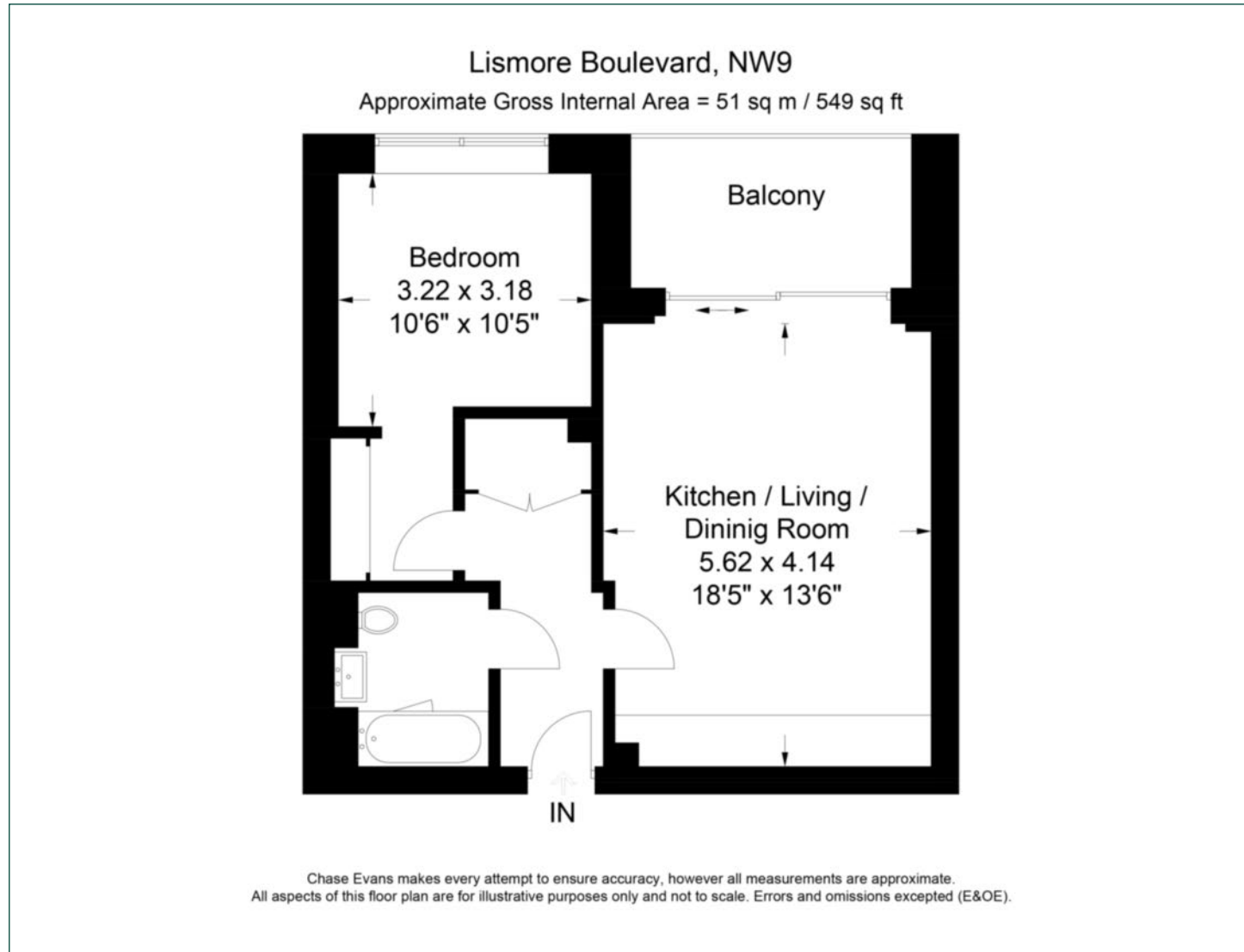

## City & Aldgate

122 Whitechapel High Street, London, E1 7PT

## Lettings

020 7247 3888 | [city.lettings@chaseevans.com](mailto:city.lettings@chaseevans.com)

## We're here to help.

IMPORTANT NOTICE - These particulars have been prepared in good faith and they are not intended to constitute part of an offer or contract. We have not performed a structural survey on this property and the services, appliances and specific fittings have not been tested. All photographs, measurements, floor plans and distances referred to are given as a guide and should not be relied upon.

[chaseevans.com](http://chaseevans.com)