



## Reverence House, Colindale Gardens, Lismore Boulevard, Colindale, NW9

Asking price **£625,000** | Leasehold



# Reverence House, Colindale Gardens, Lismore Boulevard, Colindale, NW9



3 Bedrooms



2 Bathrooms



1 Reception



Balcony



Gymnasium



Local Amenities



Concierge Service



0.4 MI Colindale

Spacious and well planned three bedroom, two bathroom property with a balcony within Reverence House which forms part of Colindale Gardens development in Colindale. This fantastic apartment includes an large open-plan living and dining area with access to a balcony, stylish fully fitted kitchen featuring integrated appliances, wood flooring, floor to ceiling glazing, recessed lighting, a master en suite with a shower, two further double bedrooms and a modern, full sized bathroom.

Residents also have access to a on-site concierge

service, gymnasium, sauna and a steam room. There are several amenities located nearby including restaurants, shops and cafés. The development is located a short distance from Colindale Underground station, providing a valuable transport link for commutes towards the City and West End.

**Tenure:** Leasehold (992 years remaining) **Local Authority:** Brent London

**Ground Rent:** £400 p.a. **Council Tax Band:** E

**Service Charge:** £4,708 p.a. **EPC:** B



# Floorplan

970 sq ft | 90.1 sq m

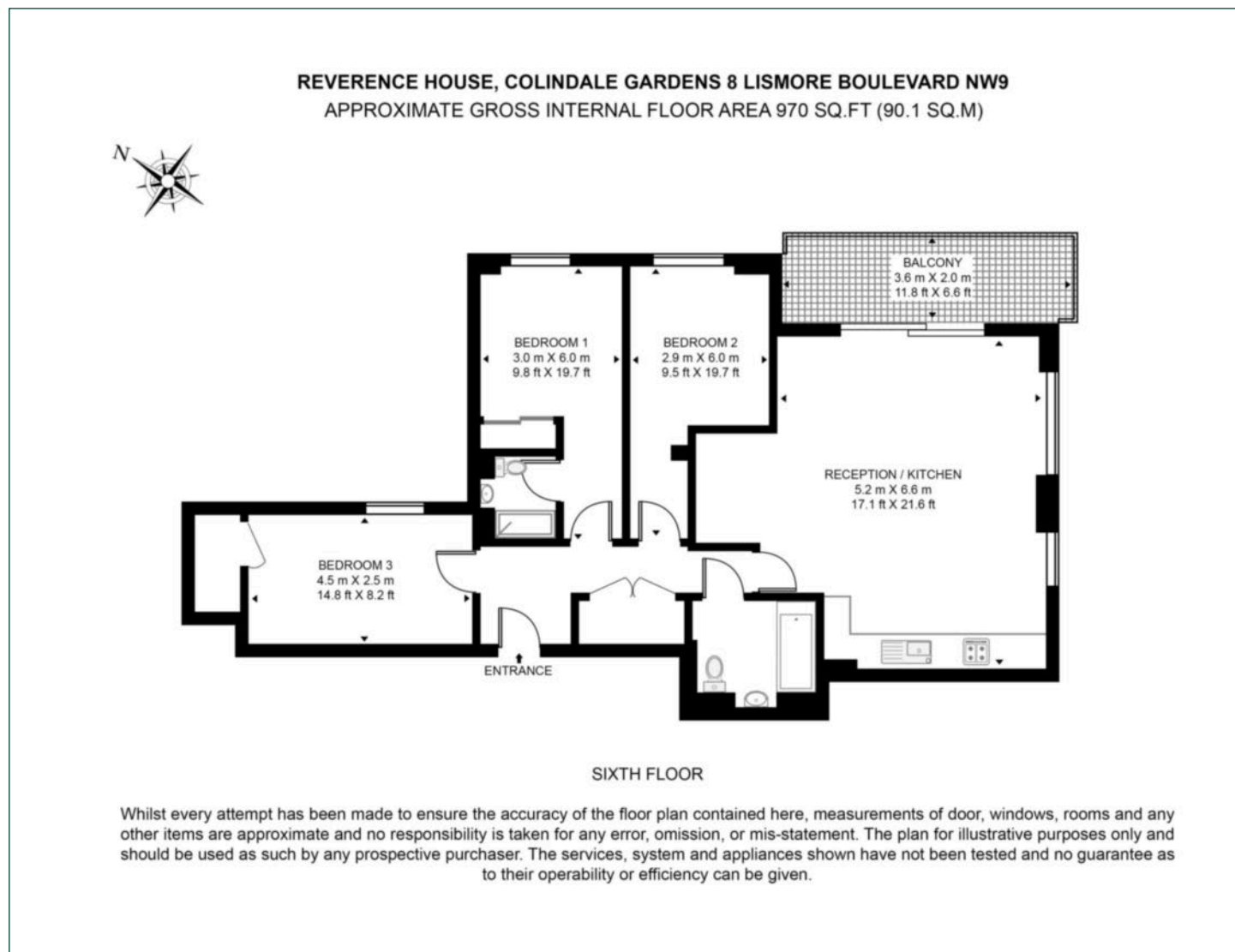

## City & Aldgate

122 Whitechapel High Street, London, E1 7PT

## Sales

020 7488 2777 | [city.sales@chaseevans.co.uk](mailto:city.sales@chaseevans.co.uk)

## We're here to help.

IMPORTANT NOTICE - These particulars have been prepared in good faith and they are not intended to constitute part of an offer or contract. We have not performed a structural survey on this property and the services, appliances and specific fittings have not been tested. All photographs, measurements, floor plans and distances referred to are given as a guide and should not be relied upon.

[chaseevans.com](https://chaseevans.com)