



## Cashmere House, Goodman's Fields, Leman Street, Aldgate, E1

Price **£700 per week** | Furnished



# Cashmere House, Goodman's Fields, Leman Street, Aldgate, E1



1 Bedroom



1 Bathroom



1 Reception



2 Balconies



Gymnasium



Local Amenities



24-Hour Concierge



0.2 MI Aldgate East

\*PHOTOS FOR ILLUSTRATIVE PURPOSES ONLY\*

A modern and spacious one bedroom apartment with two balconies set within Cashmere House; within the impressive Goodman's Fields development. The reception and dining are part of the open plan layout, dark finish oak floors, tall floor to ceiling windows, ample storage throughout, and recessed LED down lights throughout. Dimmers in the living room and bedroom. The Kitchen is custom fitted with Siemens appliances: induction hob, extractor hood, electric multi-function oven, dishwasher, fridge & freezer. (Appliances vary by apartment) Bathrooms are designed with chrome fixtures and heated towel rail, under floor heating, large format porcelain wall and floor tiles, and overhead shower and hand shower set with frameless glass. The bedrooms are spacious with fully fitted closet space with sensor lights, recessed down lighting,

and carpet flooring. Winter gardens are double glazed finish and sliding doors, balconies are finished in glass and steel with a timber decking.

Goodman's Fields also provides access to a 24-hour concierge service, private 28-seat cinema, residents' gymnasium with swimming pool, Jacuzzi and sauna, private business/dining suite, communal rooftop garden terrace. There are several amenities located nearby including shops, restaurants, bars and cafés. The cultural attractions of Brick Lane, Spitalfields and Shoreditch offer an exceptional selection of things to see and do all within a short distance. The development is located near to several transport links including Aldgate East Underground station, providing a valuable transport link for commutes across the Capital.



**Local Authority:**

Tower Hamlets

**Council Tax Band:**

E

**EPC:**

B

**Security deposit:**

equivalent to 5 weeks' rent

# Floorplan

538 sq ft | 49.98 sq m

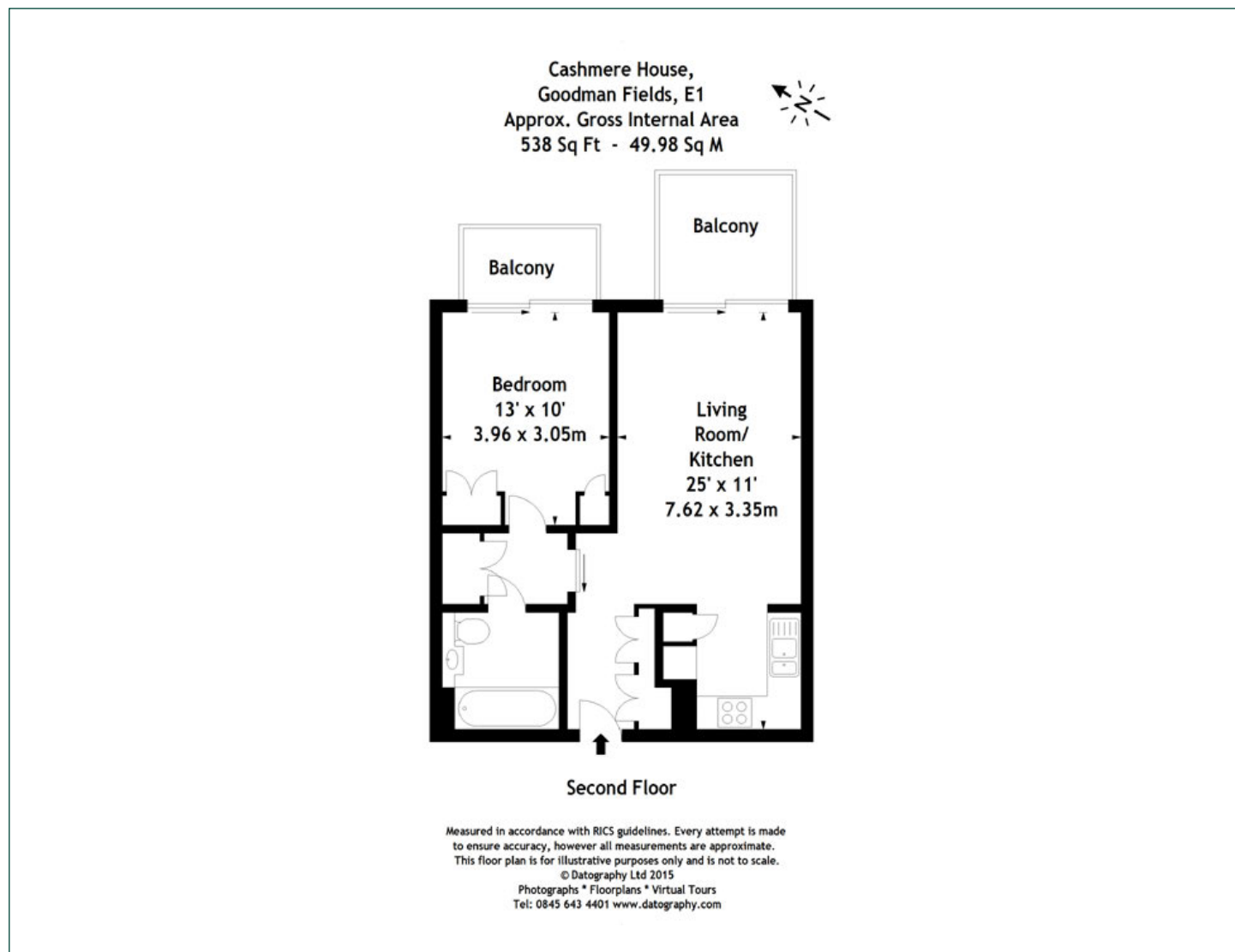

## City & Aldgate

122 Whitechapel High Street, London, E1 7PT

## Lettings

020 7247 3888 | [city.lettings@chaseevans.com](mailto:city.lettings@chaseevans.com)

## We're here to help.

IMPORTANT NOTICE - These particulars have been prepared in good faith and they are not intended to constitute part of an offer or contract. We have not performed a structural survey on this property and the services, appliances and specific fittings have not been tested. All photographs, measurements, floor plans and distances referred to are given as a guide and should not be relied upon.

[chaseevans.com](http://chaseevans.com)