



Thonrey Close, Colindale Gardens, Colindale, NW9

Price **£525 per week** | Furnished



Thonrey Close, Colindale Gardens, Colindale, NW9



1 Bedroom



1 Bathroom



1 Reception



Balcony



Gymnasium



Local Amenities



Concierge Service



0.4 MI Colindale

A stunning two bed duplex in Colindale Gardens. Comprising a spacious living area with full height windows leading to a large terrace, fitted kitchen, a large master bedroom with an en suite and access to the second good sized balcony, a further double bedroom and bathroom. Residents have access to a gymnasium and concierge service.

Colindale Gardens features approx. 9 acres of green space with walkways, cycle paths, play areas, large open grass areas and tranquil corners featuring attractive planting and trees.

Colindale is the nearest station serviced by

Northern Line. The West End and the City are under half an hour train ride away.



Local Authority:

Barnet London

Council Tax Band:

D

EPC:

B

Security deposit:

equivalent to 5 weeks' rent

Floorplan

1,076 sq ft | 100 sq m

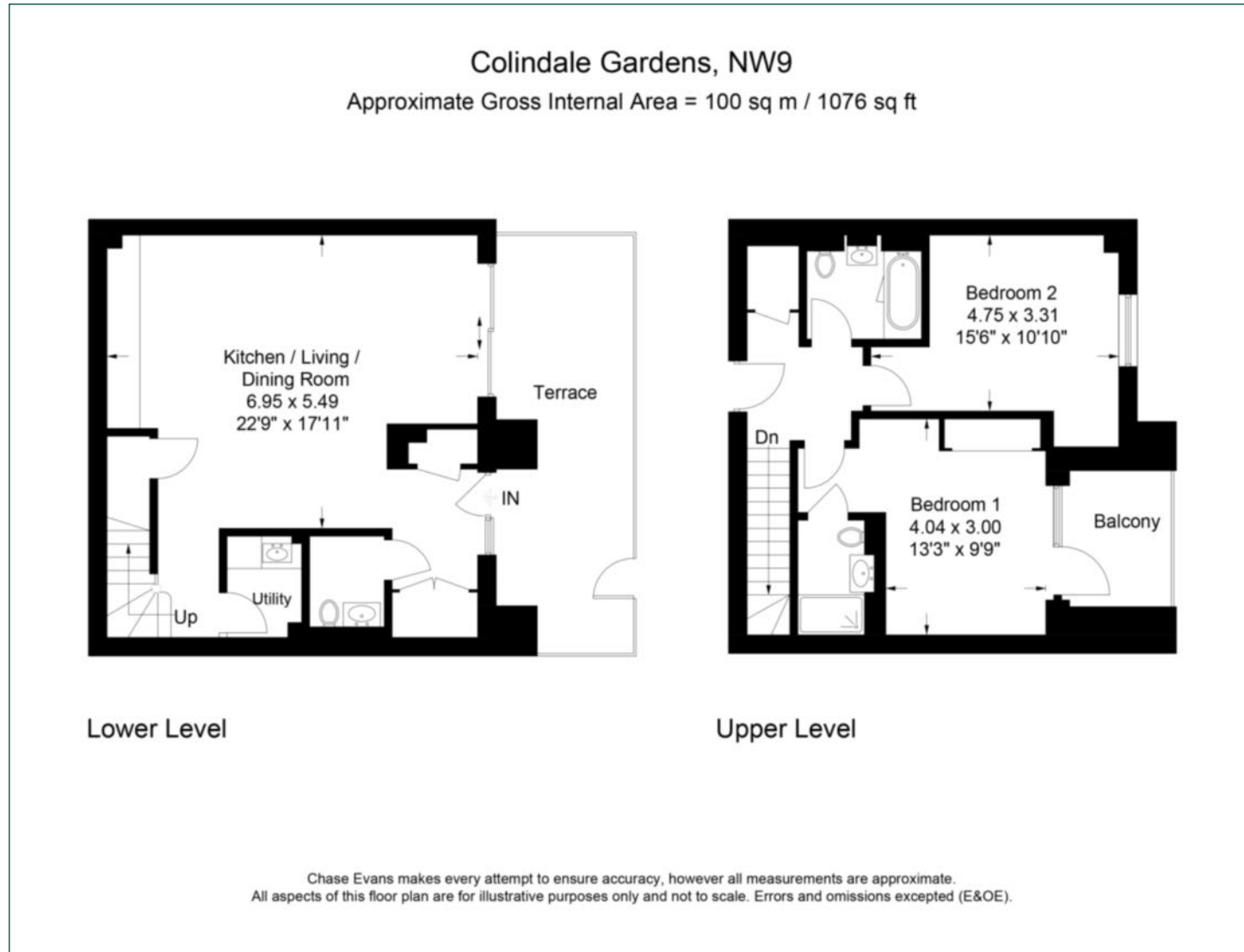

City & Aldgate

122 Whitechapel High Street, London, E1 7PT

Lettings

020 7247 3888 | city.lettings@chaseevans.com

We're here to help.

IMPORTANT NOTICE - These particulars have been prepared in good faith and they are not intended to constitute part of an offer or contract. We have not performed a structural survey on this property and the services, appliances and specific fittings have not been tested. All photographs, measurements, floor plans and distances referred to are given as a guide and should not be relied upon.

chaseevans.com