



The Heron, Milton Court, Moor Lane, Barbican, EC2Y

Price **£575 per week** | Furnished

 Chase Evans



The Heron, Milton Court, Moor Lane, Barbican, EC2Y



Studio



1 Bathroom



1 Reception



Balcony



Gymnasium



Local Amenities



24-Hour Concierge



0.4 MI Barbican



0.2 MI Moorgate

A modern studio apartment within The Heron, an exclusive development ideally located for a wealth of amenities and transport links. This designer-furnished studio apartment includes a fitted kitchen with integrated appliances, wood flooring, floor-to-ceiling windows, a separate spacious sleeping area, a stylish bathroom suite including a walk-in smart shower and a private balcony. Residents will also have access to a 24-hour concierge service, an on-site leisure complex, and an exclusive private residents' club which leads onto the communal garden terrace.

There are several amenities located nearby including restaurants, bars, shops, and cafés. Cultural attractions such as the Barbican Centre offer a great selection of events throughout the year, while nearby Shoreditch is the perfect place to try a new cuisine or shop at several of the independent boutiques in the area. The development is located near to several transport links including Moorgate station (3mins walk) and Barbican Station (9mins walk), providing underground and rail services for commutes across the Capital.

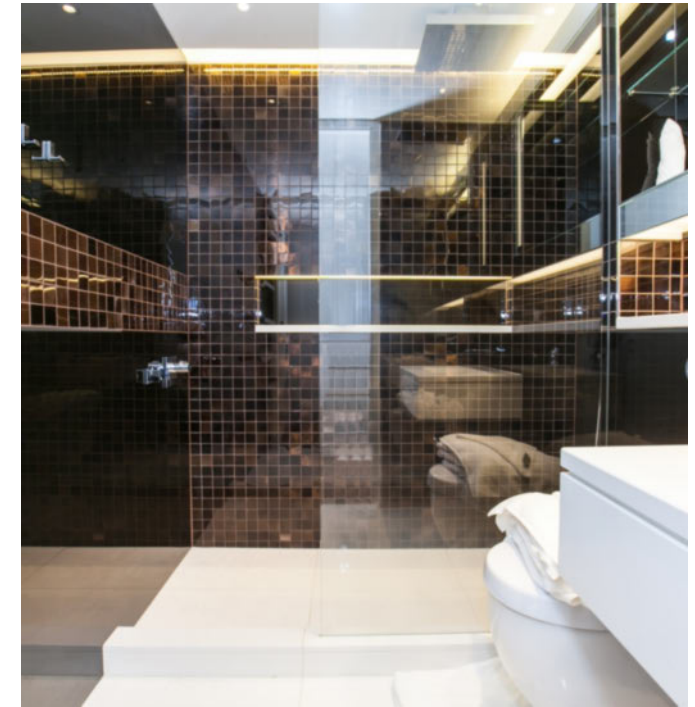

Local Authority: City and County of the City of London

Council Tax Band: E

EPC: C

Security deposit: equivalent to 5 weeks' rent

Floorplan

408 sq ft | 37.90 sq m

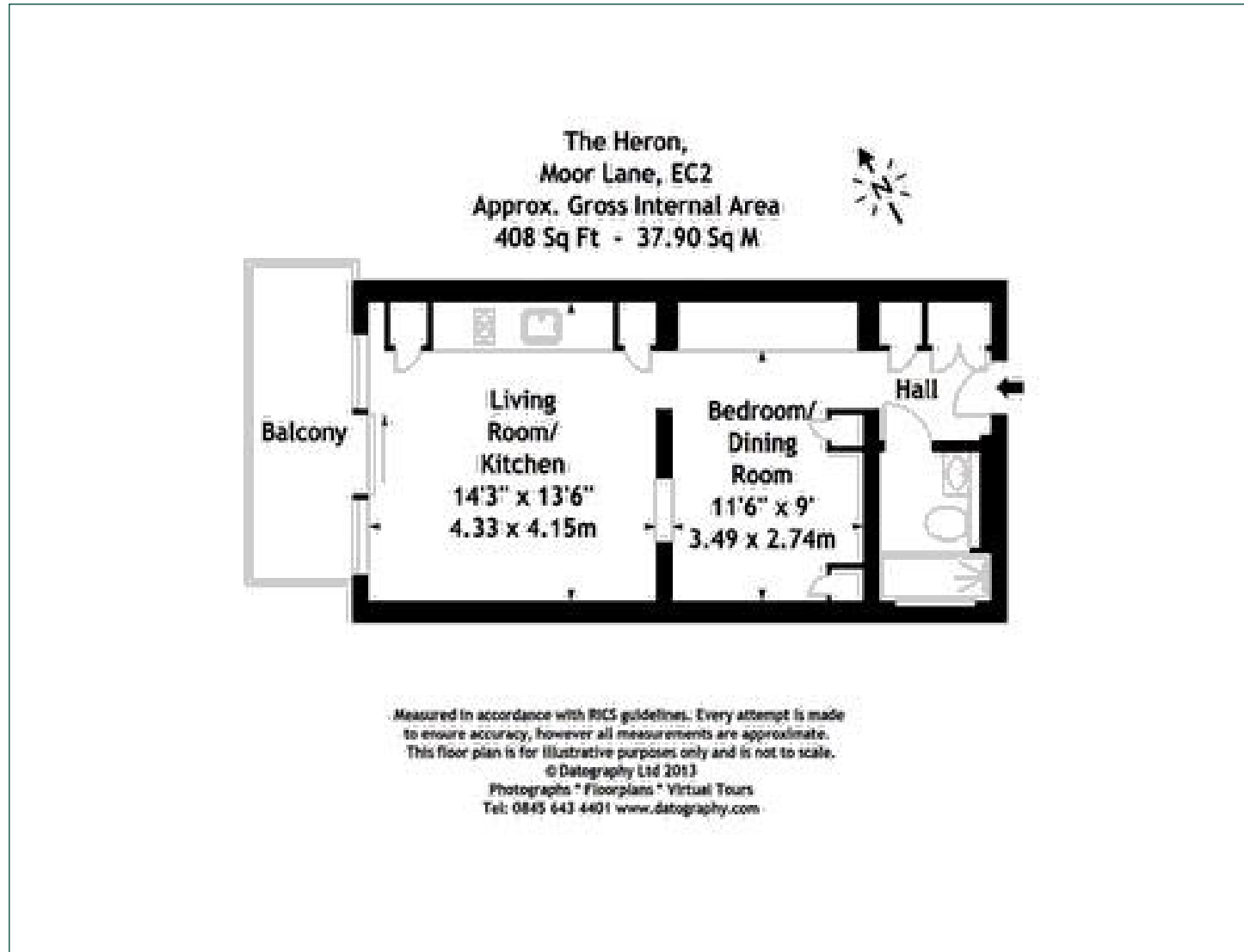

City & Aldgate

122 Whitechapel High Street, London, E1 7PT

Lettings

020 7247 3888 | city.lettings@chaseevans.co.uk

We're here to help.

IMPORTANT NOTICE - These particulars have been prepared in good faith and they are not intended to constitute part of an offer or contract. We have not performed a structural survey on this property and the services, appliances and specific fittings have not been tested. All photographs, measurements, floor plans and distances referred to are given as a guide and should not be relied upon.

chaseevans.com

 Chase Evans