

Montego Court, Myrdle Street, Whitechapel, E1

Price **£1,100 per week** | Furnished



Montego Court, Myrdle Street, Whitechapel, E1



4 Bedrooms



3 Bathrooms



1 Reception



Private Garden



Prime Location



Local Amenities



0.4 MI Whitechapel

Spanning over 1,540 sq ft this standout newly refurbished property is enviably nestled within this attractive Georgian style mansion block in a quiet residential street near to Leman Street and Whitechapel Road. This split-level home is close to four stations and boasts four bedrooms, a study, three bathrooms, a WC and a large private garden. The property features a secure entry and wood flooring and recessed lighting throughout.

Residents of Montego Court benefit from a close proximity to a range of amenities and transport links. The City of London is a short walk away. Spitalfields is

less than a mile away and is where you will find a variety of markets, restaurants, shops, bars and pubs. The Royal London Hospital (6mins walk) and Queen Mary University is close by on foot, bus or bicycle.

Montego Court is located in Zone 1 and is close to Whitechapel Station (8 mins walk), Aldgate East Station (10mins walk), Shadwell Station (11 mins walk) and Aldgate Station (13mins walk). The Elizabeth line from Whitechapel benefits from easy access in to Tottenham Court Road, Bond Street, Stratford for Westfield, and Heathrow Airport. London City Airport can be reached in 15 minutes.

Local Authority:

Tower Hamlets

Council Tax Band:

F

EPC:

B

Security deposit:

equivalent to 5 weeks' rent



Floorplan

1,540 sq ft | 143.1 sq m

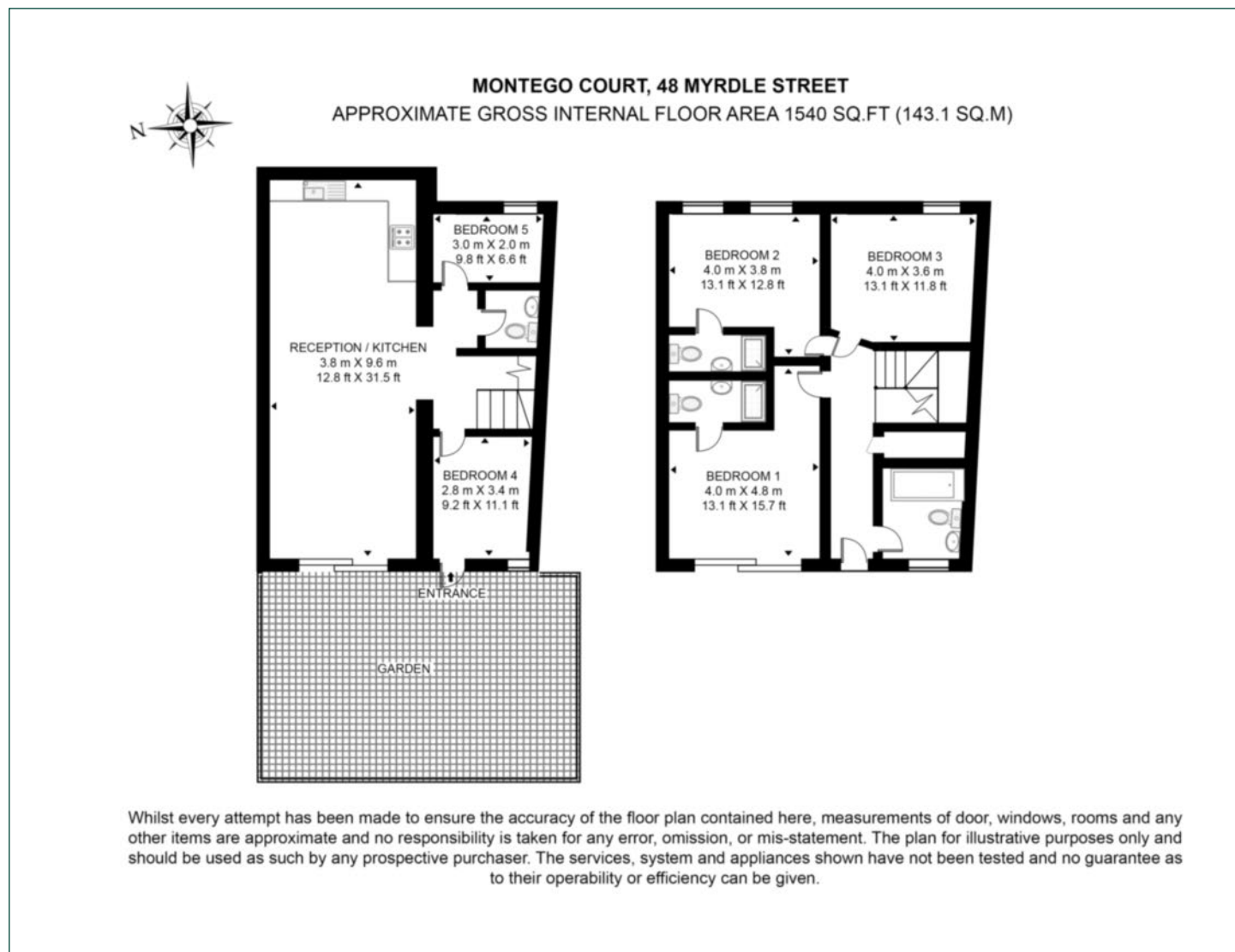

Canary Wharf

Horizon Building, 15 Hertsmere Road, London, E14 4AW

Lettings

020 7515 1000 | canarywharf.lettings@chaseevans.com

We're here to help.

IMPORTANT NOTICE - These particulars have been prepared in good faith and they are not intended to constitute part of an offer or contract. We have not performed a structural survey on this property and the services, appliances and specific fittings have not been tested. All photographs, measurements, floor plans and distances referred to are given as a guide and should not be relied upon.

chaseevans.com

 Chase Evans