



## Altitude Point, Alie Street, Aldgate, E1

Price **£620 per week** | Furnished



# Altitude Point, Alie Street, Aldgate, E1



1 Bedroom



1 Bathroom



1 Reception



Lift Access



Communal Roof Terrace



Local Amenities



24-Hour Concierge



0.2 MI Aldgate East

This modern and light one bedroom property is set on the 12th floor of Altitude Point, a recent contemporary development conveniently situated for The Square Mile, Shoreditch, Whitechapel and Tower Bridge.

The property offers open plan kitchen/living room, ample bedroom and a modern bathroom. Features include full length windows, Amtico oak plank flooring, comfort cooling, a built in bedroom wardrobe, high-quality kitchen appliances, and smartly bathroom fittings.

The development provides 24-hour concierge services and offers access to a 25th floor communal roof terrace.

Aldgate has become a sought-after residential district with significantly improved amenities followed by highly prized developments one of which is the Altitude Point. The development is set back from the main street and enjoys a relatively quiet location with new shops, cafes and restaurants. The property benefits from the new pedestrianised paths and landscaped gardens at the adjacent Goodman's Fields quarters.

Transport links are fantastic: Aldgate East (District, Hammersmith & City line), Whitechapel (Crossrail, Elizabeth line), Fenchurch (National Rail), Liverpool Street (National Rail, TFL, Central, Metropolitan, Circle, District, Hammersmith and City line).

**Local Authority:**

Tower Hamlets

**Council Tax Band:**

E

**EPC:**

B

**Security deposit:**

equivalent to 5 weeks' rent

# Floorplan

511 sq ft | 47.47 sq m

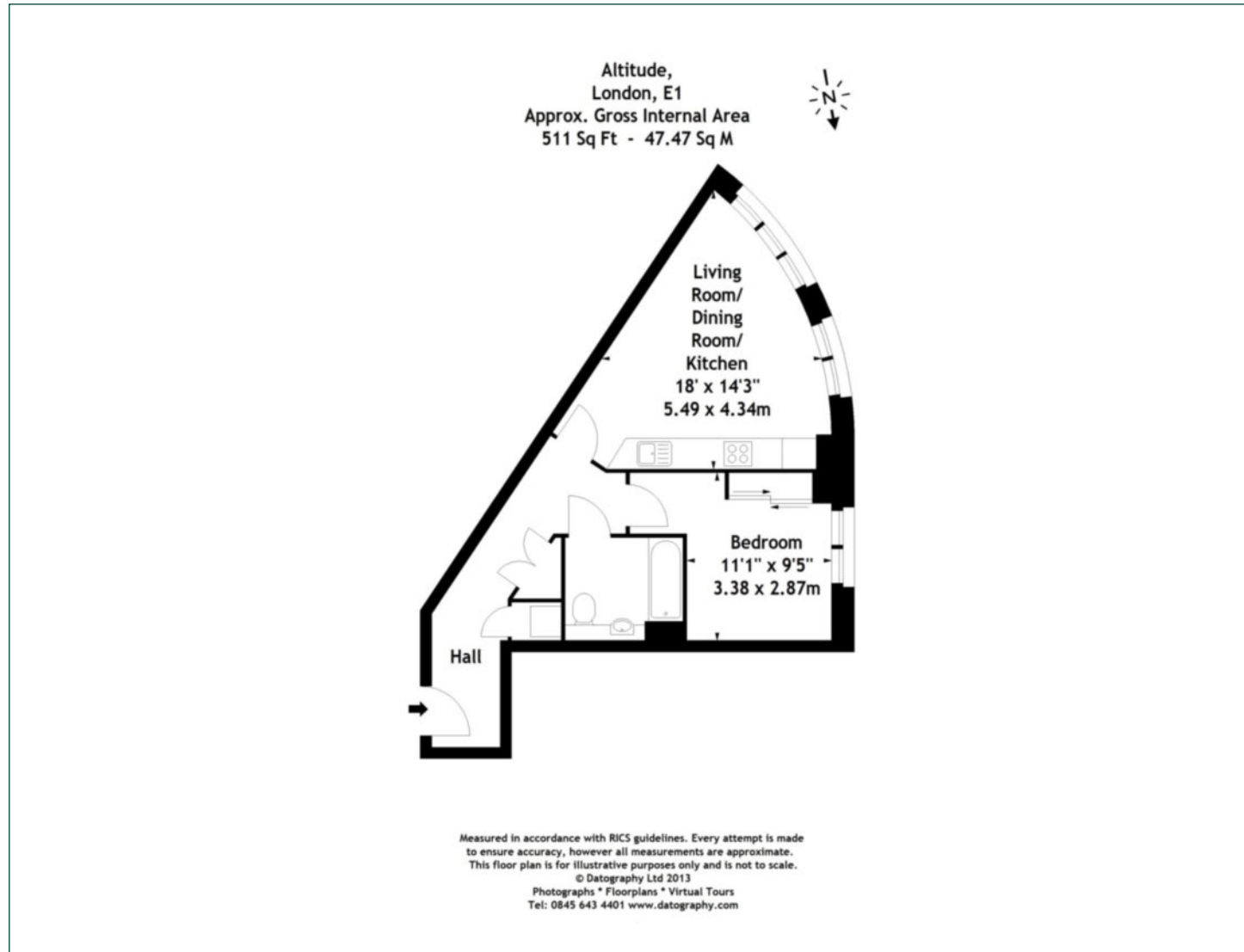

## City & Aldgate

122 Whitechapel High Street, London, E1 7PT

## Lettings

020 7488 2777 | [city.sales@chaseevans.co.uk](mailto:city.sales@chaseevans.co.uk)

## We're here to help.

IMPORTANT NOTICE - These particulars have been prepared in good faith and they are not intended to constitute part of an offer or contract. We have not performed a structural survey on this property and the services, appliances and specific fittings have not been tested. All photographs, measurements, floor plans and distances referred to are given as a guide and should not be relied upon.

[chaseevans.com](http://chaseevans.com)

 Chase Evans