



## Lattice House, Alie Street, Aldgate, E1

Price **£495 per week** | Furnished



# Lattice House, Alie Street, Aldgate, E1



1 Bedroom



1 Bathroom



1 Reception



Great Local Amenities



0.2 MI Aldgate East



0.8 Whitechapel

Contemporary one bedroom apartment within Lattice House, a modern development located in Aldgate E1. The apartment includes an inviting open plan living space with wood flooring, a fully integrated kitchen, a good sized bedroom and a contemporary bathroom.

There is an onsite gym and several amenities located nearby including restaurants, bars, cafés, shops and cultural attractions, including the Whitechapel Gallery.

The development is located close to several transport links including Aldgate East Underground station (6-min walk), ideal for commutes along Circle and District lines, and Elizabeth Line at Whitechapel station offers faster journeys to other main destinations in London.

<b>Local Authority:</b>	Tower Hamlets
<b>Council Tax Band:</b>	E
<b>EPC:</b>	C
<b>Security deposit:</b>	equivalent to 5 weeks' rent

# Floorplan

541 sq ft | 50.26 sq m

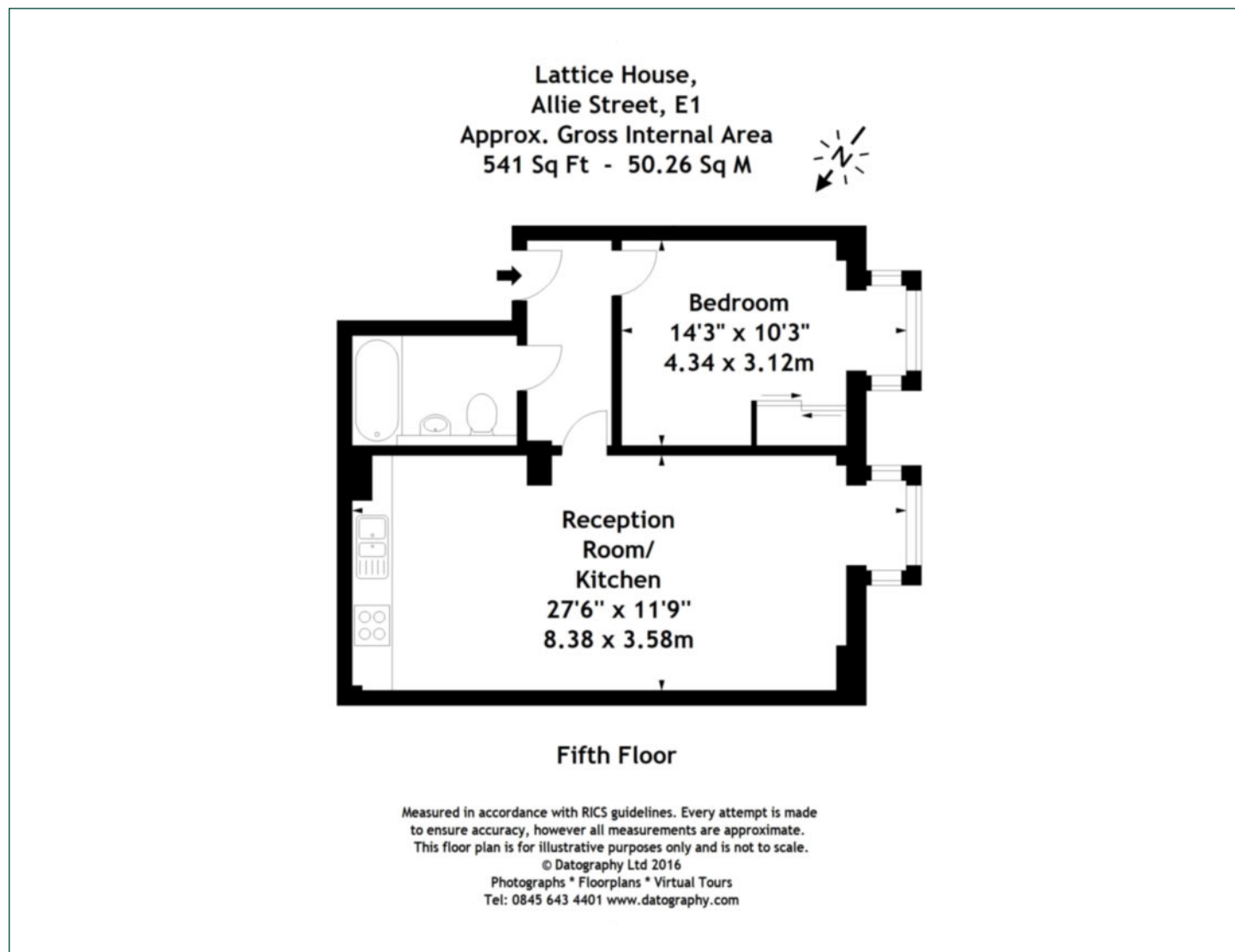

## City & Aldgate

122 Whitechapel High Street, London, E1 7PT

## Lettings

020 7488 2777 | [city.sales@chaseevans.co.uk](mailto:city.sales@chaseevans.co.uk)

## We're here to help.

IMPORTANT NOTICE - These particulars have been prepared in good faith and they are not intended to constitute part of an offer or contract. We have not performed a structural survey on this property and the services, appliances and specific fittings have not been tested. All photographs, measurements, floor plans and distances referred to are given as a guide and should not be relied upon.

[chaseevans.com](http://chaseevans.com)