

Lassen House, Colindale Gardens, Colindale NW9

Asking price **£340,000** | Leasehold



Lassen House, Colindale Gardens, Colindale NW9



1 Bedroom



1 Bathroom



1 Reception



Generous Balcony



Residents' Gym



Concierge



Communal Gardens



Great Local Amenities



0.3 MI Colindale

This modern one-bedroom property is set in Lassen House, part of the popular Colindale Gardens development in NW9. Spacious and bright, the apartment comprises an open-plan kitchen/living room leading to a generous balcony, an ample-sized bedroom, and a contemporary family bathroom.

Features include floor-to-ceiling glazing, Amtico Spacia flooring, ample fitted wardrobe and further storage space, recessed lighting and modern bathroom fittings and ware.

Residents of Colindale Gardens have access to a gymnasium and concierge service. Situated within one of the largest regeneration zones in North London, this is a top-rated new home development in Colindale boasting extensive outdoor space with playgrounds and parks. A wide range of amenities is available at Colindale Avenue where the Colindale tube station is located. The station is served by Northern Line trains, providing underground journey to Kings Cross within 30 minutes.

Tenure: Leasehold (992 years remaining)

Local Authority: Barnet London

Ground Rent: £200 p.a.

Council Tax Band: C

Service Charge: £3,622.88 p.a.

EPC: B

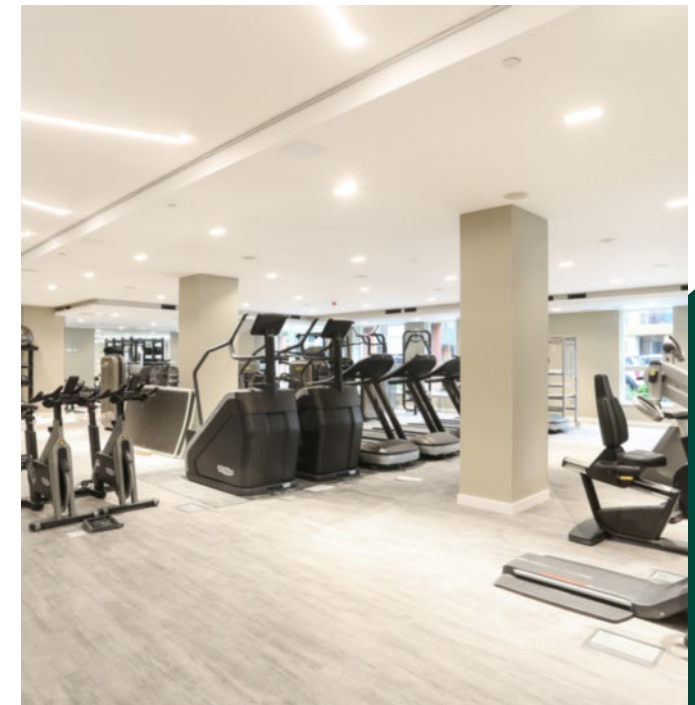

Floorplan

560 sq ft | 52.0 sq m

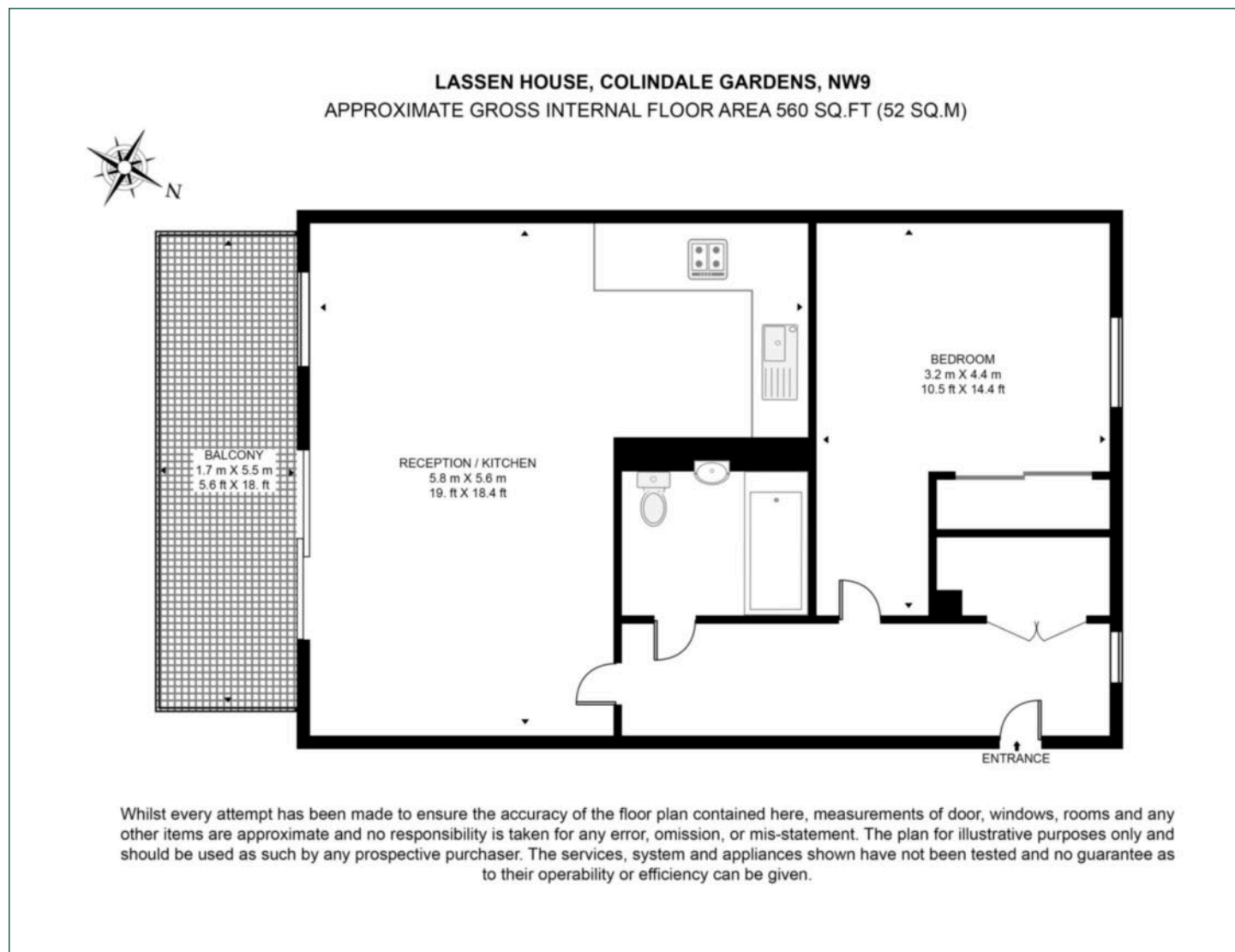

City & Aldgate

122 Whitechapel High Street, London, E1 7PT

Sales

020 7488 2777 | city.sales@chaseevans.com

We're here to help.

IMPORTANT NOTICE - These particulars have been prepared in good faith and they are not intended to constitute part of an offer or contract. We have not performed a structural survey on this property and the services, appliances and specific fittings have not been tested. All photographs, measurements, floor plans and distances referred to are given as a guide and should not be relied upon.

chaseevans.com