



## Griffin Court, Saxon Square, Luton, LU2

Price **£275 per week** | Furnished



# Griffin Court, Saxon Square, Luton, LU2



1 Bedroom



1 Bathroom



1 Reception



Local Amenities



Nearby Luton Airport



0.7 MI Luton AirPort Parkway

A beautifully designed one bedroom apartment on the first floor of this exciting new development, Saxon Square, in the commuter town of Luton LU2. The Property features a spacious open plan reception with high specification fitted kitchen, a large bedroom with built-in wardrobe and a modern bathroom suite.

The development benefits from being perfectly situated for close access to London Luton Airport. The property is also within walking distance to Luton Town Center and all of it's amenities including local shops, schools, parks and access to

commuter links such as Luton's Mainline Thames-Link Train Station, J10 of the M1. Commutes to London St Pancras International Station are just 30mins.



|                          |                             |
|--------------------------|-----------------------------|
| <b>Local Authority:</b>  | Luton                       |
| <b>Council Tax Band:</b> | A                           |
| <b>EPC:</b>              | B                           |
| <b>Security deposit:</b> | equivalent to 5 weeks' rent |

# Floorplan

526 sq ft | 48.9 sq m

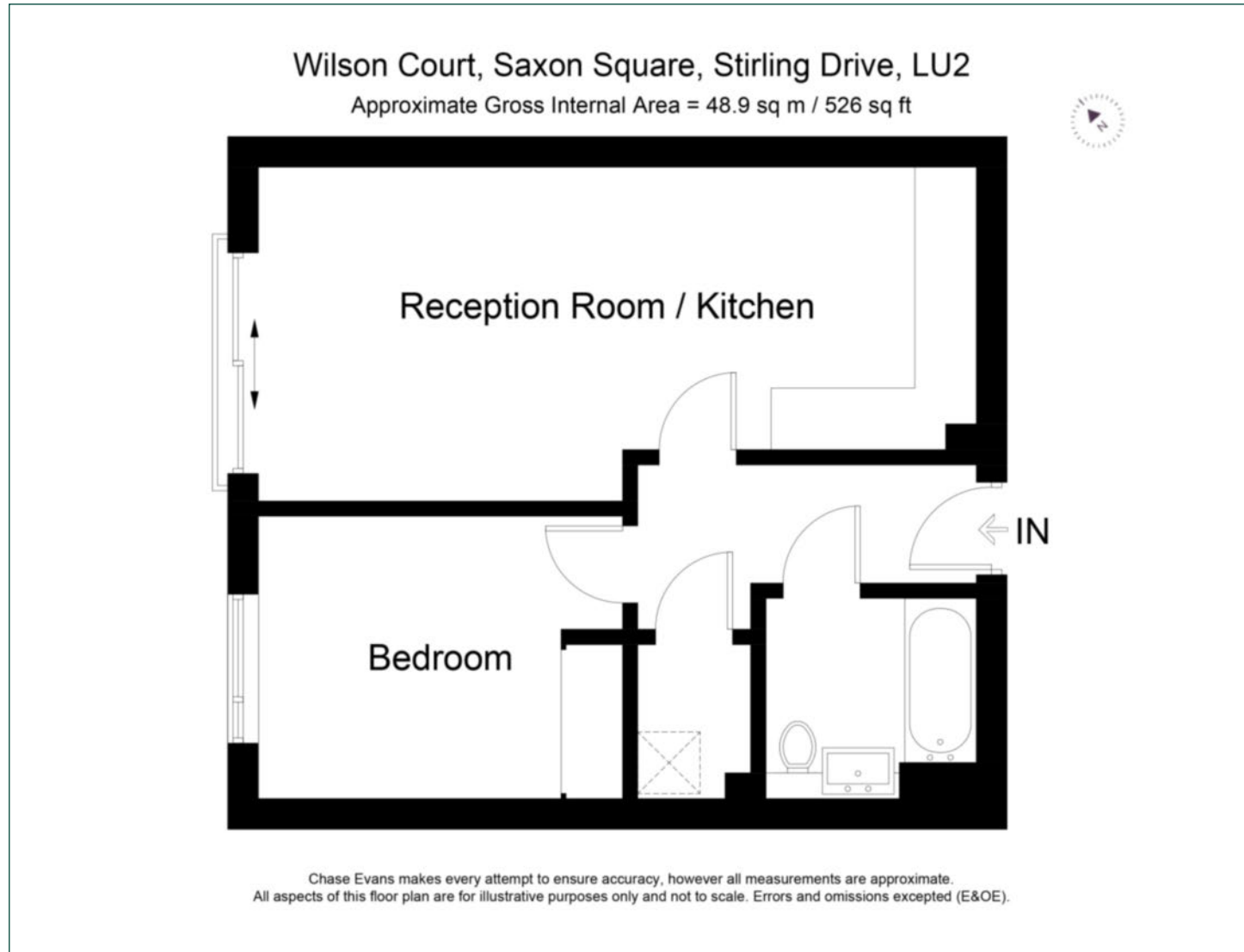

## City & Aldgate

122 Whitechapel High Street, London, E1 7PT

## Lettings

020 7247 3888 | [city.lettings@chaseevans.com](mailto:city.lettings@chaseevans.com)

## We're here to help.

IMPORTANT NOTICE - These particulars have been prepared in good faith and they are not intended to constitute part of an offer or contract. We have not performed a structural survey on this property and the services, appliances and specific fittings have not been tested. All photographs, measurements, floor plans and distances referred to are given as a guide and should not be relied upon.

[chaseevans.com](https://www.chaseevans.com)