

Cashmere House, Goodman's Fields, Aldgate, E1

Price **£700 per week** | Furnished



Cashmere House, Goodman's Fields, Aldgate, E1



1 Bedroom



1 Bathroom



1 Reception



Winter Garden



Gym



Pool & Spa



Residents' Cinema



24-Hour Concierge



0.1 MI Aldgate East

A spacious one bedroom apartment set within the prestigious Goodman's Fields development, Aldgate E1. The bright and generous living space comprises an open plan kitchen/reception room featuring wood flooring and recessed lighting, which extends onto a private winter garden. The apartment has a well-proportioned bedroom and a large bathroom.

Residents have access to a 24-hour concierge service, private cinema, communal gardens, business lounge, residents' gymnasium, swimming pool and a spa.

There are several amenities located nearby including restaurants, bars, cafés, shops and cultural attractions such as the Whitechapel Gallery. Being only a short walk from the City, Tower Bridge, Spitalfields Market and St Katharine Marina, the apartment provides more options of amenities. The development is located near to several transport links including Aldgate East Underground station, and Whitechapel and Liverpool stations are within easy access, for commutes across the City and towards the West End.

Local Authority: Tower Hamlets

Council Tax Band: E

EPC: B

Security deposit: equivalent to 5 weeks' rent

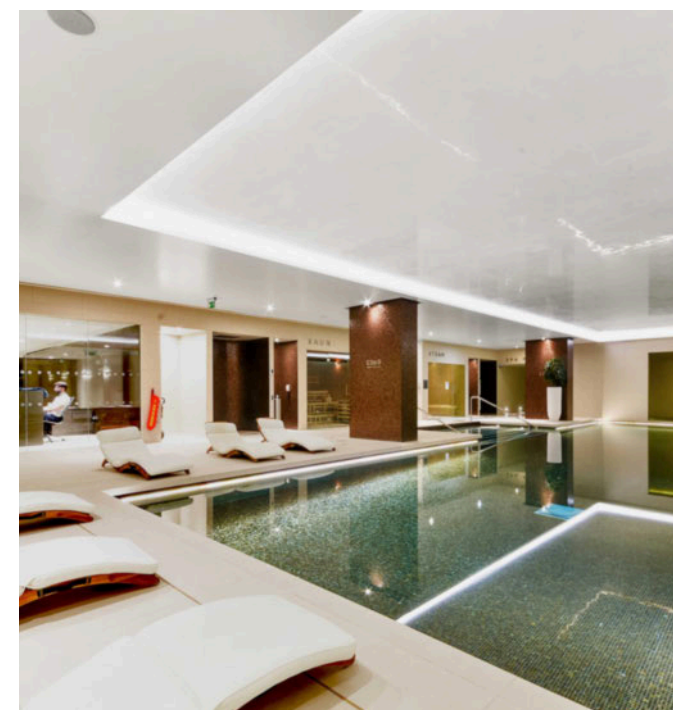

Floorplan

539 sq ft | 50.0 sq m

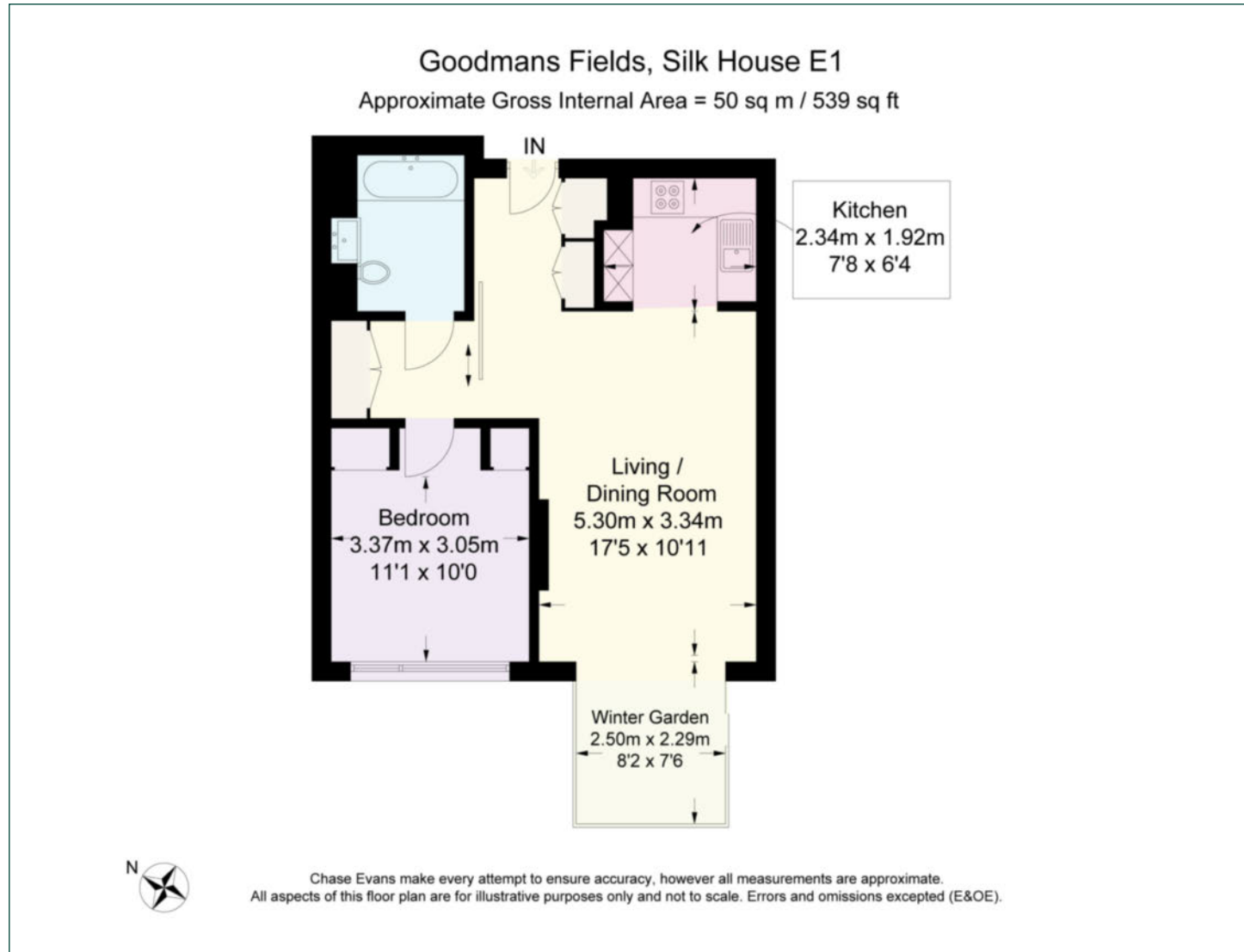

City & Aldgate

122 Whitechapel High Street, London, E1 7PT

Lettings

020 7247 3888 | city.lettings@chaseevans.com

We're here to help.

IMPORTANT NOTICE - These particulars have been prepared in good faith and they are not intended to constitute part of an offer or contract. We have not performed a structural survey on this property and the services, appliances and specific fittings have not been tested. All photographs, measurements, floor plans and distances referred to are given as a guide and should not be relied upon.

chaseevans.com