



Islington Square, Esther Anne Place, Islington, N1

Price **£625 per week** | Furnished



Islington Square, Esther Anne Place, Islington, N1



1 Bedroom



1 Bathroom



1 Reception



24-Hour Concierge



Communal Landscaped Gardens



Near Amenities of Islington High St



0.5 MI Angel

A stylish, contemporary one bedroom apartment set within the modern Islington Square development. The property features high quality finishes and includes an open-plan living/dining area, fully integrated kitchen, master bedroom with fitted wardrobes and modern fully tiled shower room.

The prestigious development offers 24-hour concierge service and access to communal landscaped gardens.

Located on the high street in Islington moments from the many restaurants and cafes and right opposite St Mary's church and surrounding gardens.

Located in the heart of Islington near to Angel Station (Northern Line) and Highbury and Islington Stations (London Overground and Victoria Line) along with access to an extensive network of buses from Upper Street. Excellent transport links enable residents to be in the City in approximately ten minutes and the West End in twenty minutes



Local Authority:

Islington London

Council Tax Band:

D

EPC:

C

Security deposit:

equivalent to 5 weeks' rent

Floorplan

463 sq ft | 43 sq m

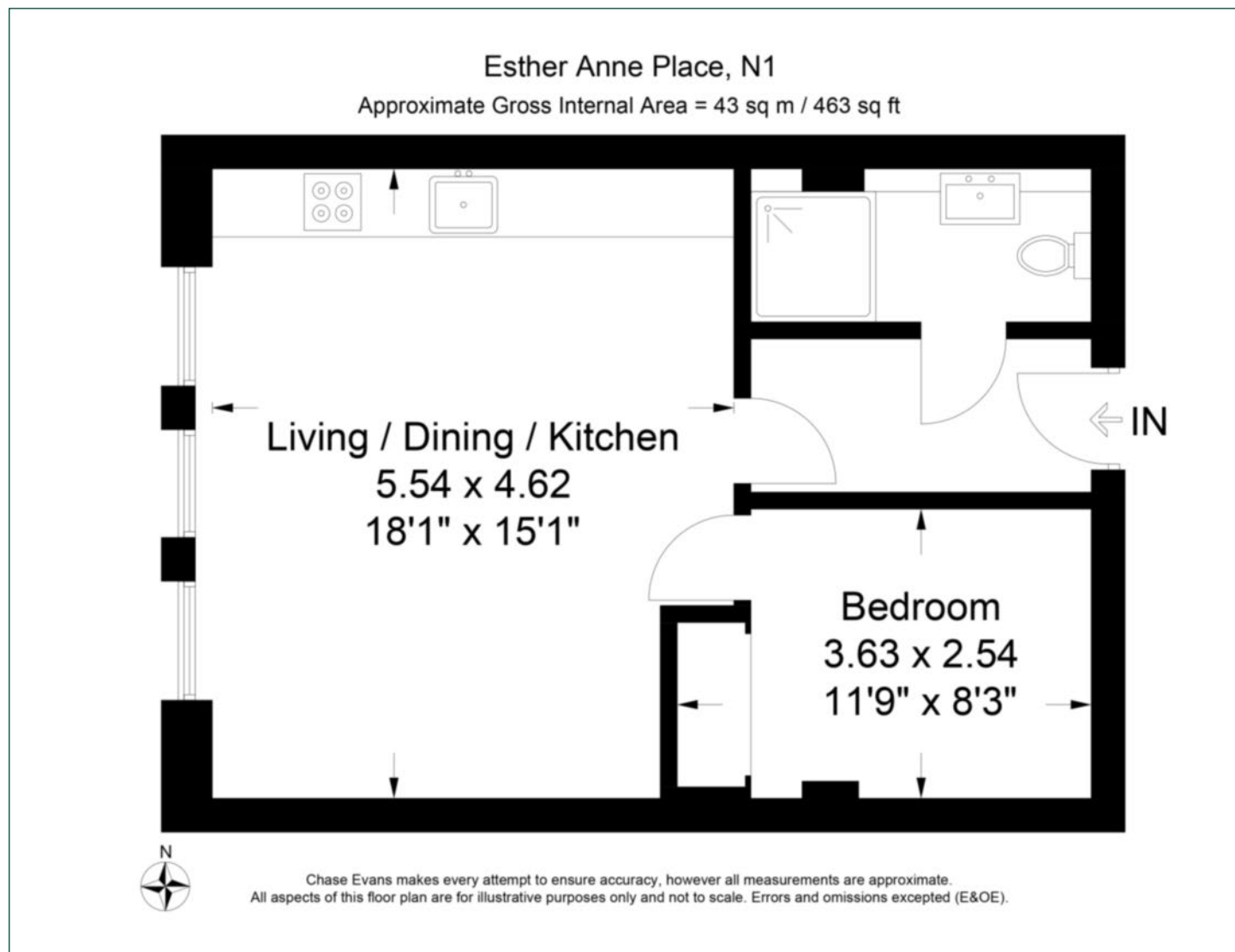

City & Aldgate

122 Whitechapel High Street, London, E1 7PT

Lettings

020 7247 3888 | city.lettings@chaseevans.com

We're here to help.

IMPORTANT NOTICE - These particulars have been prepared in good faith and they are not intended to constitute part of an offer or contract. We have not performed a structural survey on this property and the services, appliances and specific fittings have not been tested. All photographs, measurements, floor plans and distances referred to are given as a guide and should not be relied upon.

chaseevans.com

 Chase Evans