



Reverence House, Colindale Gardens, Lismore Boulevard, Colindale, NW9

Price **£395 per week** | Furnished



Reverence House, Colindale Gardens, Lismore Boulevard, Colindale, NW9



1 Bedroom



1 Bathroom



1 Reception



Terrace



Gymnasium



Local Amenities



0.4 MI Colindale

A one bedroom apartment set within the modern Reverence House development in Colindale NW9. The property includes a spacious living area with Siemens integrated kitchen appliances, underfloor heating, engineered timber flooring, large private terrace, video door entry and modern bathroom décor.

Residents benefit from a concierge service & residents gymnasium. Colindale Gardens features approx. 9 acres of green space with walkways, cycle paths, play areas, large open grass areas and tranquil corners featuring attractive planting and

trees.

There are several amenities located a short distance away including restaurants, shops and cafés. The development is located near to Colindale Underground station, providing a valuable transport link for commutes towards the City and West End. The development is located a short distance away from Colindale Underground station.

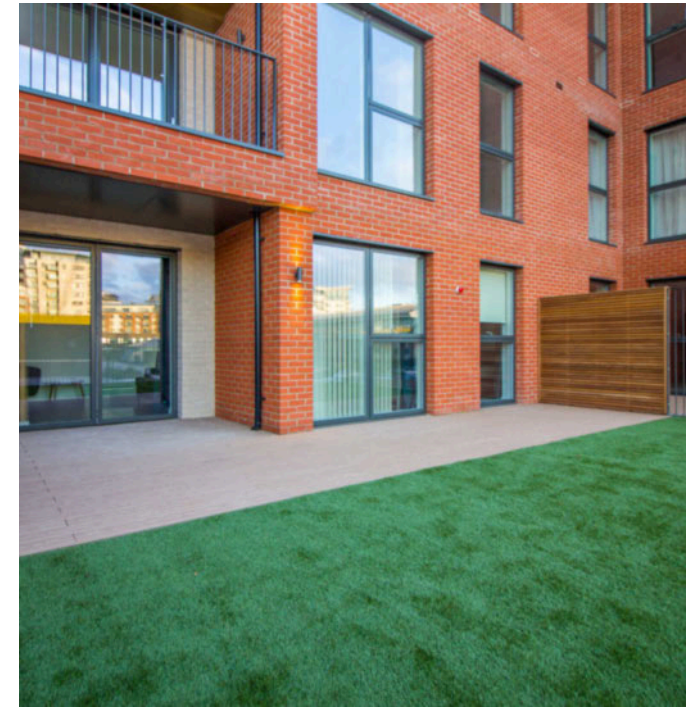

Local Authority:

Barnet London

Council Tax Band:

C

EPC:

B

Security deposit:

equivalent to 5 weeks' rent

Floorplan

610 sq ft | 56.7 sq m

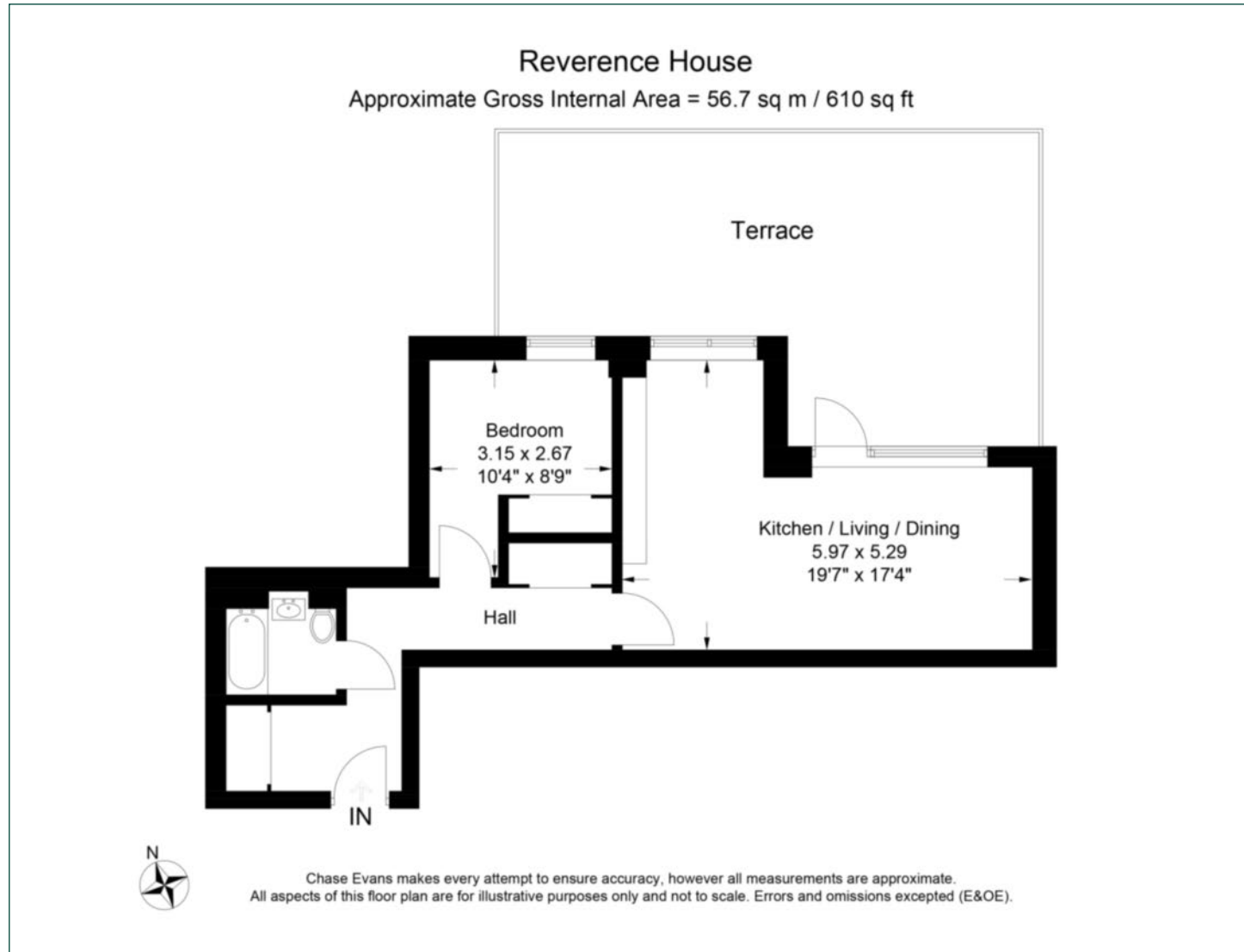

City & Aldgate

122 Whitechapel High Street, London, E1 7PT

Lettings

020 7247 3888 | city.lettings@chaseevans.com

We're here to help.

IMPORTANT NOTICE - These particulars have been prepared in good faith and they are not intended to constitute part of an offer or contract. We have not performed a structural survey on this property and the services, appliances and specific fittings have not been tested. All photographs, measurements, floor plans and distances referred to are given as a guide and should not be relied upon.

chaseevans.com