

Georgette Apartments, The Silk District, Cendal Crescent, Whitechapel, E1

Price **£550 per week** | Furnished



Georgette Apartments, The Silk District, Cendal Crescent, Whitechapel, E1



1 Bedroom



1 Bathroom



1 Reception



Balcony



Gymnasium



Local Amenities



24-Hour Concierge



0.2 MI Whitechapel

Modern one bedroom apartment set in The Georgette Apartments, one of three buildings forming The Silk District development in Whitechapel E1, a short walk from the City of London. This property comprises a spacious open-plan living area, semi-separate high-spec kitchen, large private terrace, sizable master bedroom with fitted wardrobes, a pristine bathroom suite and ample storage space throughout.

The development provides 24-hour concierge services, access to an onsite gym, screening room, flexible workspace and a roof terrace. The nearest

station is Whitechapel a 5-min walk away. The development neighbours the vibrant Shoreditch, Brick Lane, Aldgate and Bethnal Green.

Local Authority:

Tower Hamlets

Council Tax Band:

E

EPC:

B

Security deposit:

equivalent to 5 weeks' rent



Floorplan

548 sq ft | 50.9 sq m

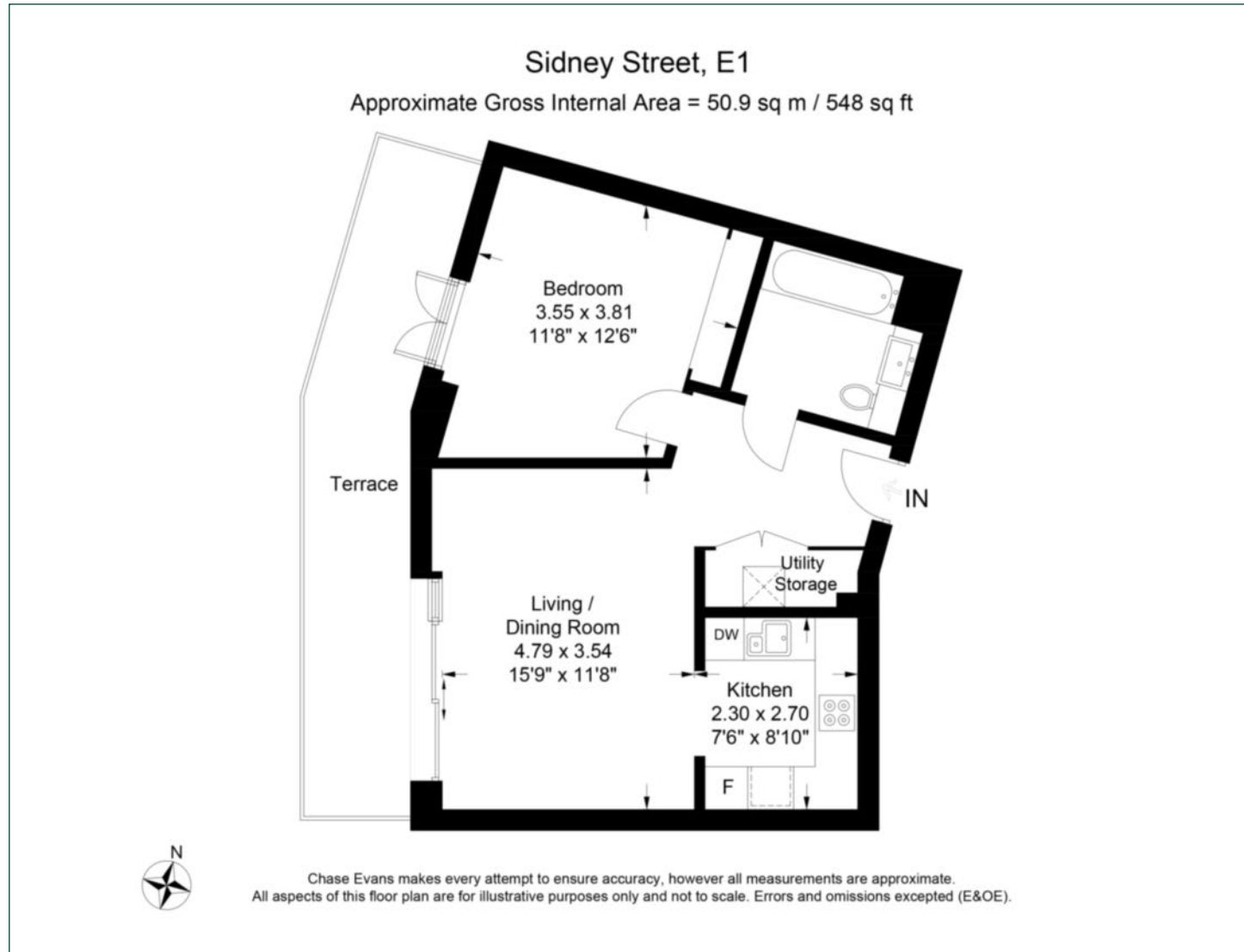

City & Aldgate

122 Whitechapel High Street, London, E1 7PT

Lettings

020 7247 3888 | city.lettings@chaseevans.co.uk

We're here to help.

IMPORTANT NOTICE - These particulars have been prepared in good faith and they are not intended to constitute part of an offer or contract. We have not performed a structural survey on this property and the services, appliances and specific fittings have not been tested. All photographs, measurements, floor plans and distances referred to are given as a guide and should not be relied upon.

[chaseevans.com](https://www.chaseevans.com)