



Kensington Apartments, Commercial Street, Whitechapel, E1

Price **£750 per week** | Furnished



Kensington Apartments, Commercial Street, Whitechapel, E1



2 Bedrooms



2 Bathrooms



1 Reception



Balcony



Gymnasium



Local Amenities



0.1 MI Aldgate East



Luxury two bedrooms, two bathrooms property offers a spacious open-plan living room, private balcony with southerly views, high specification kitchen with fully integrated Siemens appliances, contemporary master en-suite and family bathrooms, engineered oak flooring living room and hallways, and carpets in the bedrooms.

landscaped courtyards, state-of-the-art gymnasium and the spectacular roof terrace offering 360° views of London.

Cityscape offers residents an exclusive address in the very heart of the City of London. Ideally located in Commercial Street E1, this 12-storey development offers the height of luxury living, comfort and privacy. Residents enjoy 24-hour concierge, private

Local Authority:	Tower Hamlets
Council Tax Band:	F
EPC:	B
Security deposit:	5 weeks' equivalent

Floorplan

780 sq ft | 72.5 sq m

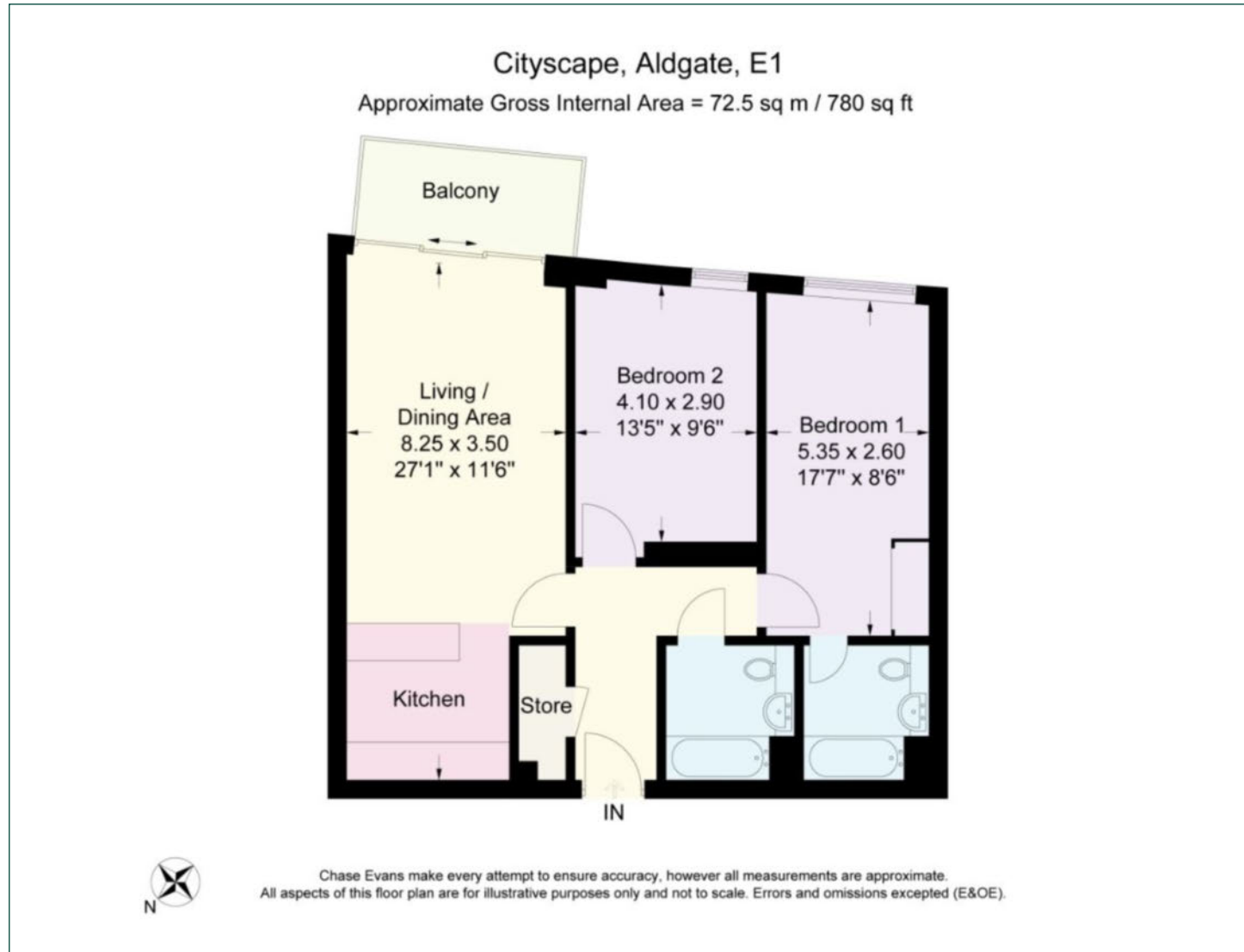

Lettings

We're here to help.

IMPORTANT NOTICE - These particulars have been prepared in good faith and they are not intended to constitute part of an offer or contract. We have not performed a structural survey on this property and the services, appliances and specific fittings have not been tested. All photographs, measurements, floor plans and distances referred to are given as a guide and should not be relied upon.

chaseevans.com