









Lincoln Square, Portugal Street, Holborn, WC2A

Price **£950 per week** | Furnished



Lincoln Square, Portugal Street, Holborn, WC2A

-  1 Bedroom
-  1 Bathroom
-  1 Reception
-  Gymnasium
-  Local Amenities
-  24-Hour Concierge
-  0.3 MI Holborn

Spacious one bedroom apartment set this brand new prestigious development set within the heart of Central London. This stunning property comprises a sizable living/dining area, modern kitchen with integrated appliances, large master bedroom with fitted wardrobes, master ensuite/shower room. Excellent transport links just a short walking distance to Holborn and Chancery Lane.

Residents will enjoy an abundance of exclusive amenities, which includes a 25 metre pool with adjoining vitality pool, Secure underground

parking, cinema, gym, residents lounge, private dining rooms, kids soft play area along with a 24-hour uniformed concierge service. Also a further 6,000 sq ft of private landscaped garden.

Local Authority: City of Westminster London

Council Tax Band: F

EPC: B

Security deposit: equivalent to 5 weeks' rent



Floorplan

549 sq ft | 51 sq m

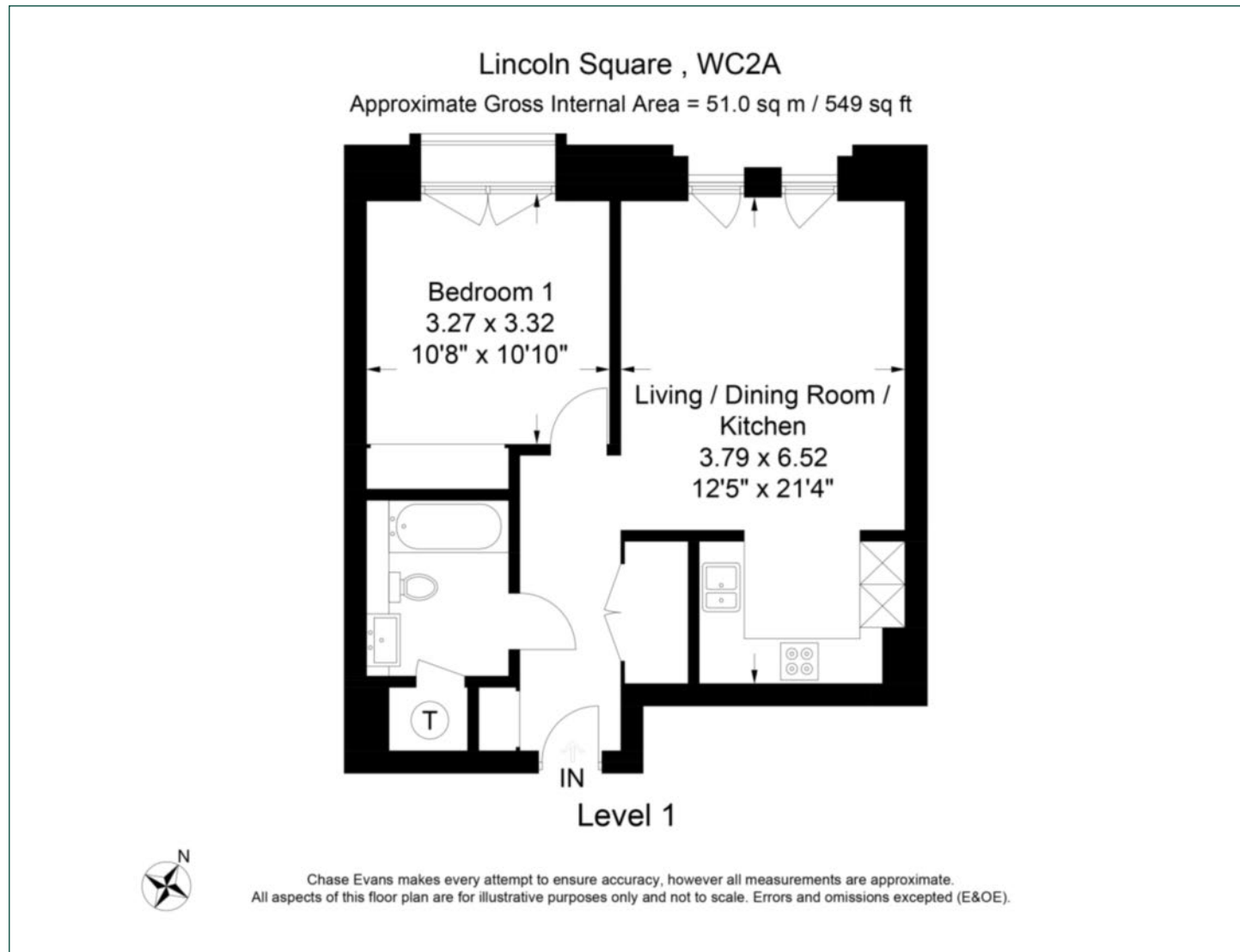

City & Aldgate

122 Whitechapel High Street, London, E1 7PT

Lettings

020 7247 3888 | city.lettings@chaseevans.com

We're here to help.

IMPORTANT NOTICE - These particulars have been prepared in good faith and they are not intended to constitute part of an offer or contract. We have not performed a structural survey on this property and the services, appliances and specific fittings have not been tested. All photographs, measurements, floor plans and distances referred to are given as a guide and should not be relied upon.

chaseevans.com

 Chase Evans