



## Lincoln Square, Portugal Street, Holborn, WC2A

Price **£950 per week** | Furnished



# Lincoln Square, Portugal Street, Holborn, WC2A



1 Bedroom



1 Bathroom



1 Reception



Gymnasium



Spa Facilities



Local Amenities



24-Hour Concierge



0.2 MI Chancery Lane

Stunning one-bedroom apartment set within this prestigious development set within the heart of Central London. This stunning property comprises a sizable living/dining area, a modern kitchen with integrated appliances, large master bedroom with fitted wardrobes, master ensuite/shower room. Excellent transport links just a short walking distance to Holborn and Chancery Lane.

along with a 24-hour uniformed concierge service. Also a further 6,000 sq ft of private landscaped garden.

Residents will enjoy an abundance of exclusive amenities, which includes a 25 metre pool with adjoining vitality pool, cinema, gym, residents lounge, private dining rooms, kids soft play area

**Local Authority:** City of Westminster London

**Council Tax Band:** F

**EPC:** B

**Security deposit:** equivalent to 5 weeks' rent

# Floorplan

578 sq ft | 54 sq m

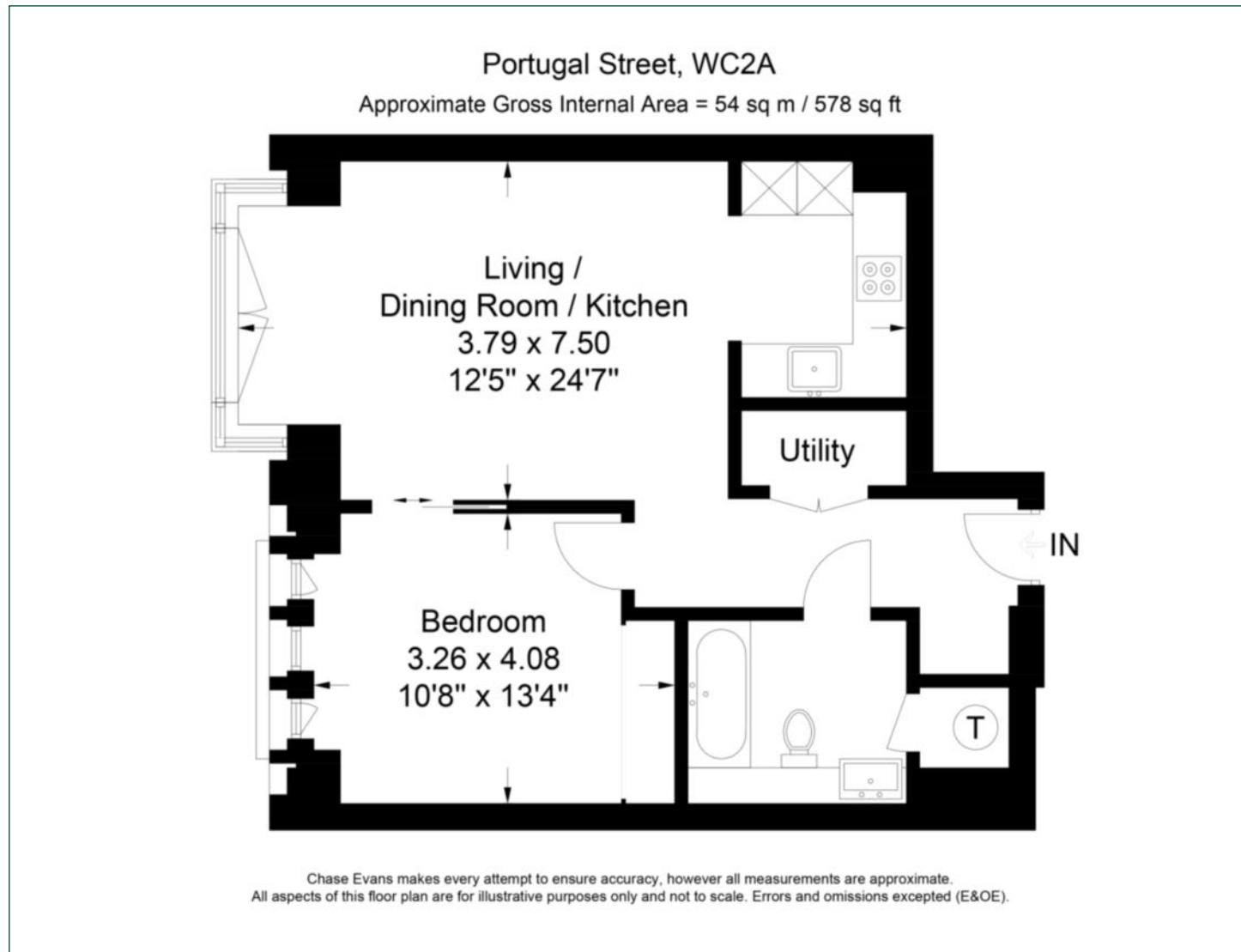

## City & Aldgate

122 Whitechapel High Street, London, E1 7PT

## Lettings

020 7247 3888 | [city.lettings@chaseevans.co.uk](mailto:city.lettings@chaseevans.co.uk)

## We're here to help.

IMPORTANT NOTICE - These particulars have been prepared in good faith and they are not intended to constitute part of an offer or contract. We have not performed a structural survey on this property and the services, appliances and specific fittings have not been tested. All photographs, measurements, floor plans and distances referred to are given as a guide and should not be relied upon.

[chaseevans.com](http://chaseevans.com)