



Forset Court, Edgware Road, W2

Price **£450 per week** | Furnished



Forset Court, Edgware Road, W2



Studio



1 Bathroom



1 Reception



24-Hour Concierge



Prime Location



Local Amenities



Near Oxford Street



Close to Hyde Park



0.3 MI Edgware Road

A fantastic studio apartment set within this beautiful, grand nine-storey 1930's mansion building on Edgware Road. This stunning and light apartment boasts a separate kitchen, a marble bathroom, designer furnishings, wood flooring, recessed lighting and a 24-hour concierge service.

The property benefits from a prime location near a huge range of local amenities - shops, restaurants and bars and is close famous locations such as Oxford Street and Hyde Park.

The development is ideally located for transport, only 7 minutes from Edgware Road Station (Circle, District, Hammersmith & City lines) and close to Marble Arch station (Central Line).

Local Authority: City of Westminster London

Council Tax Band: C

EPC: C

Security deposit: equivalent to 5 weeks' rent

Floorplan

308 sq ft | 28.61 sq m

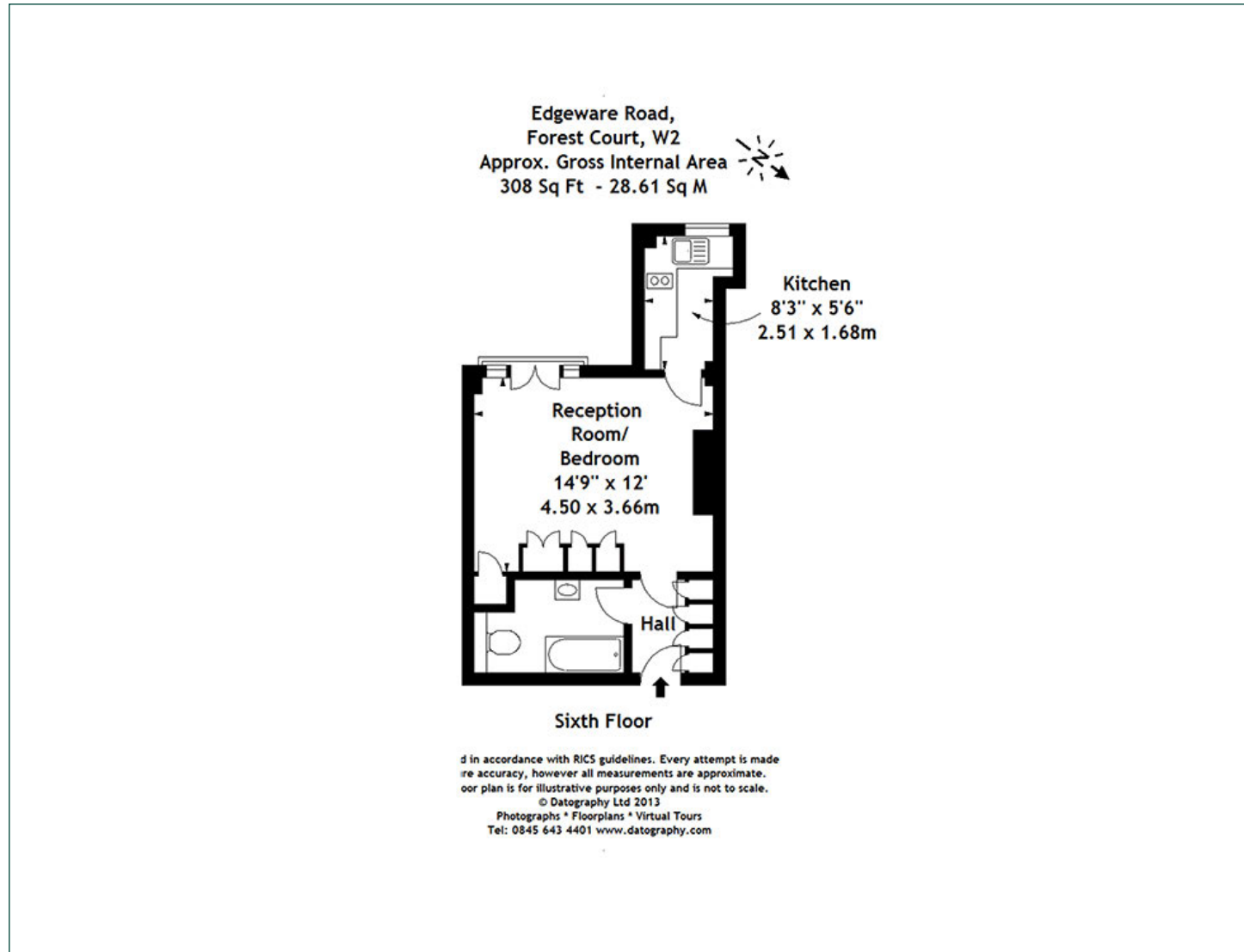

City & Aldgate

122 Whitechapel High Street, London, E1 7PT

Lettings

020 7247 3888 | city.lettings@chaseevans.com

We're here to help.

IMPORTANT NOTICE - These particulars have been prepared in good faith and they are not intended to constitute part of an offer or contract. We have not performed a structural survey on this property and the services, appliances and specific fittings have not been tested. All photographs, measurements, floor plans and distances referred to are given as a guide and should not be relied upon.

chaseevans.com