



Zest House, The Vibe, Beachwood Road, Dalston E8

Asking price **£850,000** | Leasehold



Zest House, The Vibe, Beachwood Road, Dalston E8



3 Bedrooms



2 Bathrooms



1 Reception



Balcony



Concierge



Gymnasium



Communal Roof Terrace



Close Local Amenities



0.2 MI Dalston Junction

A modern three bedroom, sixth floor property with a balcony measuring approximately 980 sq ft in this contemporary development in Dalston E8, moments from Dalston Station.

The property includes an open-plan kitchen/ living room featuring high specification handleless fitted units from Urban Myth, fully integrated SMEG appliances, glass splashback, floor-to-ceiling glazing and access to a private balcony. There are three double bedrooms (the master with an en suite and wardrobes with sliding mirrored doors) and a further family bathroom with contemporary ceramic tiling and a large vanity mirror. The property also features recessed lighting and

underfloor heating.

Residents of The Vibe have access to a 24-hour concierge service, communal rooftop garden with far reaching views of London, residents' gymnasium, bicycle storage and a secure video entry system.

The development is perfectly located with easy access to the restaurants, bars and other amenities that Kingsland Road has to offer, plus Dalston has its own theatres, cinemas, jazz venues, café bookshops, clubs and more. Swift access to Shoreditch, Islington and the City is on your doorstep with both Dalston Junction and Dalston Kingsland stations being moments away.

Tenure: Leasehold (241 years remaining)

Local Authority: Hackney London

Ground Rent: £480 p.a.

Council Tax Band: E

Service Charge: £5,290.82 p.a.

EPC: B



Floorplan

980 sq ft | 91 sq m

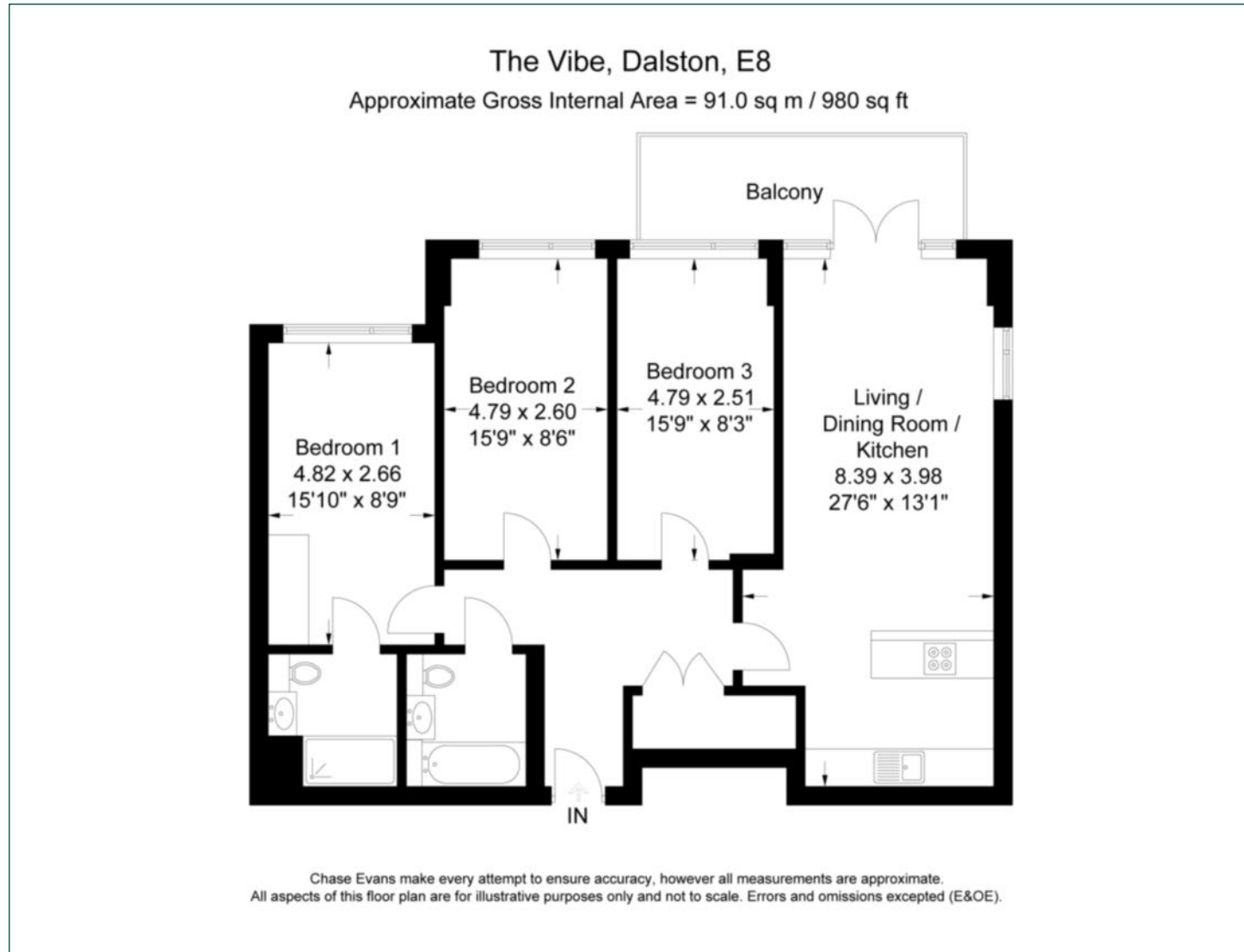

City & Aldgate

122 Whitechapel High Street, London, E1 7PT

Sales

020 7488 2777 | city.sales@chaseevans.com

We're here to help.

IMPORTANT NOTICE - These particulars have been prepared in good faith and they are not intended to constitute part of an offer or contract. We have not performed a structural survey on this property and the services, appliances and specific fittings have not been tested. All photographs, measurements, floor plans and distances referred to are given as a guide and should not be relied upon.

chaseevans.com