



## Lattice House, Alie Street, Aldgate, E1

Asking price **£475,000** | Leasehold



# Lattice House, Alie Street, Aldgate, E1



1 Bedroom



1 Bathroom



1 Reception



Great Local Amenities



0.2 MI Aldgate East

A wonderfully light one bedroom apartment within a modern development located in Aldgate.

The apartment includes an inviting open plan living space with a fully integrated fitted kitchen, wood flooring, large glazing, high ceilings, a good sized bedroom with built in storage and a contemporary bathroom, recessed lighting throughout.

There are several amenities located nearby including restaurants, bars, cafés shops and cultural attractions including the Whitechapel Gallery.

The development is located close to several transport links including Aldgate East Underground station, ideal for commutes along Circle and District lines.

**Tenure:** Leasehold (988 years remaining) **Local Authority:** Tower Hamlets

**Ground Rent:** £250 p.a. **Council Tax Band:** E

**Service Charge:** £2,912.45 p.a. **EPC:** C

# Floorplan

541 sq ft | 50.26 sq m

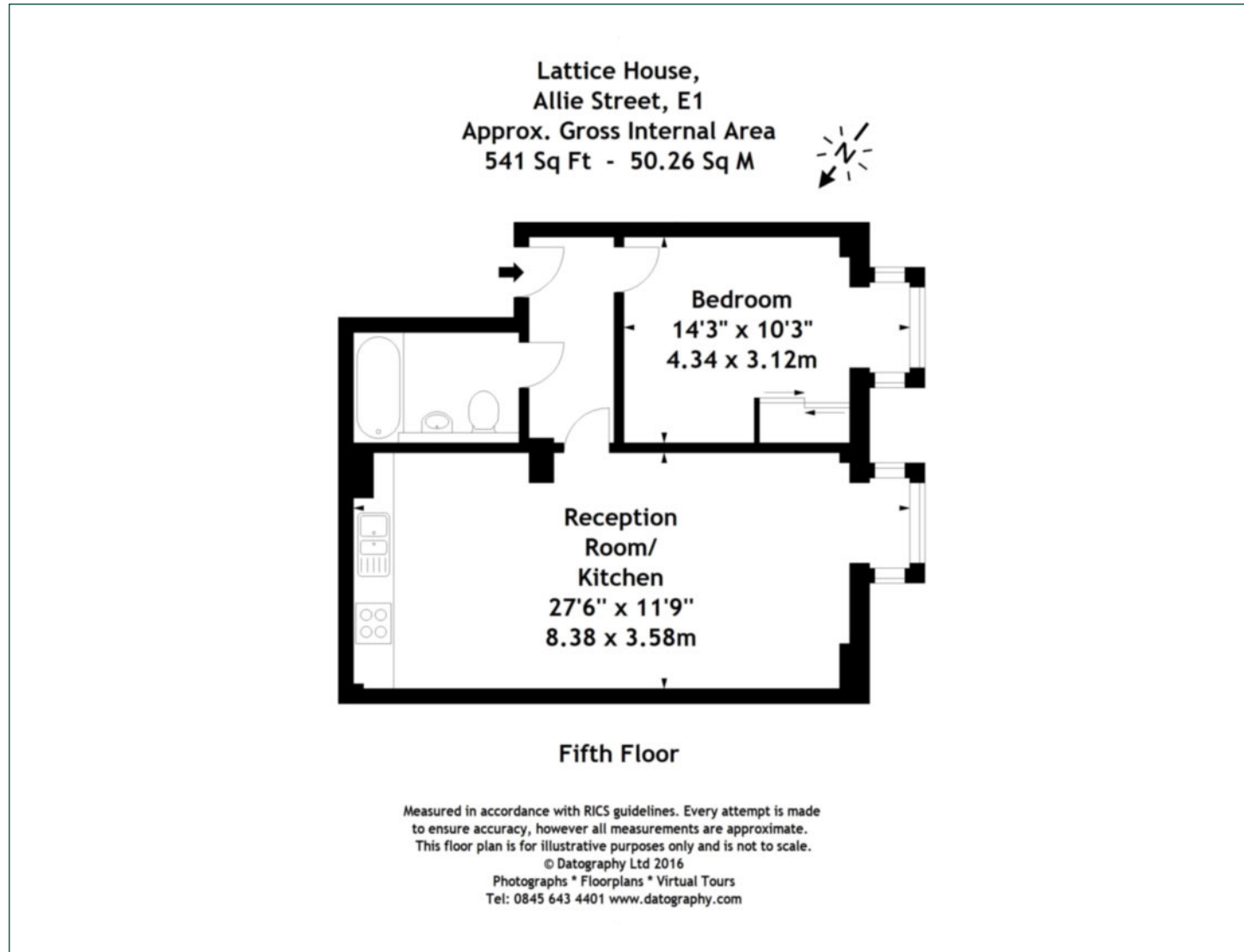

## City & Aldgate

122 Whitechapel High Street, London, E1 7PT

## Sales

020 7488 2777 | [city.sales@chaseevans.co.uk](mailto:city.sales@chaseevans.co.uk)

## We're here to help.

IMPORTANT NOTICE - These particulars have been prepared in good faith and they are not intended to constitute part of an offer or contract. We have not performed a structural survey on this property and the services, appliances and specific fittings have not been tested. All photographs, measurements, floor plans and distances referred to are given as a guide and should not be relied upon.

[chaseevans.com](http://chaseevans.com)