











Alington House, Mary Neuner Road, Wood Green, N8

Asking price **£430,000** | Leasehold



Alington House, Mary Neuner Road, Wood Green, N8

-  1 Bedroom
-  1 Bathroom
-  1 Reception
-  Balcony
-  Gymnasium
-  Swimming Pool
-  Local Amenities
-  24-Hour Concierge
-  0.3 MI Wood Green

Modern one bedroom apartment set on the 12th floor within Alington House, apart of Clarendon, a large regeneration project set in Wood Green, N8. This furnished apartment comprises a spacious open-plan living/dining area, stylish fitted kitchen with integrated appliances, wood flooring, sizable bedroom with fitted wardrobes & contemporary bathroom suite with stylish fittings and a private balcony with views over the communal gardens.

The new Hornsey Park will be the centrepiece to Clarendon and will include orchard style planting, striking water feature and a café. Superb residents

facilities will include a 24-hour concierge, residents lounge, swimming pool, spa and gymnasium.

Residents will enjoy exclusive use of a spacious south/west facing podium garden, whilst being adjacent to the western end of Hornsey Park with its beautiful trees and water feature. Clarendon is ideally located to explore the local area and beyond. A short stroll through the park leads up to Wood Green's high street, and the nearest train and tube stations are just a short walk away

Tenure: Leasehold (996 years remaining) **Local Authority:** Haringey

Ground Rent: £380 **Council Tax Band:** C

Service Charge: £2,904.22 **EPC:** B

Floorplan

589 sq ft | 54.7 sq m

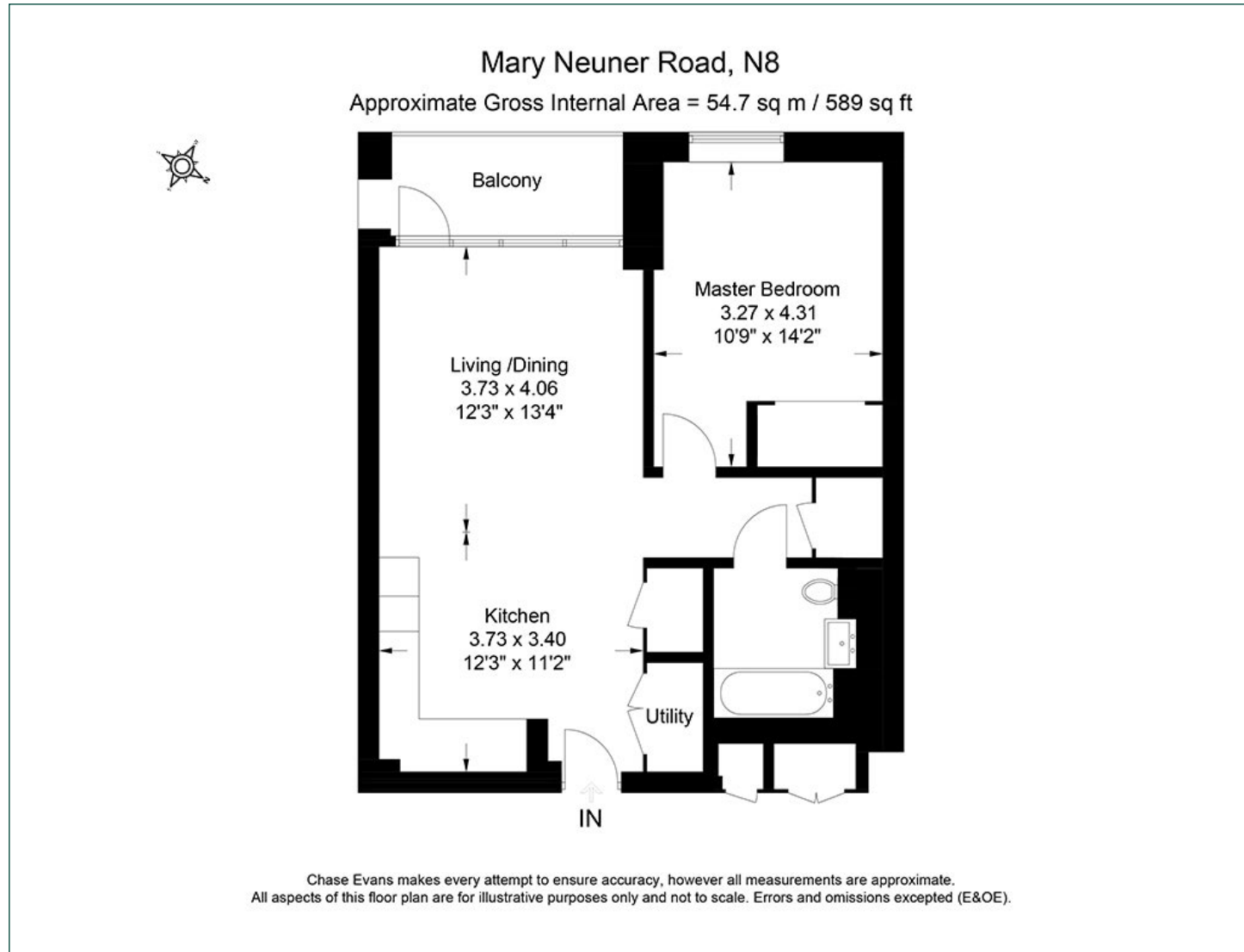

City & Aldgate

122 Whitechapel High Street, London, E1 7PT

Sales

020 7488 2777 | city.lettings@chaseevans.co.uk

We're here to help.

IMPORTANT NOTICE - These particulars have been prepared in good faith and they are not intended to constitute part of an offer or contract. We have not performed a structural survey on this property and the services, appliances and specific fittings have not been tested. All photographs, measurements, floor plans and distances referred to are given as a guide and should not be relied upon.

[chaseevans.com](https://www.chaseevans.com)

 Chase Evans