



Windsor Close, West Heath, Birmingham, B31 4SY

£245,000

3 1 1



- Semi-Detached
- Three Bedrooms
- Garage
- Lounge/Diner
- Kitchen/Diner
- Family Bathroom
- Front And Rear Garden
- Excellent Location



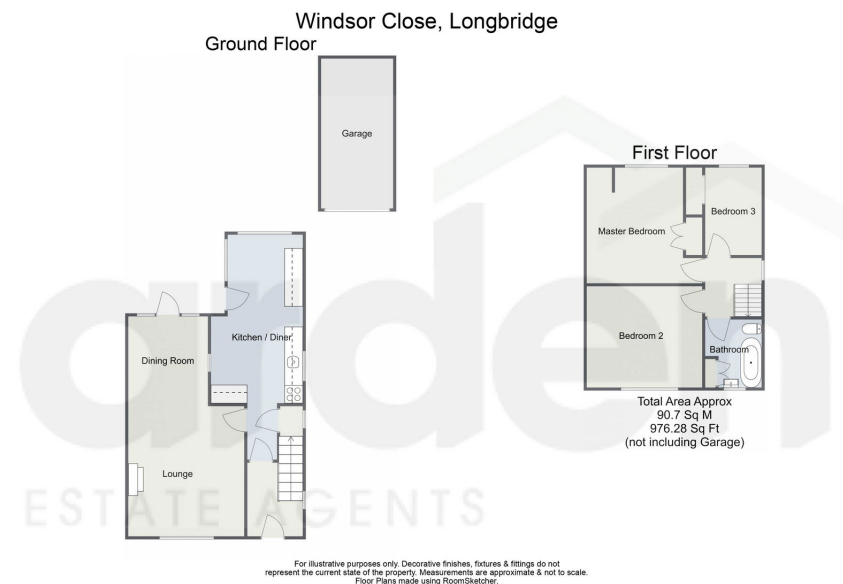

NO CHAIN

A well-presented three-bedroom semi-detached home located in the sought-after area of Longbridge. This property features off-road parking, a garage, an open-plan lounge and dining area, a spacious kitchen with room for dining, a family bathroom, and a beautifully maintained rear garden. Tucked away in a quiet cul-de-sac, the home offers a peaceful setting ideal for families or anyone seeking a tranquil location.

58/25, 10:21 AM

Energy performance certificate (EPC) - Find an energy certificate - GOV.UK

Energy performance certificate (EPC)		
3 Windsor Close BIRMINGHAM B11 4ST	Energy rating D	Valid until: 30 April 2025 Certificate number: 2914-6005-6002-6005-7206
Property type	Semi-detached house	
Total floor area	91 square metres	

Rules on letting this property

Properties can be let if they have an energy rating from A to E.

You can read [guidance for landlords on the regulations and exemptions](https://www.gov.uk/guidance/domestic-private-rental-property-minimum-energy-efficiency-standard-landlord-guidance) <https://www.gov.uk/guidance/domestic-private-rental-property-minimum-energy-efficiency-standard-landlord-guidance>.

Energy rating and score

This property's energy rating is D. It has the potential to be B.

[See how to improve this property's energy efficiency.](#)

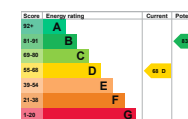

The graph shows this property's current and potential energy rating.

Properties get a rating from A (best) to G (worst) and a score. The better the rating and score, the lower your energy bills are likely to be.

For properties in England and Wales:
the average energy rating is D
the average energy score is 60

<https://find-energy-certificate.service.gov.uk/energy-certificate/2914-6005-6002-6005-7206/print/true>

1/4

For more information on this house or to arrange a viewing please call the office on:

0121 453 4349

Alternatively, you can scan the QR to view all of the details of this property online.

