



Longbridge Lane, Longbridge, Birmingham, B31 4JX

£375,000

3 1 2



- Detached
- Driveway
- Two Reception Rooms
- Conservatory
- Family Bathroom
- Garage
- Three Bedrooms
- Kitchen
- Entrance Hall
- Front And Rear Garden



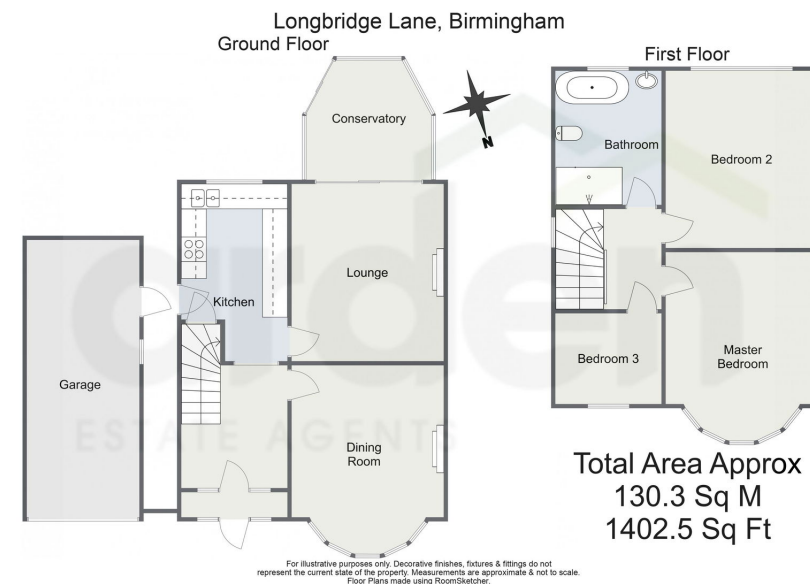

A well-presented detached three-bedroom home ideally situated in a popular Longbridge location. This property benefits from off-road parking, a garage and neatly maintained front and rear gardens with mature plants. Inside, the spacious layout includes an inviting entrance hall, a separate dining room, a comfortable lounge, a bright conservatory, a well-equipped kitchen, and a modern family bathroom—perfect for families or those looking for generous living space in a convenient setting.

4/17/2023, 5:01 PM

Energy performance certificate (EPC) - Find an energy certificate - GOV.UK

Energy performance certificate (EPC)

186 Longbridge Lane BIRMINGHAM B15 4LX	Energy rating E	Valid until 16 April 2033
Property type Detached house		Certificate number 0948-1207-7328-3342-0004
Total floor area 107 square metres		

Rules on letting this property

Properties can be let if they have an energy rating from A to E.

You can read [guidance for landlords on the regulations and exemptions](https://www.gov.uk/guidance/domestic-private-rental-property-minimum-energy-efficiency-standard-landlord-guidance) <https://www.gov.uk/guidance/domestic-private-rental-property-minimum-energy-efficiency-standard-landlord-guidance>.

Energy rating and score

This property's energy rating is E. It has the potential to be B.

[See how to improve this property's energy efficiency.](#)



The graph shows this property's current and potential energy rating.

Properties get a rating from A (best) to G (worst) and a score. The better the rating and score, the lower your energy bills are likely to be.

For properties in England and Wales:
the average energy rating is D
the average energy score is 60

<https://find-energy-certificate.service.gov.uk/energy-certificate/0948-1207-7328-3342-0004/print/print>

1/4

For more information on this house or to arrange a viewing please call the office on:

0121 453 4349

Alternatively, you can scan the QR to view all of the details of this property online.



arden
ESTATE AGENTS