





Pinewood Drive, Bartley Green, Birmingham, B32 4LS

Offers Over £225,000

 3  1  1



- NO CHAIN
- Three Bedrooms
- Lounge / Diner
- Kitchen
- Family Bathroom
- Off Road Parking
- Rear Garden
- Garage
- Entrance Hall
- Close to Amenities & Public Transport





Pinewood Drive, Birmingham
Ground Floor

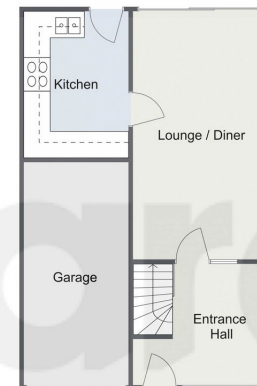

First Floor



Total Area Approx
88.0 Sq M
947.22 Sq Ft

For illustrative purposes only. Decorative finishes, fixtures & fittings do not represent the current state of the property. Measurements are approximate & not to scale. Floor Plans made using RoomSketcher.

NO CHAIN - FREEHOLD UPON COMPLETION

Welcome to this charming 3-bedroom mid-terraced home located on Pinewood Drive, Bartley Green. Featuring a block-paved driveway and a garage, this property offers a spacious lounge/diner, a well-equipped kitchen, a family bathroom, and a neat rear garden.

4/8/25, 4:27 PM

Energy performance certificate (EPC) - Find an energy certificate - GOV.UK

Energy performance certificate (EPC)		
234 Pinewood Drive BIRMINGHAM B15 4L3	Energy rating C	Valid until 7 April 2028
Property type Mid-terrace house	Certificate number 2112-1416-1213-2804-2859	
Total floor area	76 square metres	

Rules on letting this property

Properties can be let if they have an energy rating from A to E.

You can read [guidance for landlords on the regulations and exemptions](https://www.gov.uk/guidance/domestic-private-rental-property-minimum-energy-efficiency-standard-landlord-guidance) <https://www.gov.uk/guidance/domestic-private-rental-property-minimum-energy-efficiency-standard-landlord-guidance>.

Energy rating and score

This property's energy rating is C. It has the potential to be B.

[See how to improve this property's energy efficiency.](#)

The graph shows this property's current and potential energy rating.

Properties get a rating from A (best) to G (worst) and a score. The better the rating and score, the lower your energy bills are likely to be.

For properties in England and Wales:

the average energy rating is D
the average energy score is 60

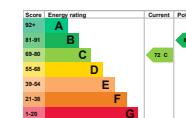

<https://find-energy-certificate.service.gov.uk/energy-certificate/2112-1416-1213-2804-2859?intro=true>

1/4

For more information on this house or to arrange a viewing please call the office on:

0121 453 4349

Alternatively, you can scan the QR to view all of the details of this property online.

