



Orchard Drive, Longbridge, Birmingham, B31 4QZ

£295,000

2 1 1



- No Upward chain
- Two Bedrooms
- Off Road Parking
- Lounge With Bay Window
- Family Bathroom
- Link Detached Bungalow
- Garage
- Front And Rear Garden
- Kitchen
- Wc





NO CHAIN

Nestled in the desirable location of Orchard Drive, Longbridge, this chain-free, link-detached bungalow offers a rare opportunity. Featuring both front and rear gardens, a garage and off-road parking, the property blends convenience with comfort. Inside, you'll find two bedrooms, a WC, a family bathroom, a kitchen, a spacious lounge and a lean-to for added convenience.

Orchard Drive, Birmingham
Ground Floor

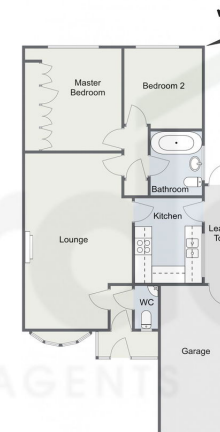

Total Area Approx
78.2 Sq M
841.7 Sq Ft

For illustrative purposes only. Decorative finishes, fixtures & fittings do not represent the current state of the property. Measurements are approximate & not to scale. Floor Plans made using RoomSketcher.

4/2/25, 1:24 PM

Energy performance certificate (EPC) - Find an energy certificate - GOV.UK

Energy performance certificate (EPC)		
14 Orchard Drive BIRMINGHAM B15 4QZ	Energy rating D	Valid until: 3 April 2028 Certificate number: 2170-6244-0050-2059-4701
Property type: Detached bungalow		
Total floor area: 63 square metres		
Rules on letting this property		
Properties can be let if they have an energy rating from A to E.		
You can read guidance for landlords on the regulations and exemptions https://www.gov.uk/guidance/domestic-private-rental-property-minimum-energy-efficiency-standards-guidance		
Energy rating and score		
This property's energy rating is D. It has the potential to be B.		
See how to improve this property's energy efficiency .		
<p>The graph shows this property's current and potential energy rating.</p> <p>Properties get a rating from A (best) to G (worst) and a score. The better the rating and score, the lower your energy bills are likely to be.</p> <p>For properties in England and Wales: the average energy rating is D the average energy score is 60</p>		

<https://find-energy-certificate.service.gov.uk/energy-certificate/2170-6244-0050-2059-4701?print=true>

1/4

For more information on this house or to arrange a viewing please call the office on:

0121 453 4349

Alternatively, you can scan the QR to view all of the details of this property online.



arden
ESTATE AGENTS