



Harborne Park Road, Harborne, Birmingham, B17 0PS

Offers Over £275,000

🛏 2 🍳 1 🛋 2



- NO CHAIN
- Two Double Size Bedrooms
- Lounge
- Dining Room
- Kitchen
- Utility
- Family Bathroom
- Large Rear Garden
- Sought After Location
- Close To QE Hospital





NO CHAIN

This beautifully presented two-bedroom terraced home boasts a generous lounge, dining room, kitchen, utility room, and bathroom, along with a lovely rear garden. Situated on Harborne Park Road, this property is in a highly desirable area, offering excellent transport links, proximity to QE Hospital, local schools, and nearby shops on Harborne High Street.

Harbourne Park Road, Harbourne, Birmingham
Ground Floor

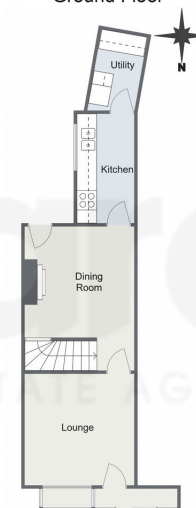

First Floor



Total Area Approx
69.1 Sq M
743.8 Sq Ft

For illustrative purposes only. Decorative finishes, fixtures & fittings do not represent the current state of the property. Measurements are approximate & not to scale. Floor Plans made using RoomSketcher.

3/28/25, 9:24 AM

Energy performance certificate (EPC) - Find an energy certificate - GOV.UK

Energy performance certificate (EPC)			
499 Harborne Park Road BIRMINGHAM B15 9PS	Energy rating C	Valid until:	28 March 2035
		Certificate number:	0274-1207-3105-0135-0794
Property type		Mid-terrace house	
Total floor area		69 square metres	

Rules on letting this property

Properties can be let if they have an energy rating from A to E.

You can read [guidance for landlords on the regulations and exemptions](https://www.gov.uk/guidance/domestic-private-rental-property-minimum-energy-efficiency-standard-landlord-guidance) <https://www.gov.uk/guidance/domestic-private-rental-property-minimum-energy-efficiency-standard-landlord-guidance>.

Energy rating and score

This property's energy rating is C. It has the potential to be B.

[See how to improve this property's energy efficiency.](#)



The graph shows this property's current and potential energy rating.

Properties get a rating from A (best) to G (worst) and a score. The better the rating and score, the lower your energy bills are likely to be.

For properties in England and Wales:
the average energy rating is D
the average energy score is 60

<https://find-energy-certificate.service.gov.uk/energy-certificate/0274-1207-3105-0135-0794/print#flow>

1/4

For more information on this house or to arrange a viewing please call the office on:

0121 453 4349

Alternatively, you can scan the QR to view all of the details of this property online.



arden
ESTATE AGENTS