



Titania Close, Rednal, Birmingham, B45 0EE

£200,000

3 1 1



- Semi-Detached
- Three Bedrooms
- Kitchen/Diner
- Downstairs WC
- Rear Garden
- Off Road Parking
- Converted Garage
- Lounge
- Family Bathroom
- Close To Amenities





Titania Close, Rednal
Ground Floor

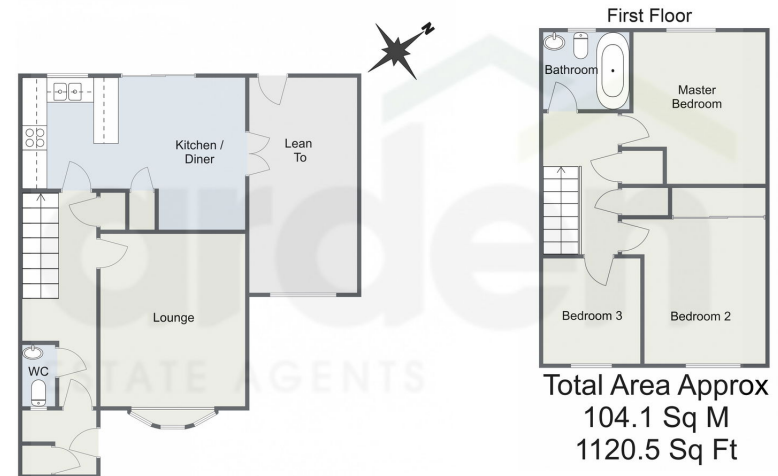

For illustrative purposes only. Decorative finishes, fixtures & fittings do not represent the current state of the property. Measurements are approximate & not to scale. Floor Plans made using RoomSketcher.

Introducing this charming three-bedroom semi-detached property, complete with off-road parking via a block-paved driveway. Inside, you'll find a spacious kitchen diner, a lounge, a convenient downstairs WC, for added convenience, the property features a converted garage, offering extra space for various needs and a well-appointed family bathroom. The property also boasts a flat rear garden, perfect for outdoor enjoyment.

3/20/25, 11:34 AM

Energy performance certificate (EPC) - Find an energy certificate - GOV.UK

Energy performance certificate (EPC)		
33 Titania Close Rednal Bristol BS40 4JG	Energy rating C	Valid until: 18 March 2035 Certificate number: 2129-0718-0842-4194-1151
Property type	End-terrace house	
Total floor area	87 square metres	

Rules on letting this property

Properties can be let if they have an energy rating from A to E.

You can read [guidance for landlords on the regulations and exemptions](https://www.gov.uk/guidance/domestic-private-rented-property-minimum-energy-efficiency-standard-landlord-guidance) <https://www.gov.uk/guidance/domestic-private-rented-property-minimum-energy-efficiency-standard-landlord-guidance>

Energy rating and score

This property's energy rating is C. It has the potential to be B.

[See how to improve this property's energy efficiency.](#)

The graph shows this property's current and potential energy rating.

Properties get a rating from A (best) to G (worst) and a score. The better the rating and score, the lower your energy bills are likely to be.

For properties in England and Wales:

the average energy rating is D
the average energy score is 60

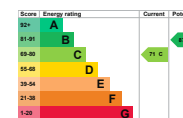

<https://find-energy-certificate.service.gov.uk/energy-certificates/2129-0718-0842-4194-1151?print=true>

1/4

For more information on this house or to arrange a viewing please call the office on:

0121 453 4349

Alternatively, you can scan the QR to view all of the details of this property online.



arden
ESTATE AGENTS