



63 New House Farm Drive, Northfield

£390,000

🛏 3 🚿 2 🛋 1



- Three Bedrooms
- Downstairs WC
- Ensuite to Master Bedroom
- Off Road Parking with Garage
- Spacious Open Plan Lounge/ Kitchen/Diner
- Family Bathroom
- Rear Garden
- Close to Amenities



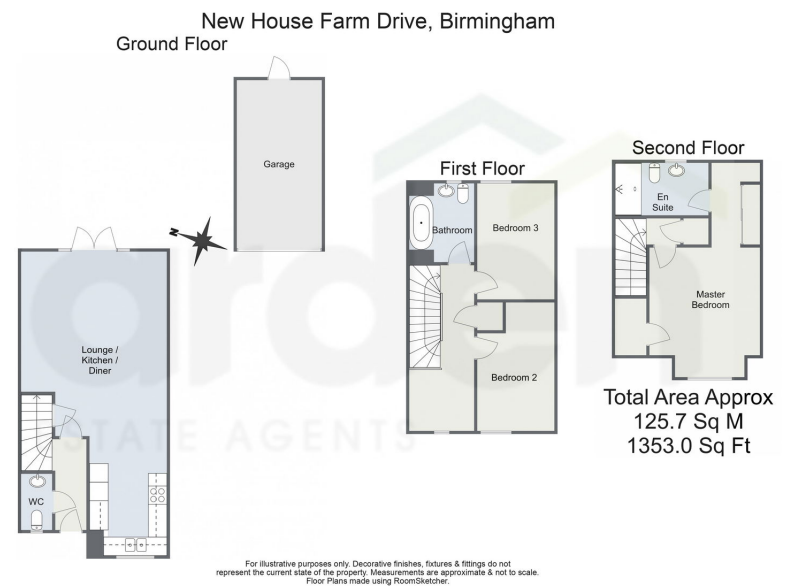

A well presented three-bedroom townhouse located in the desirable area of Northfield. This home boasts an open-plan ground floor with a modern kitchen equipped with integrated appliances, a master bedroom with an ensuite and built-in wardrobes, downstairs wc, off road parking with a garage and a charming rear garden.

For more information on this house or to arrange a viewing please call the office on:

0121 453 4349

Alternatively, you can scan the QR to view all of the details of this property online.

