



Redditch Road, Stoke Heath, Bromsgrove, B60 4JN

£240,000

🛏️ 2 🚿 1 🚗 1



A beautifully presented two bedroom mid-terraced cottage, situated in the popular area of Stoke Heath, Bromsgrove. Dating back to the 1800s, this charming residence is offered with a cosy lounge, kitchen, front, rear and 'secret' gardens and off road parking with a garage.

A gated front garden with trees and shrubs greets guests as they approach the quaint home. A pathway leads to decking that's ideal for morning coffee, and the front door.

Step inside and a doorway leads directly into cosy lounge with feature fireplace and built in cupboards. A further door opens up into the kitchen with integrated oven, gas hob and extractor. Towards the rear of the home is a bathroom with shower over bath, and stairs to first floor landing radiating off to master bedroom and bedroom two.

Outside, the property enjoys a rear paved courtyard with lighting and pull out awning, and at the end of the driveway is an entrance to a landscaped 'secret' garden, being mainly laid to lawn with a good sized summerhouse/studio with electrics and fenced boundaries.

This property is situated in the well-established and sought after location of Stoke Heath, ideally positioned within south Bromsgrove excellent school catchment and Bromsgrove's surrounding amenities.

#### Room Dimensions:

**Lounge** - 3.65m x 3.6m (11'11" x 11'9") max

**Kitchen** - 1.85m x 3.65m (6'0" x 11'11")

**Bathroom** - 2.01m x 1.99m (6'7" x 6'6")

#### Stairs To First Floor

**Master Bedroom** - 3.6m x 3.63m (11'9" x 11'10") max

**Bedroom 2** - 2.65m x 1.81m (8'8" x 5'11")

**Garage** - 5.1m x 2.34m (16'8" x 7'8")



Redditch Road, Bromsgrove

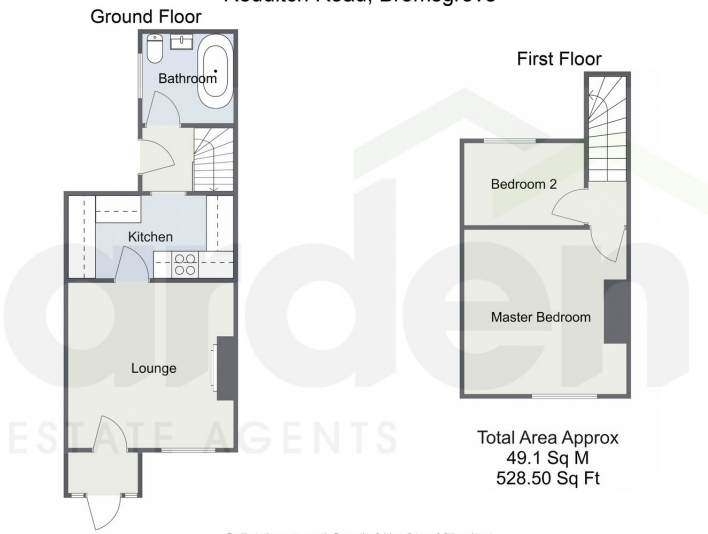

For illustrative purposes only. Decorative finishes, fixtures & fittings do not represent the current state of the property. Measurements are approximate & not to scale. Floor Plans made using RoomSketcher.

- Two Bedrooms
- Bathroom
- Cosy Lounge
- Kitchen
- Front, Rear and Secret Gardens with a Summerhouse
- Off Road Parking and Garage
- Sought After Location of Stoke Heath
- Desirable Schooling
- Close Proximity to Local Shops, Amenities and Restaurants
- Nearby M42 and M5 Motorway Links



English | [Contact](#)

### Energy performance certificate (EPC)

20: Redditch Road Stoke Heath BROMSGROVE B61 4AH	Energy rating <b>D</b>	Valid until 02 June 2028
Property type Mid-terrace house		Certificate number 1886-8440-6276-0268-1014
Total floor area 47 square metres		

**Rules on letting this property**

Properties can be let if they have an energy rating from A to E.

You can read [guidance for landlords on the regulations and compliance](#) (https://www.gov.uk/government/guidance/energy-performance-certificate-requirements-landlords)

**Energy rating and score**

The property's energy rating is D. It has the potential to be B.

[Click here to improve this property's energy efficiency](#)

Score	Energy rating	Current	Potential
92+	A		
81-91	B		90 B
69-80	C		
55-68	D	68 D	
39-54	E		
21-38	F		
1-20	G		

The graph shows the property's current and potential energy rating.

Properties get a rating from A (Best) to G (worst) and a score. The better the rating and score, the lower your energy bills are likely to be.

For properties in England and Wales:

- the average energy rating is D
- the average energy score is 60

**Breakdown of property's energy performance**

For more information on this house or to arrange a viewing please call the office on:  
**01905 958 290**

Alternatively, you can scan the QR to view all of the details of this property online.

