



James Chiltern
Estate Agents



14 Boston Road, Croydon, CR0 3ED

Offers In The Region Of £375,000

- END OF TERRACE VICTORIAN HOUSE
- TWO DOUBLE BEDROOMS
- IDEAL FAMILY HOME
- SPACIOUS ACCOMODATION THROUGHOUT
- SPACIOUS FITTED KITCHEN
- CLOSE TO CROYDON TOWN CENTRE AND TRANSPORT LINKS
- TWO RECEPTION ROOMS
- LARGE REAR OUTBUILDING

182 London Road, Croydon, Surrey, CR0 2TE
0208 681 8133

lettings@jameschiltern.com
www.jameschiltern.com

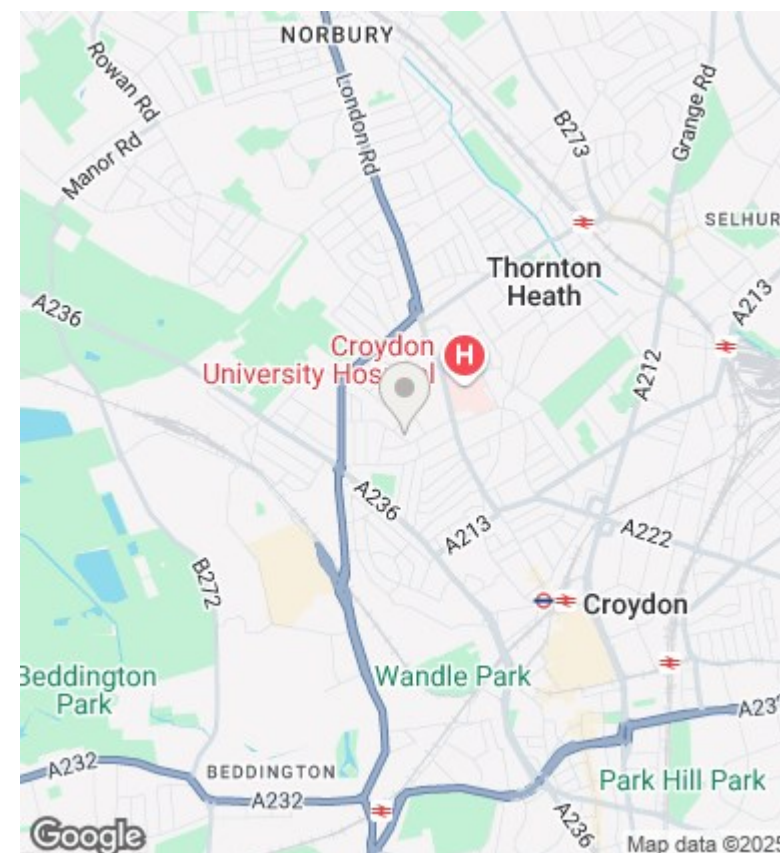
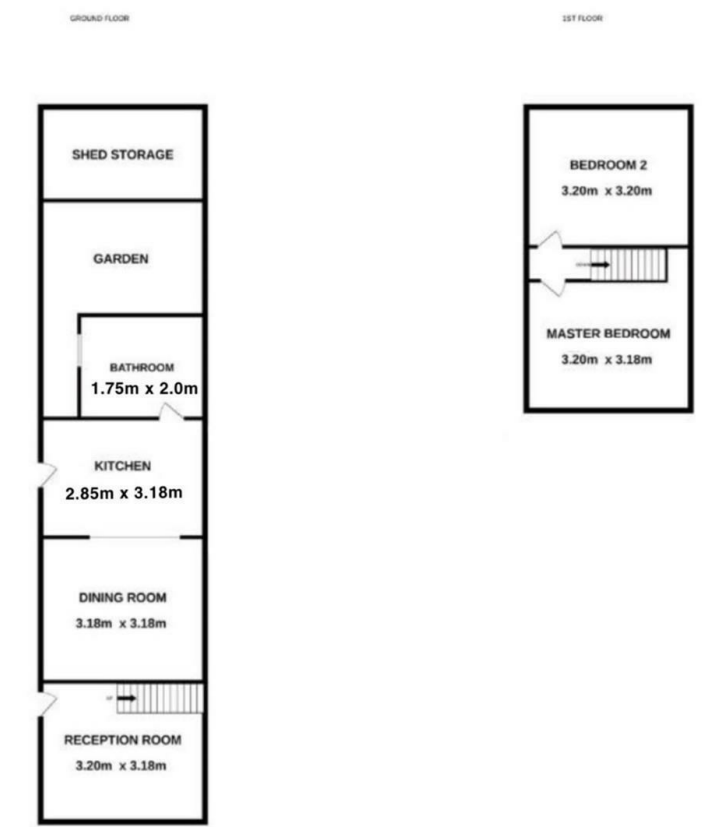

Directions

Viewings

Viewings by arrangement only. Call 0208 681 8133 to make an appointment.

Council Tax Band

C

EPC Rating:

D

