

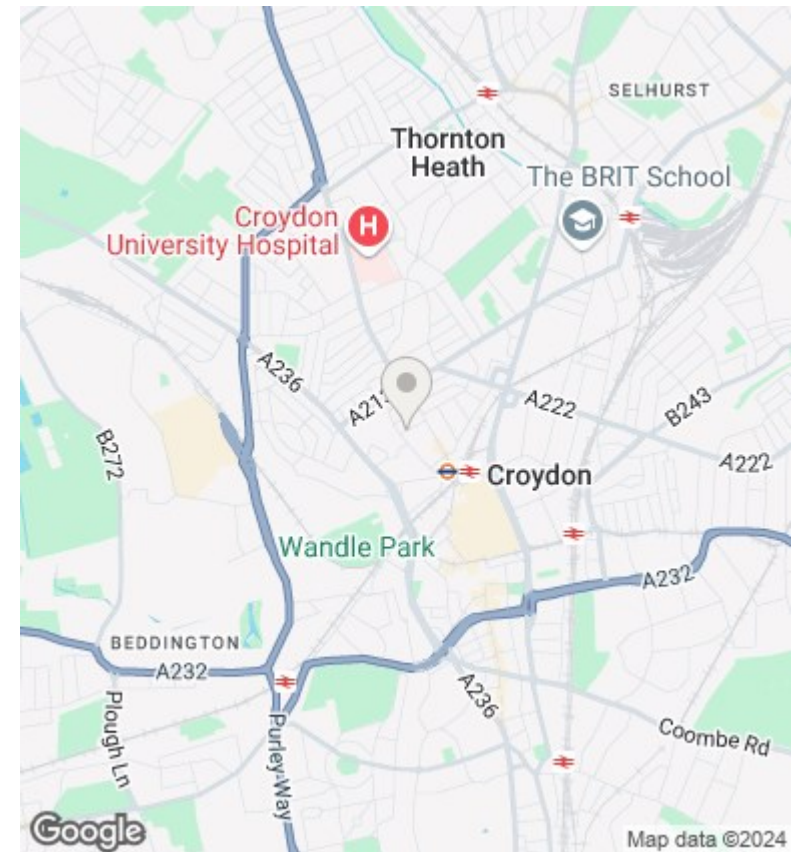

20 Montague Road, Croydon, CR0 3SS

Offers In Excess Of £400,000

- END OF TERRACE VICTORIAN HOUSE
- TWO BATHROOMS
- IMMACULATE CONDITION THROUGHOUT
- CLOSE TO CROYDON TOWN CENTRE AND TRANSPORT LINKS
- LARGE THRU-LOUNGE
- HUGE MODERN FITTED KITCHEN
- SPACIOUS ACCOMODATION
- TWO DOUBLE BEDROOMS
- LARGE WELL MAINTAINED REAR GARDEN
- IDEAL FAMILY HOME

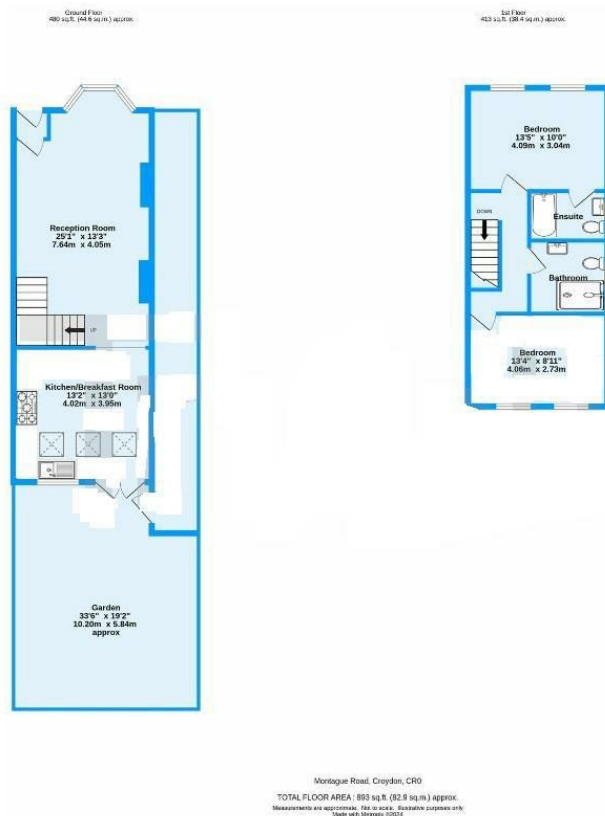

Directions

Viewings

Viewings by arrangement only. Call 0208 681 8133 to make an appointment.

Council Tax Band

C

EPC Rating:

D

| Energy Efficiency Rating | | |
|--|----------------------------|-----------|
| | Current | Potential |
| <i>Very energy efficient - lower running costs</i> | | |
| (92 plus) A | | |
| (81-91) B | | 82 |
| (69-80) C | | |
| (55-68) D | 64 | |
| (39-54) E | | |
| (21-38) F | | |
| (1-20) G | | |
| <i>Not energy efficient - higher running costs</i> | | |
| England & Wales | EU Directive 2002/91/EC | |