

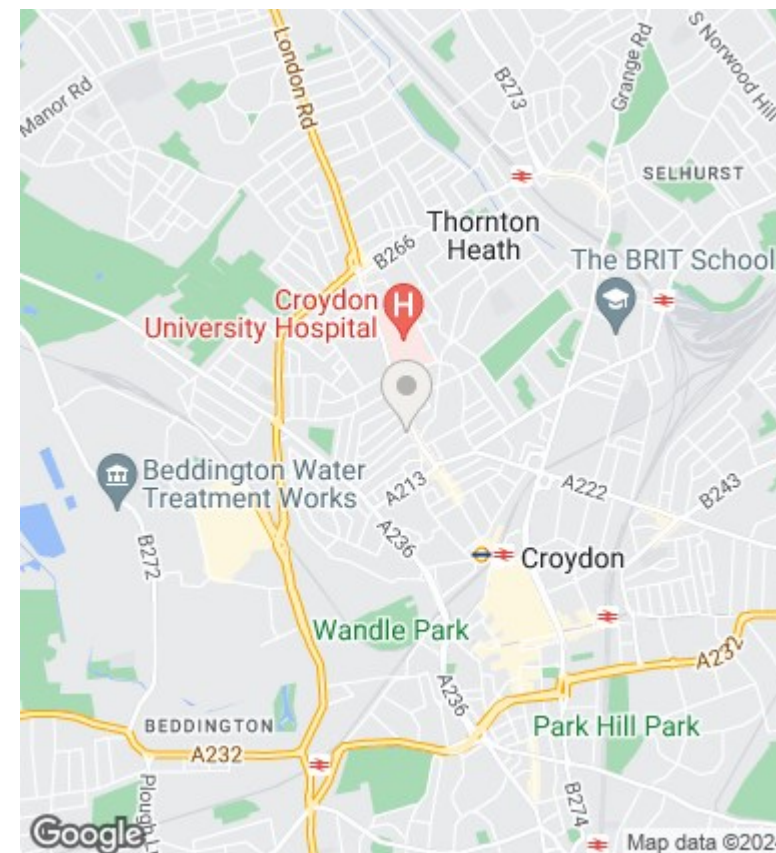

## Flat 18, 386 London Road, Croydon, CR0 2SU

Asking Price £200,000

- One double Bedroom
- Great location
- Lift Access
- Modern build
- Close to Excellent Amenities
- Integrated Kitchen
- Open plan kitchen/lounge
- Walking Distance To Croydon Town Centre

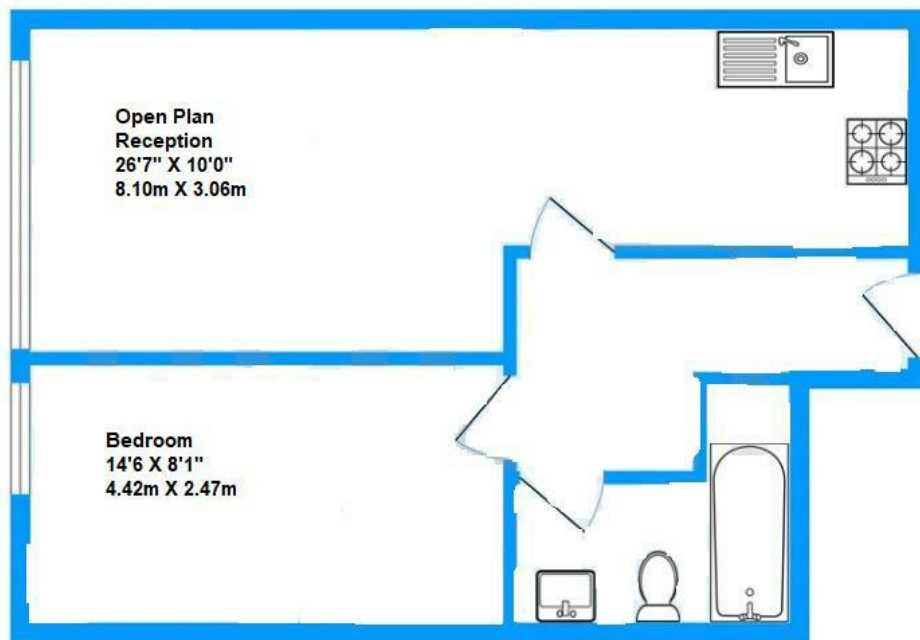

### Directions

### Viewings

Viewings by arrangement only. Call 0208 681 8133 to make an appointment.

### Council Tax Band

C

### EPC Rating:

B

Energy Efficiency Rating		Current	Potential
<i>Very energy efficient - lower running costs</i>			
(92 plus) <b>A</b>			
(81-91) <b>B</b>		86	87
(69-80) <b>C</b>			
(55-68) <b>D</b>			
(39-54) <b>E</b>			
(21-38) <b>F</b>			
(1-20) <b>G</b>			
<i>Not energy efficient - higher running costs</i>			
<b>England &amp; Wales</b>		EU Directive 2002/91/EC	