

HUNTERS[®]

HERE TO GET *you* THERE



Hamilton Crescent

Newcastle upon Tyne, NE4 5EH

£625 Per Calendar Month



Hunters are pleased to offer to the rental market this well-presented 1 bedroom apartment, on a furnished basis.

The property comprises of an entrance hallway, spacious lounge/dining area featuring a fireplace, kitchen, one bedroom and a bathroom, benefiting from double glazing and gas central heating. The front features a paved front garden and a town garden towards the rear.

Hamilton Crescent is located within a close proximity to Newcastle City Centre, with easy access to local amenities and transport links.

Price - £625 pcm
Deposit - £625
Minimum Tenancy Length - 12 months
Council Tax Band - A
EPC - C



Kitchen 7'3" x 9'5" (2.21 x 2.87)
Glazed panel to lounge. Floor and wall units. Combination boiler. Store cupboard.

Lounge 10'4" x 16'6" (3.15 x 5.03)
Double glazed window to front. Feature fireplace place (electric). Laminate flooring. TV point. Telephone point.

-
..

Area Map



Floor Plans

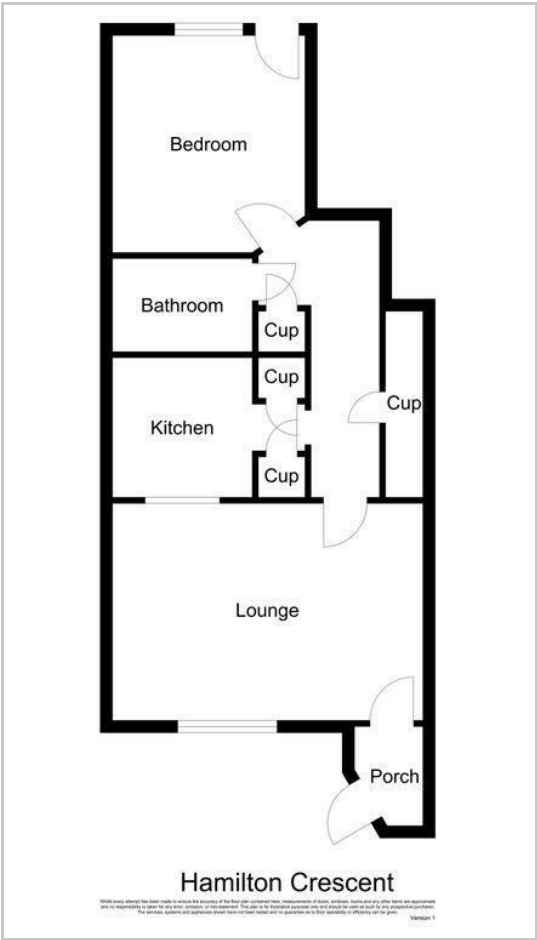

Energy Efficiency Graph

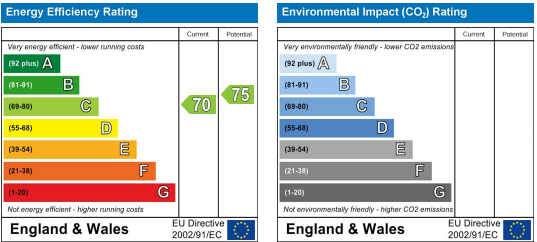

These particulars are intended to give a fair and reliable description of the property but no responsibility for any inaccuracy or error can be accepted and do not constitute an offer or contract. We have not tested any services or appliances (including central heating if fitted) referred to in these particulars and the purchasers are advised to satisfy themselves as to the working order and condition. If a property is unoccupied at any time there may be reconnection charges for any switched off/disconnected or drained services or appliances - All measurements are approximate. **THINKING OF SELLING?** If you are thinking of selling your home or just curious to discover the value of your property, Hunters would be pleased to provide free, no obligation sales and marketing advice. Even if your home is outside the area covered by our local offices we can arrange a Market Appraisal through our national network of Hunters estate agents.