



Websters
estate agents

Rivermeads Avenue, Twickenham, TW2 5JL

Semi Detached 3 bedroom family home with a front garden and side access to the south facing rear garden. Situated in a desirable Twickenham residential location just 0.6 miles from Heathfield Primary and 0.8 miles from Turing House and Waldegrave Girls School/Co-ed Sixth Form.

Tastefully presented to offer 1145 sq ft of living space over 2 floors with double glazed windows and doors, tasteful neutral decor throughout and potential to reconfigure the layout and loft convert (subject to Planning Permission and Building Regulations)

Porch leads to the spacious hallway with open access into the bay fronted living room and the study area and a door to the kitchen and the dining/family room at the rear. Double doors open onto the garden with a patio, lawn, mature planting, shed storage and gated side access. On the first floor are 3 bedrooms, the family shower room and hatch access to loft storage.

Located within 0.2 miles of Crane Park with a walking/cycle track along the river to central Twickenham, 0.3 miles from the A316 with direct access to the M3/M25 and into central London and 0.9 miles from Whitton and Fulwell train stations.
EPC Rating D

- Semi Detached 3 Bedroom Home
- South Facing Garden with Side Access
- 1145 Sq Ft of Living Space over 2 Floors
- Potential to Reconfigure Layout and Loft Covert (stpp)
- 2 Living Areas and Separate Kitchen
- 0.2 Miles from Crane Park
- 0.8 Miles from Whitton Mainline Station





GROUND FLOOR
APPROX. FLOOR
AREA 666 SQ.FT.
(61.8 SQ.M.)

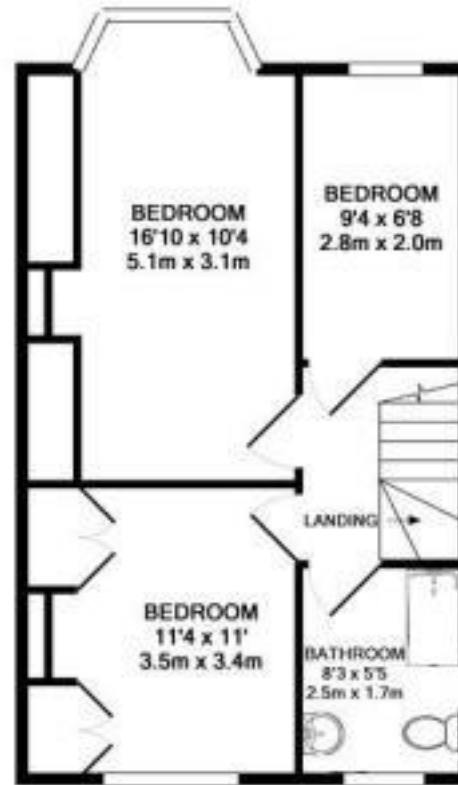

1ST FLOOR
APPROX. FLOOR
AREA 479 SQ.FT.
(44.5 SQ.M.)

TOTAL APPROX. FLOOR AREA 1145 SQ.FT. (106.4 SQ.M.)



a Websters Estate Agents 36 Broad Street, Teddington, Middlesex TW11 8QY **t** 020 8614 6000 **e** sales@mywebsters.co.uk **w** mywebsters.co.uk

Disclaimer

These particulars, whilst believed to be accurate are set out as a general outline only for guidance and do not constitute any part of an offer or contract. Intending purchasers should not rely on them as statements of representation of fact, but must satisfy themselves by inspection or otherwise as to their accuracy. We have not carried out a detailed survey nor tested the services, appliances and specific fittings. Room sizes should not be relied upon for carpets and furnishings. The measurements given are approximate. No person in this firm's employment has the authority to make or give any representation or warranty in respect of the property.

