



34

34

32

32

30

Websters
estate agents

Norcutt Road, Twickenham, TW2 6SR

Mid Terrace 3 bedroom Victorian family home in a popular and quiet cul-de-sac location. Situated just 0.3 miles from Twickenham Green, local shops, cafes and restaurants and only 0.8 miles from Strawberry Hill and Twickenham mainline train station.

Extended at the rear, loft converted and tastefully presented to offer 936 sq ft of well proportioned living space over 3 floors with high specification fixtures, fittings and floorings, double glazed windows with plantation shutters, built in storage and tasteful neutral decor throughout.

Front door opens into the living room with space for seating and dining and access to the stylish fitted kitchen at the rear. Double doors open onto the low maintenance courtyard garden with secure gated rear access. On the first floor are 2 bedrooms the front with recently fitted Sharp's wardrobes, the family bathroom, a large storage cupboard and stairs up to the main bedroom with a shower room, eaves storage and a Juliet balcony overlooking the garden.

Located 0.3 miles from Archdeacon and TPA, 0.6 miles from Trafalgar Primary and St Richard Reynolds School and within 0.7 miles of Twickenham town centre, Church Street and Twickenham Riverside with a towpath walk along the Thames past Marble Hill Park to Richmond.

EPC Rating C

- Mid Terrace Victorian Home
- 3 Double Bedrooms and 2 Bathrooms
- Extended and Loft Converted
- 936 Sq Ft of Living Space over 3 Floors
- Low Maintenance Garden with Rear Access
- 0.3 Miles from Twickenham Green
- Within 0.8 Miles of Twickenham Station and Schools



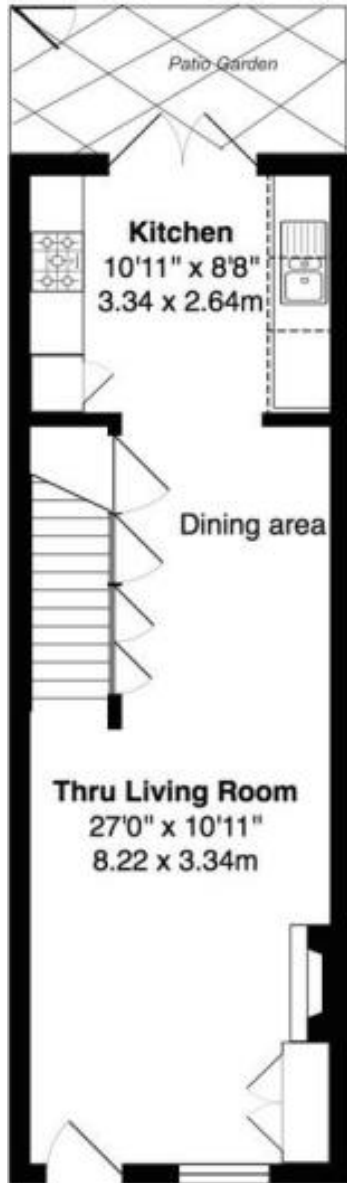

GROUND FLOOR

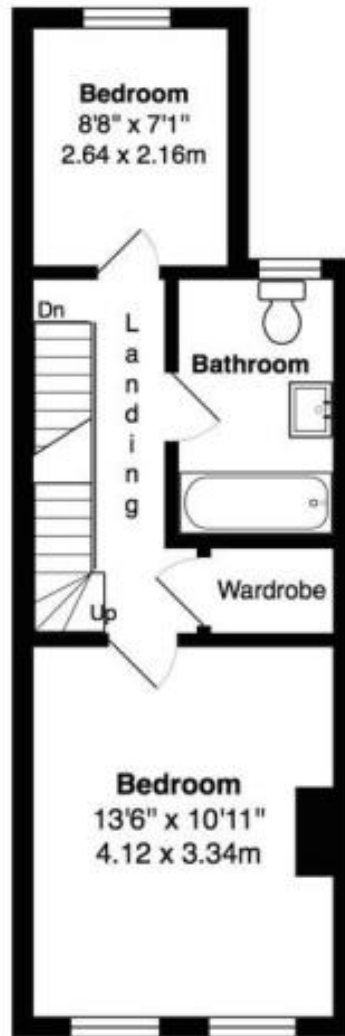

FIRST FLOOR

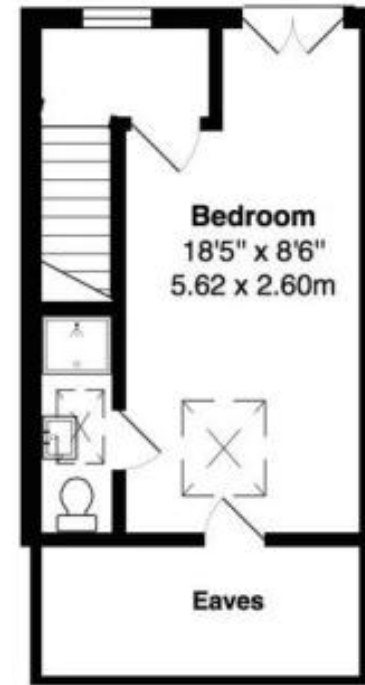

SECOND FLOOR

TOTAL FLOOR AREA approx.= 936 Sq.Feet (87 sq.metres)

a Websters Estate Agents 164 Heath Road, Twickenham, Middlesex TW1 4BN t 020 8892 3343 e sales@mywebsters.co.uk w mywebsters.co.uk

Disclaimer

These particulars, whilst believed to be accurate are set out as a general outline only for guidance and do not constitute any part of an offer or contract. Intending purchasers should not rely on them as statements of representation of fact, but must satisfy themselves by inspection or otherwise as to their accuracy. We have not carried out a detailed survey nor tested the services, appliances and specific fittings. Room sizes should not be relied upon for carpets and furnishings. The measurements given are approximate. No person in this firm's employment has the authority to make or give any representation or warranty in respect of the property.

