



CROWN PLACE, 19 SUN STREET EC2A

£850 per week (£3,683.33 pcm)

FEATURES

- A furnished one bedroom apartment on 8th floor (with lift)
- Oak herringbone flooring and comfort cooling
- 8th Floor with a lift
- Communal co-working space and 7th floor roof terrace
- Exceptional location close to world class amenities
- Landmark new development with 24 hour concierge
- Extending to 690 Sq ft (64 Sq m) with a South-east aspect
- State-of-the-art fitness centre
- Private screening room



Maskells

SUN STREET, EC2A
 Approximate Floor Area = 64.1 sq m / 690 sq ft



Energy Efficiency Rating		Current	Potential
<i>Very energy efficient - lower running costs</i>			
(92 plus) A		86	86
(81-91) B			
(69-80) C			
(55-68) D			
(39-54) E			
(21-38) F			
(1-20) G			
<i>Not energy efficient - higher running costs</i>			
England & Wales	EU Directive 2002/91/EC		

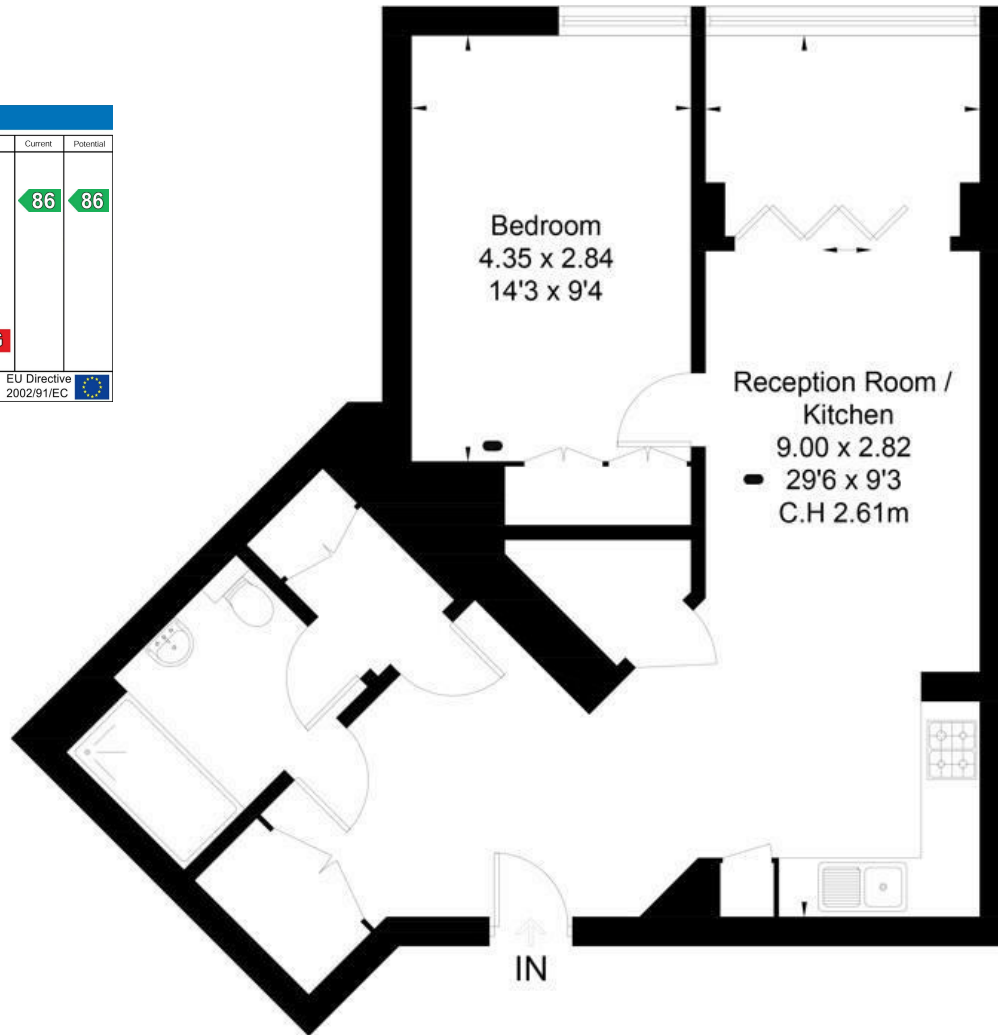

Eighth Floor

Call us on

0207 581 2216

lettings@maskells.com

www.maskells.com

Council Tax Band: E

A fabulous 1 bedroom apartment situated on 8th floor (with lift) of this landmark new development. The apartment has uninterrupted views South-easterly views over the city and extends to 690 Sq ft (64 Sq m) with excellent storage (perfect for a clothes horse), Oak herringbone flooring and comfort cooling.

The development benefits from world class amenities, with a 24 hours concierge, state-of-the-art fitness centre, private screening room, co-working space and 7th floor roof terrace to name but a few of the advantages.

One Crown Place is exceptionally well located, with fabulous entertainment and restaurant facilities on your doorstep, as well as good transport links, both rail and underground, connecting you to all parts of the city and all major airports.

Agents Note: Whilst every care has been taken to prepare these particulars, they are for guidance purposes only. All measurements are approximate and are for general guidance purposes only and whilst every care has been taken to ensure their accuracy, they should not be relied upon and potential buyers are advised to recheck the measurements.



This floor plan has been drawn in accordance with RICS Property Measurement 2nd edition. All measurements, including the floor area, are approximate and for illustrative purposes only @djd.london #62722

