



Britten Street
Chelsea SW3

Maskells

Positioned on the 1st floor of a popular and ideally located purpose – built block, this is a very well formed 1 bedroom flat with lovely views over the gardens adjacent to St Luke’s Church.



Accommodation and Amenities

- EXCELLENT LOCATION
- LONG LEASE
- LIFT
- CARETAKER
- CHARMING OUTLOOK



View from Reception Room

Britten Street is positioned to the north of the Kings Road and is within easy reach of Chelsea Green and all the world – class shops, bars and restaurants that the immediate area has to offer. South Kensington station (District, Circle and Piccadilly lines) is 0.5 miles away and Sloane Square station (District and Circle lines) is 0.7 miles away.



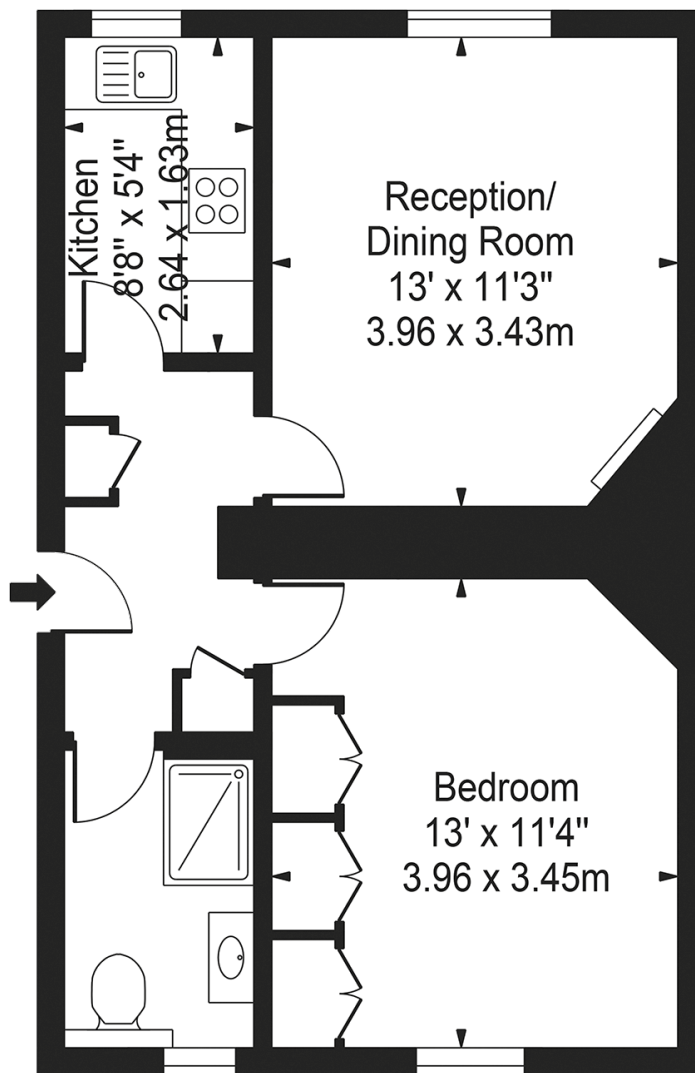

First Floor

APPROXIMATE FLOOR AREA

44.22 sq m / 476 sq ft



TERMS

Asking Price £650,000

Tenure Leasehold, expires 23 March 2118

Service Charge Approx £5,900 Per annum

Ground Rent Peppercorn

EPC C

Council Tax Band D

Local Authority The Royal Borough of Kensington and Chelsea

Let's talk Mortgages

Maskells has partnered with Private Finance, an independent mortgage broker, directly authorised with specialist knowledge and whole of market access.

CLICK HERE

Privatefinance@maskells.com

Your home may be repossessed if you do not keep up repayments on your mortgage



@maskellsea

Maskells

71 Walton Street, London SW3 2HT

Tel: 0207 581 2216

sales@maskells.com

lettings@maskells.com

maskells.com

