



SOUTHWELL GARDENS SOUTH KENSINGTON SW7

£576 per week (£2,496 pcm)

FEATURES

- Large elegant 1 bedroom apartment
- High ceilings and an abundance of natural light
- Prime location on a quiet street close to all amenities
- 0.4 miles to Hyde Park
- Situated within a grand Victorian villa
- Fully fitted kitchen with dishwasher and washer/dryer
- 0.3 miles to Gloucester Road
- 0.5 miles to South Kensington tube



Maskells

Call us on

0207 581 2216

lettings@maskells.com

www.maskells.com

Council Tax Band: F

A grand and elegant period one bedroom apartment, well proportioned with high ceilings and an abundance of natural light, situated on the 3rd floor of this imposing South Kensington Villa.

The flat is perfectly positioned on a prime quiet residential street just 3 minutes from Gloucester Road tube, 0.4 miles from Hyde Park and Kensington Palace and only 0.6 miles from Whole Foods Market and High Street Kensington. EPC C.

The accommodation comprises; entrance hall, large reception room, separate fully fitted kitchen, bathroom with shower over bath and large double bedroom.”

Agents Note: Whilst every care has been taken to prepare these particulars, they are for guidance purposes only. All measurements are approximate and are for general guidance purposes only and whilst every care has been taken to ensure their accuracy, they should not be relied upon and potential buyers are advised to recheck the measurements.

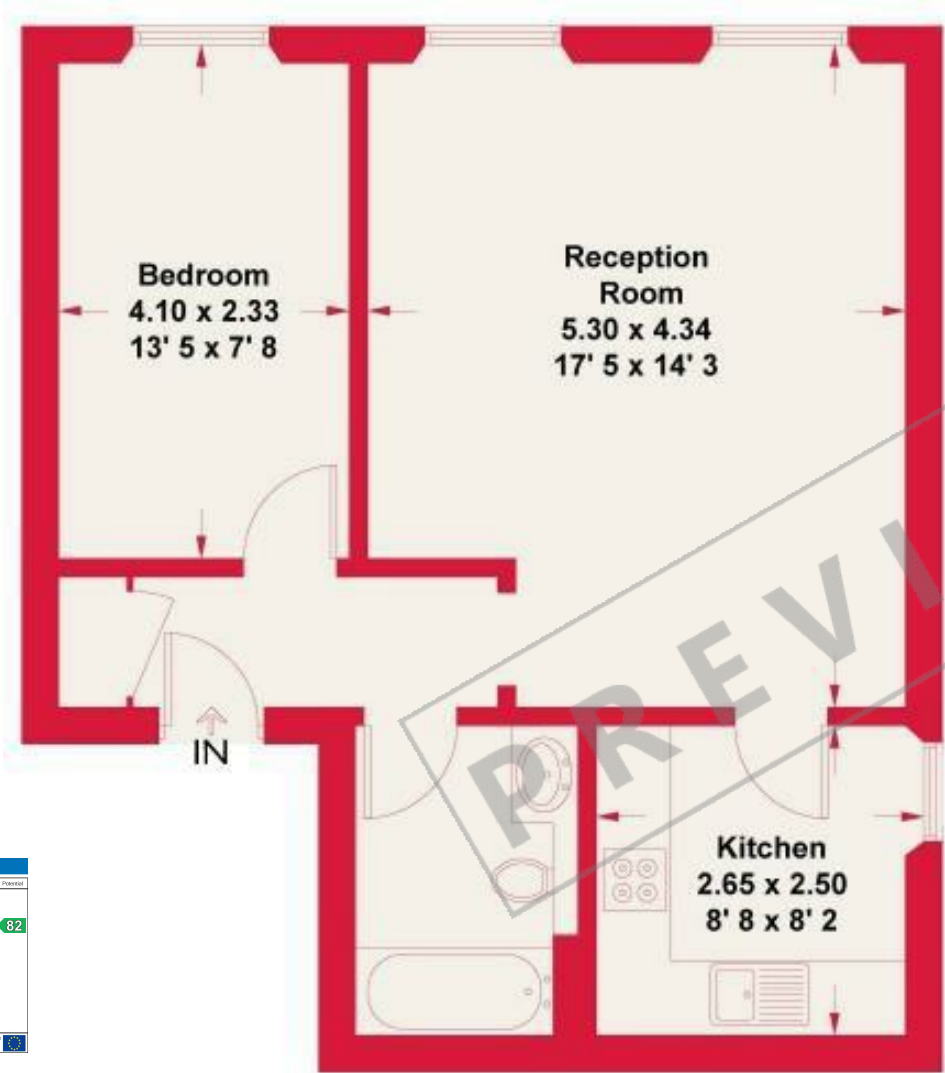

Third Floor

Energy Efficiency Rating	
Current	Potential
Very energy efficient - lower running costs	
A (92-100)	82
B (81-91)	
C (69-80)	72
D (55-68)	
E (49-54)	
F (41-48)	
G (1-40)	
Not energy efficient - higher running costs	
England & Wales	
EU Directive 2002/91/EC	

Southwell Gardens

Approximate Gross Internal Area = 519 sq ft / 48.2 sq m

Whilst every attempt has been made to ensure the accuracy of the floor plan contained here, measurements of doors, windows and rooms are approximate and no responsibility is taken for any error, omission or misstatement. These plans are for representation purposes only as defined by RICS Code of Measuring Practice and should be used as such by any prospective purchaser. Specifically no guarantee is given on the gross internal floor area of the property if quoted on this plan and any figure given is initial guidance only and should not be relied on as a basis of valuation.

