



Ivor Court

Gloucester Place, NW1

£2,750 per month
(£634.62 per week)

A sixth floor apartment in a prestigious portered building with heating and hot water included, within walking distance to LBS and both Baker Street and Marylebone tube stations.

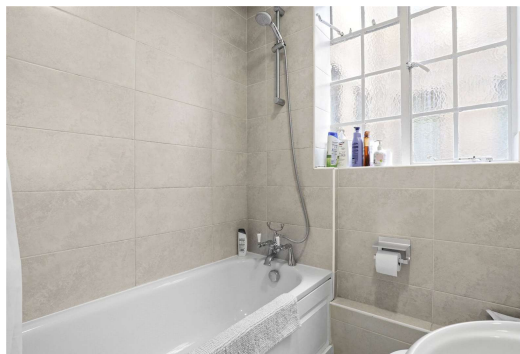

Ivor Court

Gloucester Place, NW1

- Spacious Apartment
- 2 Bedrooms, 1 Bathroom
- Porter, Lift, Close to LBS
- Close to Baker Street Station



A sixth floor apartment in a prestigious portered building within walking distance to LBS and both Baker Street and Marylebone tube stations.

The property comprises a large living room, two bedrooms, fitted kitchen and bathroom with full sized bath and shower over.

Additional benefits include ample storage, lift to all floors and portorage.

Minimum Term: 6 months
Deposit Required: £3,173.08
Local Authority: City of Westminster
Council Tax Band: D
EPC Rating: C
Furnished

Energy Efficiency Rating		
	Current	Potential
Very energy efficient - lower running costs		
A (92-100)		
B (81-91)		
C (69-80)	71	81
D (55-68)		
E (39-54)		
F (21-38)		
G (1-20)		
Not energy efficient - higher running costs		
England, Scotland & Wales EU Directive 2002/91/EC		

Chestertons St John's Wood Lettings

105 St. John's Wood Terrace
 London
 NW8 6PL
 stjohswood@chestertons.co.uk
 02030408622
 chestertons.co.uk

Additional tenant charges apply (fees apply to non-AST tenancies only)
 Tenancy Agreement Fee: £300
 References per Tenant/Guarantor: £60
 Inventory check (approx. £100 – £250 inc. VAT)
 chestertons.co.uk/property-to-rent/applicable-fees

Ivor Court Gloucester Place, NW1 6BS

Approx. Gross Internal Area = 62 sq m / 663 sq ft

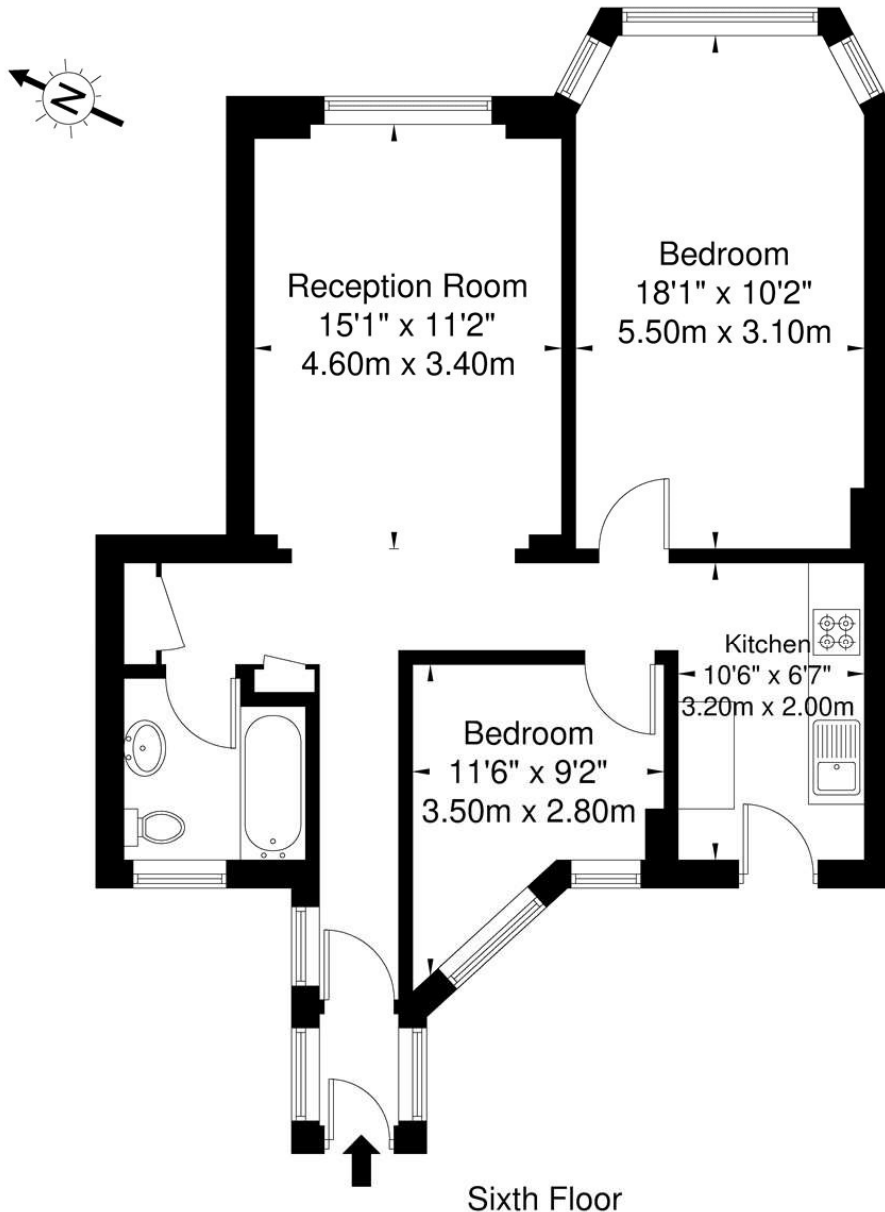

Ref

Copyright

**BLEU
PLAN**

The Floor plan is not to scale and measurements and areas shown are approximate and therefore should be used for illustrative purposes only. The plan has been prepared in accordance with the RICS code of Measuring Practice and whilst we have confidence in the information produced it must not be relied on. If there is any aspect of particular importance, you should carry out or commission your own inspection of the property.

Copyright @ BLEUPLAN

