



# Lords View

St. Johns Wood Road, NW8

£350 per week  
(£1,516.67 pcm)

\*\*\*VIDEO VIEWING AVAILABLE\*\*\* A spacious apartment set in a portered building in the heart of St John's Wood. The property now benefits from a new wooden flooring throughout.



# Lords View

St. Johns Wood Road, NW8

- A Spacious Apartment
- 1 Bedroom, 1 Bathroom
- Porter
- Great Location for St John's Wood amenities and underground station



A spacious bedroom apartment in portered block opposite Lord's Cricket Ground. The property comprises of; spacious kitchen, large reception, bathroom, large bedroom with fitted wardrobes. The property now benefits from a new wooden flooring throughout.

**Tenure:** To be advised  
**Furnished, Part Furnished,**  
 ...

Additional tenant charges apply (fees apply to non-AST tenancies only)  
 Tenancy Agreement Fee: £300  
 References per Tenant/Guarantor: £60  
 Inventory check (approx. £100 – £250 inc. VAT)  
[chestertons.com/property-to-rent/applicable-fees](https://www.chestertons.com/property-to-rent/applicable-fees)

Energy Efficiency Rating		
	Current	Potential
Very energy efficient - lower running costs		
(92+) <b>A</b>		
(81-91) <b>B</b>		
(69-80) <b>C</b>	75	77
(55-68) <b>D</b>		
(39-54) <b>E</b>		
(21-38) <b>F</b>		
(1-20) <b>G</b>		
Not energy efficient - higher running costs		
England, Scotland & Wales		EU Directive 2002/91/EC

### Chestertons St John's Wood Lettings

122 St John's Wood High Street  
 St John's Wood  
 London  
 NW8 7SG  
[lettings.stjohnswood@chestertons.com](mailto:lettings.stjohnswood@chestertons.com)  
 02030408622  
[chestertons.com](https://www.chestertons.com)

## Lords View, NW8

Approximate Gross Internal Area

611 sq ft / 56.83 sq m

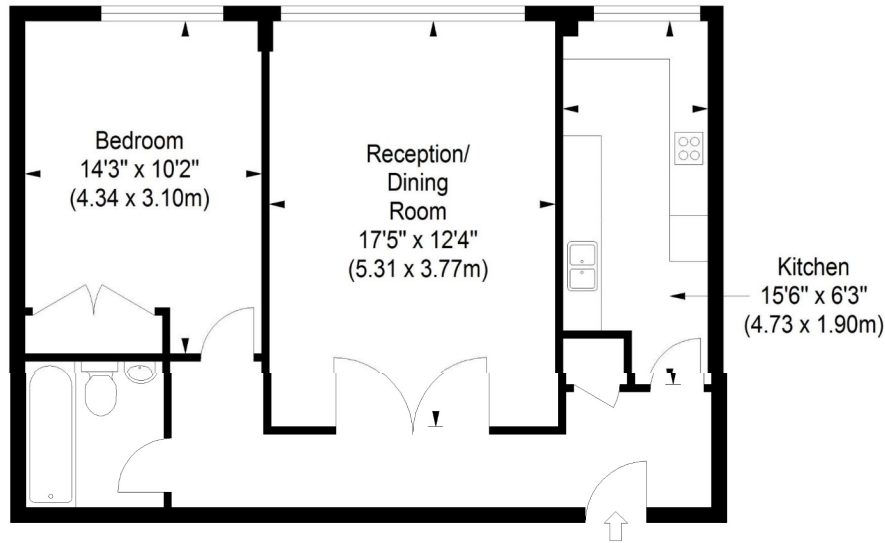

Second Floor

ILLUSTRATION FOR IDENTIFICATION PURPOSES ONLY

ALL MEASUREMENTS ARE MAXIMUM, AND INCLUDE WINDOW BAYS AND WARDROBES WHERE APPLICABLE  
THIS PLAN MUST NOT BE REPRODUCED BY ANY OTHER PERSON WITHOUT PERMISSION