



Dorset House

Gloucester Place, NW1

£4,766.67 per month
(£1,100 per week)

A spacious three bedroom property with balcony set on the 5th floor (with lift) of a portered Art-Deco block, moments from Baker Street Underground station and the amenities of Marylebone.



Dorset House

Gloucester Place, NW1

- Fifth Floor Flat
- 3 Bedrooms, 2 Bathrooms
- Lift, Concierge, Balcony
- Close to Marylebone station



A spacious three bedroom property with balcony set on the 5th floor (with lift) of a portered Art-Deco block, moments from Baker Street Underground station and the amenities of Marylebone.

The property comprises three double bedrooms, modern fully fitted kitchen, reception room with wood floors and balcony, bathroom, and guest WC.

Minimum Term: 6 months
Deposit Required: £5,500.00
Local Authority: Westminster
Council Tax Band: F
EPC Rating: C
Furnished

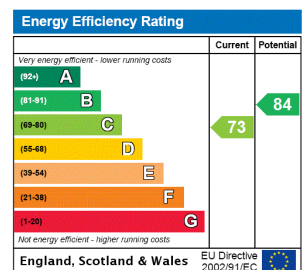

Chestertons St John's Wood Lettings

105 St. John's Wood Terrace
 London
 NW8 6PL
 stjohswood@chestertons.co.uk
 02030408622
 chestertons.co.uk

Additional tenant charges apply (fees apply to non-AST tenancies only)
 Tenancy Agreement Fee: £300
 References per Tenant/Guarantor: £60
 Inventory check (approx. £100 – £250 inc. VAT)
 chestertons.co.uk/property-to-rent/applicable-fees

Dorset House, NW1 5AE

Approx Gross Internal Area = 110.9 sq m / 1194 sq ft

Balconies = 17.2 sq m / 185 sq ft

Total = 128.2 sq m / 1380 sq ft

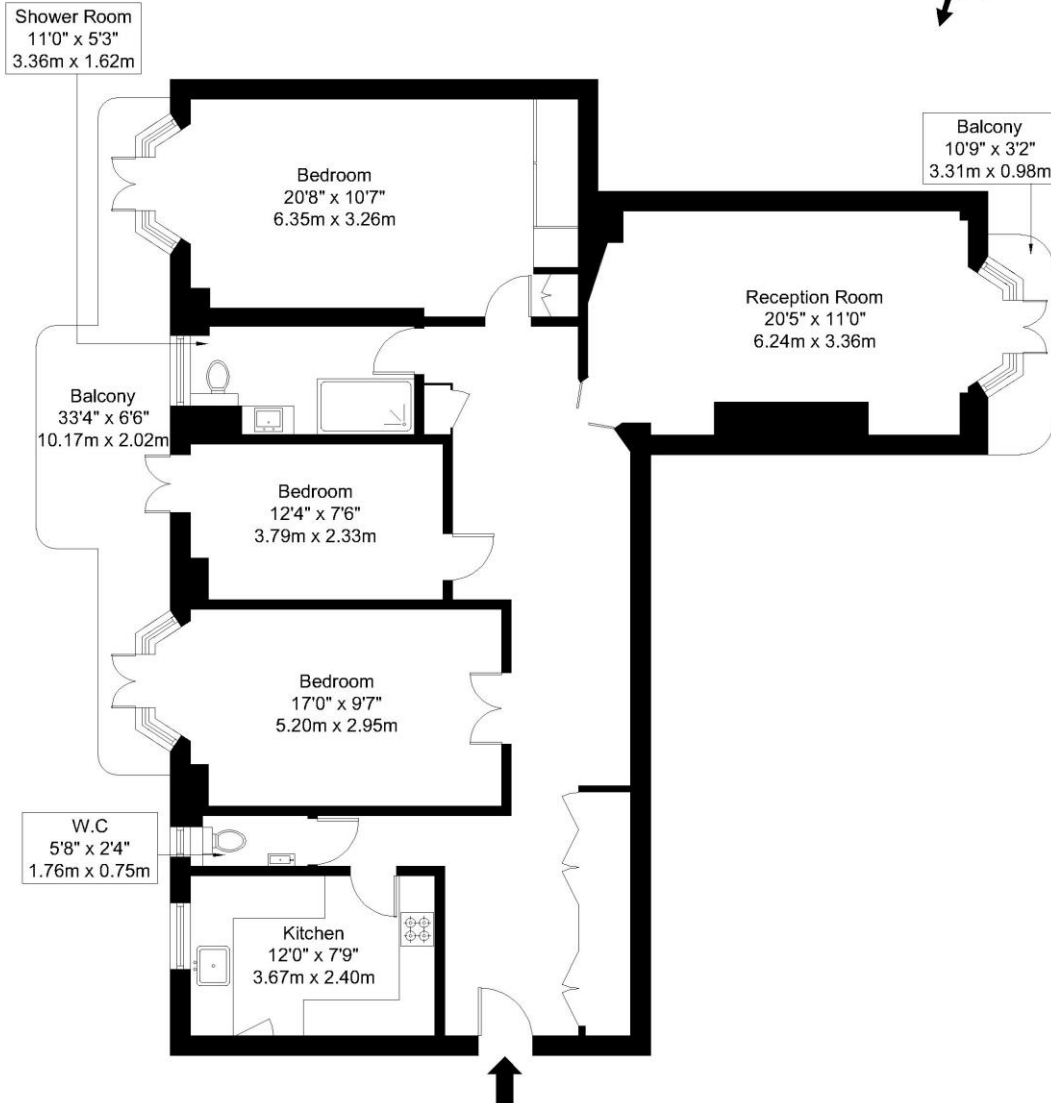

Fifth Floor

Ref:

Copyright **BLEU
PLAN**

The Floor plan is not to scale and measurements and areas shown are approximate and therefore should be used for illustrative purposes only. The plan has been prepared in accordance with the RICS code of Measuring Practice and whilst we have confidence in the information produced it must not be relied on. Maximum lengths and widths are represented on the floor plan. If there is any aspect of particular importance, you should carry out or commission your own inspection of the property.

Copyright @ BLEUPLAN

