



## Bell Street

Marylebone, NW1

£2,000 per month  
(£461.54 per week)

A bright and modern one bedroom flat with private patio garden. The property is a short walk away from Marylebone Station, Baker Street Underground Station and Marylebone High Street.



# Bell Street

Marylebone, NW1

- A bright, modern 1 Bedroom Garden Apartment
- 1 Bedroom with Fitted Wardrobes, Modern Bathroom, Kitchen
- Reception Room with French Doors leading to private Patio Garden
- Wood Floors Throughout
- Moments from Marylebone Station & Baker Street Underground Station & Marylebone High Street





A bright and modern one bed apartment with its own entrance and private west facing garden.

The property, which has wood floors throughout, comprises; kitchen, double bedroom, modern bathroom and reception with doors leading on to private patio garden. Additionally there is a laundry room separately with a washing machine for private use of the apartment.

The property is a short walk away from Marylebone Station, and around the corner from Baker Street Underground Station and

**Minimum Term:** 6 months  
**Deposit Required:** £2,307.69  
**Local Authority:** City Of Westminster  
**Council Tax Band:** B  
**EPC Rating:** D  
**Furnished**

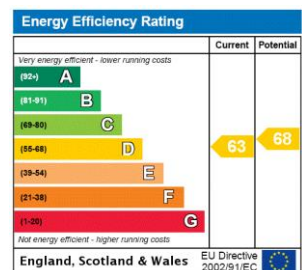

### *Chestertons St John's Wood Lettings*

105 St. John's Wood Terrace  
 London  
 NW8 6PL  
 stjohswood@chestertons.co.uk  
 02030408622  
 chestertons.co.uk

Additional tenant charges apply (fees apply to non-AST tenancies only)  
 Tenancy Agreement Fee: £300  
 References per Tenant/Guarantor: £60  
 Inventory check (approx. £100 – £250 inc. VAT)  
 chestertons.co.uk/property-to-rent/applicable-fees

# Bell Street, NW1 6TL

Approx Gross Internal Area = 27.91 sq m / 300 sq ft

Garden = 15.38 sq m / 165 sq ft

Total = 43.29 sq m / 465 sq ft

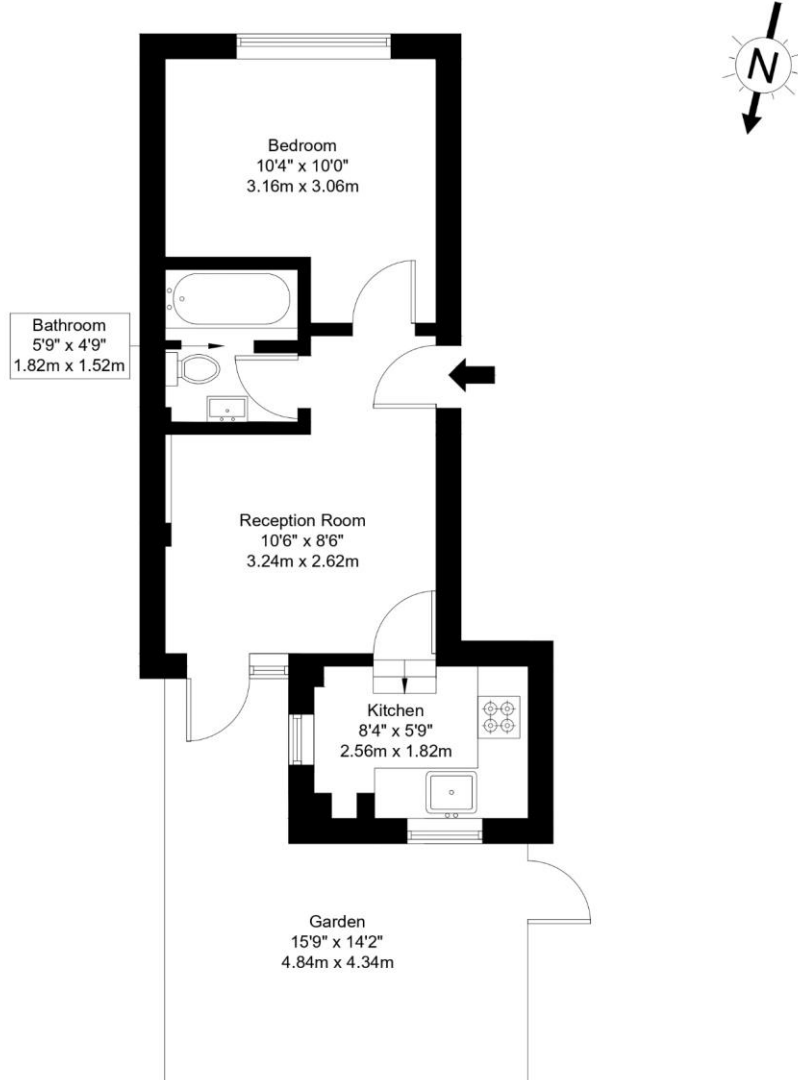

Lower Ground Floor

Ref :

Copyright

**BLEU  
PLAN**

The Floor plan is not to scale and measurements and areas shown are approximate and therefore should be used for illustrative purposes only. The plan has been prepared in accordance with the RICS code of Measuring Practice and whilst we have confidence in the information produced it must not be relied on. If there is any aspect of particular importance, you should carry out or commission your own inspection of the property.

Copyright @ BLEUPLAN

