



# Wellington Court

55-67 Wellington Road, NW8

£3,336.67 per month  
(£770.00 per week)

A spacious property in a prestigious portered block, in an enviable location. Situated a stones throw from St John's Wood tube station.

CHESTERTONS



# Wellington Court

55-67 Wellington Road, NW8

- A Spacious Apartment in Portered Block
- 2 Bedrooms, 1 Bathroom
- Porter
- Excellent Location





A spacious and well presented property in a prestigious portered block, in an enviable location.

Situated a stones throw from St John's Wood tube station, the apartment benefits from two double bedrooms, family bathrooms, guest WC, large reception room and fitted kitchen.

**Minimum Term:** 6 months  
**Deposit Required:** £3,850.00  
**Local Authority:** City of Westminster  
**Council Tax Band:** F  
**EPC Rating:** D  
**Furnished, Part Furnished**

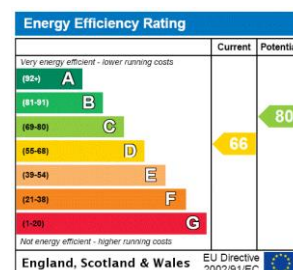

### *Chestertons St John's Wood Lettings*

105 St. Johns Wood Terrace  
 London  
 NW8 6PL  
[stjohnswood@chestertons.co.uk](mailto:stjohnswood@chestertons.co.uk)  
 02030408622  
[chestertons.co.uk](http://chestertons.co.uk)

Additional tenant charges apply (fees apply to non-AST tenancies only)  
 Tenancy Agreement Fee: £300  
 References per Tenant/Guarantor: £60  
 Inventory check (approx. £100 – £250 inc. VAT)  
[chestertons.co.uk/property-to-rent/applicable-fees](http://chestertons.co.uk/property-to-rent/applicable-fees)

# Wellington Court, Wellington Road, NW8 9TD

Approx. Gross Internal Area = 83.8 sq m / 902 sq ft

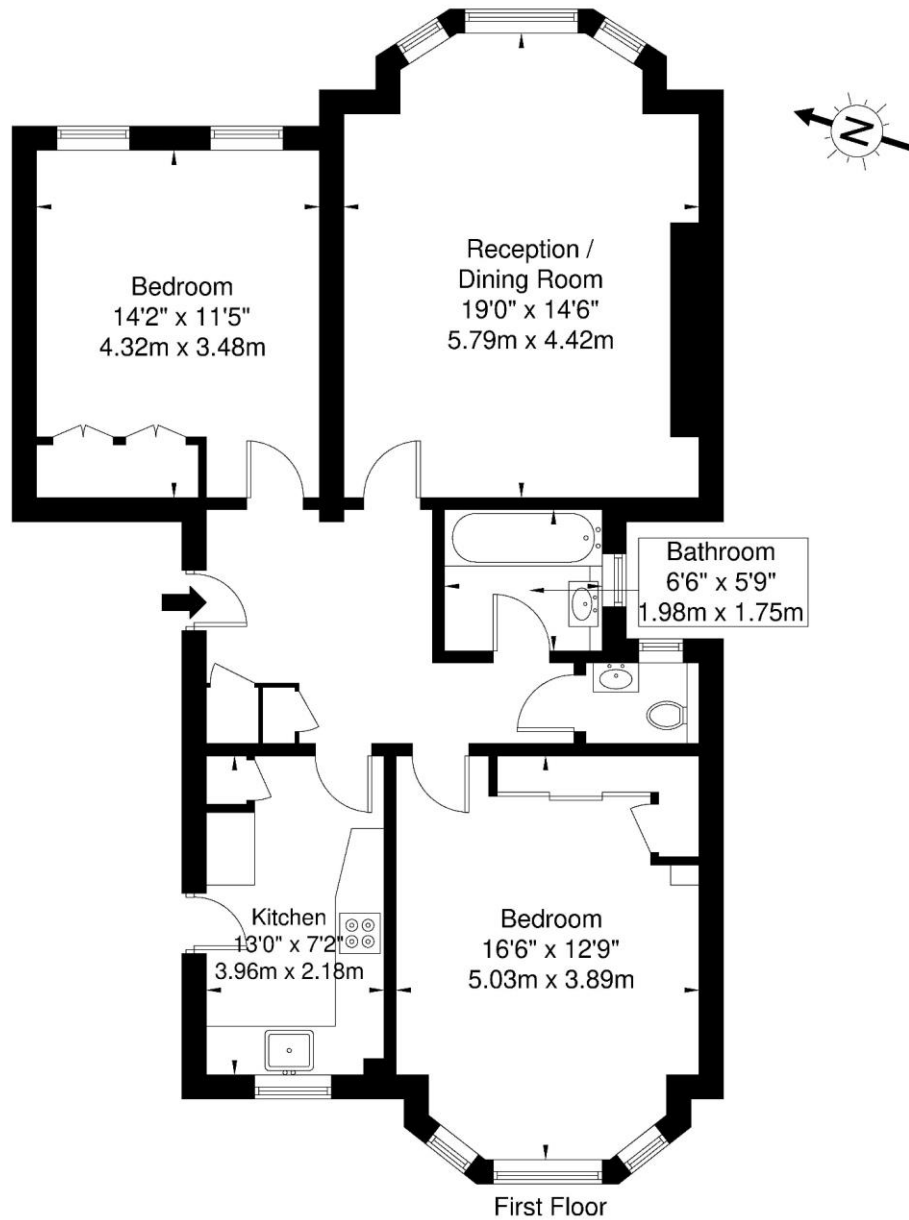

Ref

Copyright

**BLEU  
PLAN**

The Floor plan is not to scale and measurements and areas shown are approximate and therefore should be used for illustrative purposes only. The plan has been prepared in accordance with the RICS code of Measuring Practice and whilst we have confidence in the information produced it must not be relied on. If there is any aspect of particular importance, you should carry out or commission your own inspection of the property.

Copyright @ BLEUPLAN

